

MAICO

1982

SPARE PARTS CATALOGUE

Model: ALPHA 1 ALPHA E

Chassis Type:

MC 250 - 353	Engine - 353
MC 490 - 354	Engine - 354
GS 250 - 353	Engine - 253
GS 490 - 354	Engine - 254

Chassis Description

Alpha Control with single shock suspension - Corte & Cosso shock with 325mm (12.8") rear wheel travel. Shock length 474mm (18.66") rebuildable with adjustable rebound dampening square swingarm with rising rate rocker arm - fully floating brake system - new air box - side number panels.
Alpha E - with Bosch ignition and wide ratio transmission.

Engine Description

New engine comes with extra support for the rocker arm unit. New cylinder with pressed in inlet manifold. New exhaust pipe - Alpha E models same as the motocross model frame with adaptable Enduro kit.

Frame Identification

Stamped on the steering head.

353 0000	-	250
354 0000	-	490

Engine Identification

Stamped on the engine case.

250 Alpha 1	353 0000
490 Alpha 1	354 0000
250 Alpha E	253 0000
490 Alpha E	254 0000

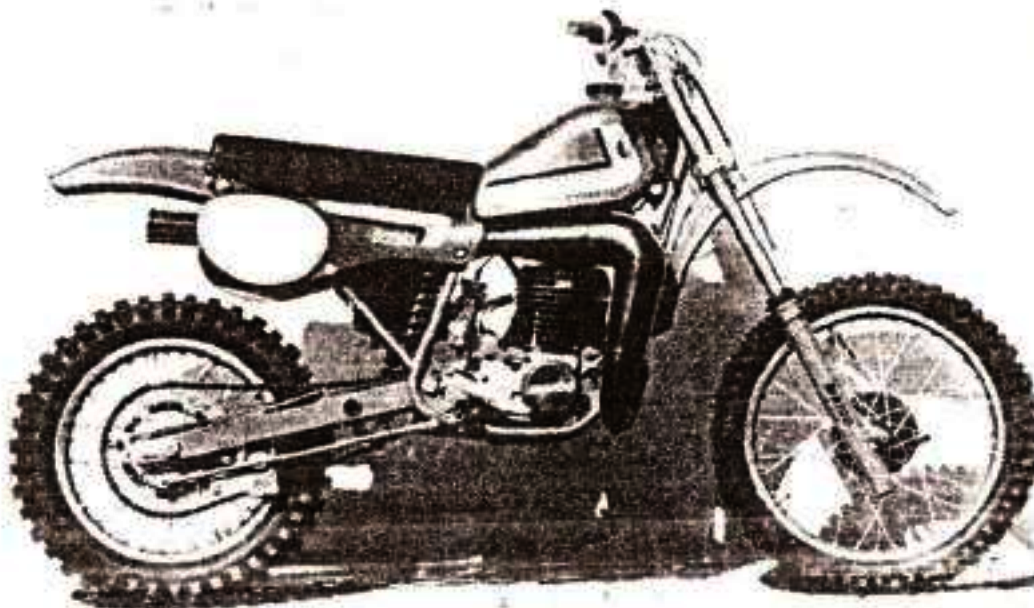

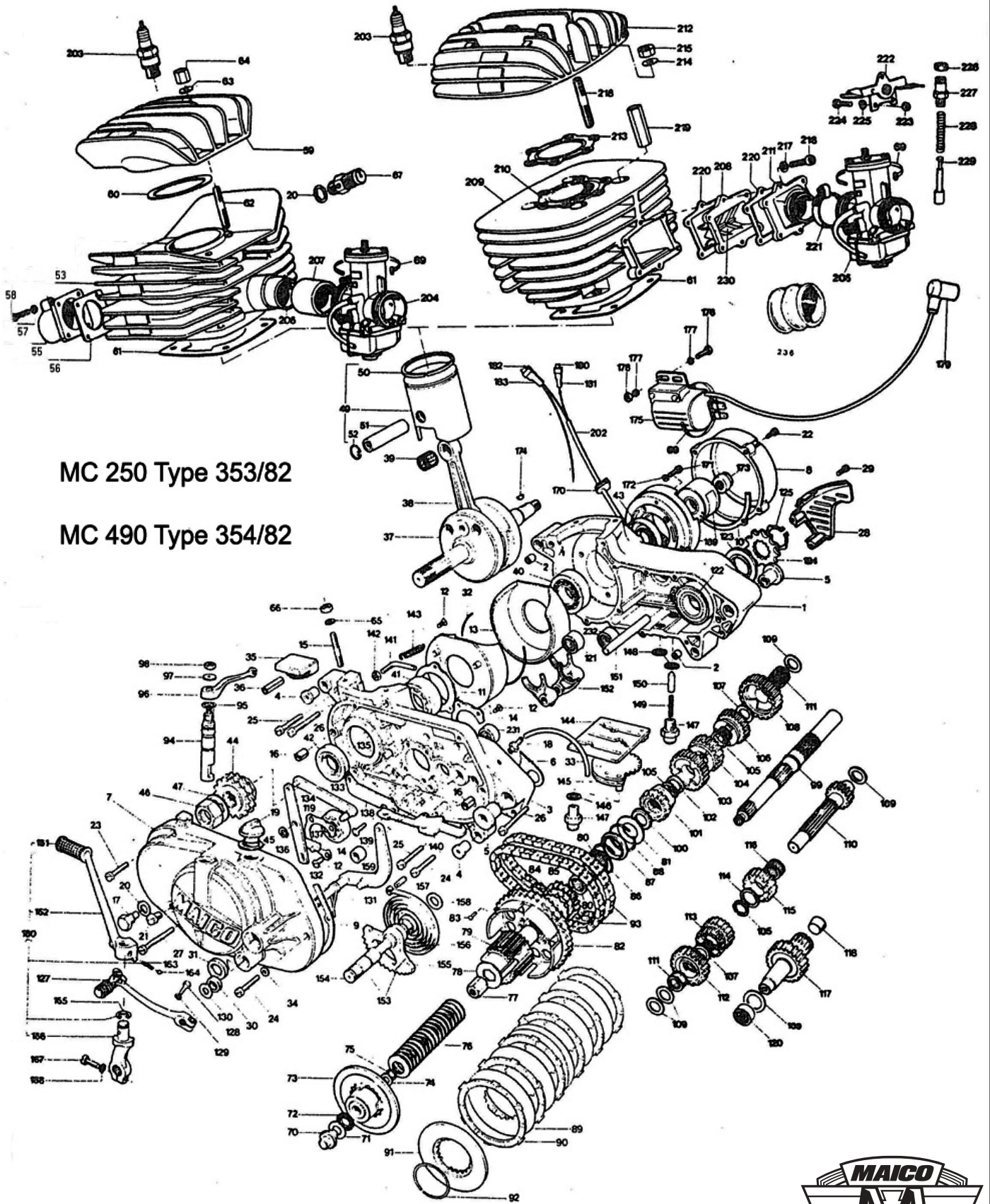

MC 250 Type 353/82

MC 490 Type 354/82



Pict. No.	Comp. No.	Description	MC 250 353	MC 490 354
168	1704	Spring ring 5 6	1	1
169	3598	Ignition cpl. Motoplat	1	1
170	3530	Rubber sleeve	1	1
171	1630	Inner hexagon screw M 5 x 16 DIN 912	3	3
172	1731	Washer B 5,3 DIN 125	3	3
173	1123	Nut for generator	1	1
174	1881	Woodruff key, 3 x 3,7 DIN 6868	1	1
175	3600	Ignition coil Motoplat	1	1
176	1567	Hexagon screw M 6 x 16 DIN 933	2	2
177	1732	Washer B 6,4 DIN 125	4	4
178	1690	Securing nut NM 6 DIN 980	2	2
179	3610	Cable plug	1	1
180	3576	Connector 6,3-1 DIN 46247	1	1
181	3596	Connector housing 6,3	1	1
182	3595	Connector 9,5-6 DIN 46247	1	1
183	3597	Connector 9,5	1	1
202	2607	Wirehousing B ϕ 3 x 0,4 DIN 40621	x	x
203	603	Spark plug Champion N 2	1	1
204	6904	Carburetor cpl. Bing V54/40/106/II	-	1
205	6905	Carburetor cpl. Bing V54/38/111/II	-	1
206	7465	Intake flange 490	-	1
207	5342	Bush	-	1
208	6796	Reed valve 250 cpl.	1	-
209	6788	Cylinder 250 cpl.	1	-
210	6789	Cylinder bush ϕ 67	1	-
211	7470	Intake flange 250	1	-
212	6791	Cylinder head 250	1	-
213	6792	Cylinder head gasket	1	-
214	1734	Washer B 8,4 DIN 125	6	-
215	1670	Hexagon screw M 8 DIN 934	10	-
216	1635	Inner hexagon screw M 6 x 25 DIN 912	6	-
217	1510	Spring ring B 6 DIN 128	6	-
218	2967	Cylinder head stud	6	-
219	6787	Nut	2	-
220	6810	Intake gasket	2	-
221	683	Clamp	1	-
222	6912	Choke lever	1	-
223	6914	Nut	2	-
224	6913	Screw	2	-
225	1509	Spring ring	2	-
226	6911	Rubber cap	1	-
227	6910	Choke housing	1	-
228	6909	Spring	1	-
229	6908	Choke piston	1	-
230	6798	Reed valve lips	2	-
231	5596	Needle bearing RNA 4901 DIN 617	1	1
232	5598	Outer ring withring of pins	1	1

x = yard goods



Int. Comp. No.	Comp. No.	Description	MC 250 353	MC 450 354	Part. No.	Comp. No.	Description	MC 250 353	MC 450 354
1	7400	Frame, cpl.	1	1	62	6271	Front decal, yellow	-	1
2	7413	Rear swing arm	1	1	63	6247	Cable guide, cpa.	-	1
3	7402	Swivel cage III 2000	2	2	64	6246	Spring nut	-	2
4	7470	O-Ring	2	2	65	7041	Sliding roller	-	2
5	7411	Swing arm bush	2	2	66	6255	Plastic screw M 6 x 30	-	2
6	7460	Guide plate	1	1	67	7733	Plastic screw M 6 x 22	-	1
7	7772	Washer D 6,4 DIN 125	35	35	68	6294	Set adjustment bolts, complete w/ position 2 x 35, 2 x 30, 2 x 2	-	35
8	7460	Hexagon screw M 6 x 40 DIN 913	2	2	69	1630	Hexagon screw M 6 x 120 DIN 913	-	2
9	7460	Securing nut M 6 x 120 DIN 913	14	14	70	1700	Securing nut M 6 x 40 DIN 913	-	14
10	7555	Chain guide	1	1	71	502	Rubber saddle clip	-	1
11	7557	Spacer tube for chain guide	1	1	72	6545	Rubber plug	-	1
12	7559	Bush	2	2	73	1587	Hexagon screw M 6 x 16 DIN 913	-	2
13	7556	Bush for roller	2	2	74	400	Tool	-	2
14	756	Tension spring	1	1	75	7446	Side panel, left	-	1
15	7558	Spacer for chain guide	2	2	76	4153	Green decal	-	2
16	7414	Screw M 6 x 16 DIN 913	2	2	77	4112	Yellow decal	-	2
17	7460	Securing nut M 6 x 120 DIN 913	2	2	78	7447	Decal, left	-	2
18	7413	Screw M 6 x 16 DIN 913	2	2	79	7448	Decal, right	-	2
19	7705	Spring ring D 6 DIN 127	2	2	80	7450	Side panel, right	-	2
20	7724	Washer D 6,4 DIN 125	14	14	81	108	Sticker 250	-	14
21	7460	Hexagon screw M 6 x 40 DIN 913	5	5	82	475	Sticker 450	-	5
22	7460	Hexagon screw M 6 x 45 DIN 913	2	2	83	5090	Swivel head screw M 6 x 16 DIN 913	-	2
23	7460	Securing nut M 6 x 120 DIN 913	6	6	84	5105	Rubber washer	-	6
24	7460	Securing nut M 6 x 120 DIN 913	1	1	85	7405	Exhaust system cpl.	-	1
25	7460	Securing nut M 6 x 120 DIN 913	1	1	86	7406	Exhaust system cpl.	-	1
26	7460	Securing nut M 6 x 120 DIN 913	1	1	87	7407	Exhaust system cpl.	-	1
27	7460	Securing nut M 6 x 120 DIN 913	1	1	88	7408	Exhaust system cpl.	-	1
28	7460	Securing nut M 6 x 120 DIN 913	1	1	89	7409	Exhaust system cpl.	-	1
29	7460	Securing nut M 6 x 120 DIN 913	1	1	90	7410	Exhaust system cpl.	-	1
30	7460	Securing nut M 6 x 120 DIN 913	1	1	91	7411	Exhaust system cpl.	-	1
31	7527	Brace star, cpl.	1	1	111	6883	Silencer	1	1
32	7460	Hexagon nut M 6 DIN 913	1	1	-	7874	Silencer	-	1
33	7460	Screw M 6 x 20 DIN 913	1	1	112	6884	Exhaust packing	1	1
34	7460	Wash	1	1	-	6885	Exhaust packing	-	1
35	7460	Rear brake rod	1	1	113	1884	Securing ring 30 x 2,5 DIN 472	1	1
36	7460	Rear arm spindle	1	1	114	6882	Silencer end cap	1	1
37	7460	Adjusting nut	1	1	115	5474	Clamp 2 35/15	1	1
38	7460	Wash. 1884	1	1	116	1591	Hexagon screw M 6 x 25 DIN 913	1	1
39	7460	Cylinderschraube M 4 x 50 DIN 913	4	4	117	5445	Rubber washer	2	2
40	7460	Washer D 6,4 DIN 913	4	4	118	5446	Bush for silencer mount	2	2
41	7460	Tank with decal	1	1	119	1587	Hexagon screw M 6 x 16 DIN 913	5	5
42	7460	Tank decal left	1	1	120	5430	Washer	5	5
43	7460	Tank decal right	1	1	121	1566	Silencer	2	2
44	7460	Tank cap, cpl.	1	1	122	836	Asbestos band	1	1
45	7460	Sealing ring	1	1	123	6776	Guide bush	1	1
46	7460	Foot cock	1	1	124	6275	Spring	1	1
47	7460	O-ring	2	2	125	1523	Inner hexagon screw M 6 x 20 DIN 913	1	1
48	7460	Hexagon screw M 6 x 14 DIN 913	4	4	126	1884	Tension spring	2	2
49	7460	Rubber stop	4	4	127	7423	Nuts tank, cpl.	1	1
50	7460	Sliding plate for tank	1	1	128	7424	Bush	2	2
51	7460	Spring ring 3 x 20 DIN 127	2	2	129	1975	Grasshopper M 6 x 3,5 DIN 3402	3	3
52	7460	Clamp	1	1	130	7425	Wash lever, cpl.	1	1
53	7460	Washer D 6,4 DIN 913	1	1	131	7426	Bush	4	4
54	7460	Seat, cpl., low	1	1	132	7427	Wash bearing	1	1
55	7460	Seat, cpl., high	1	1	133	7428	Spacer bush	1	1
56	7460	Seat base	1	1	134	7429	Clip	2	2
57	7460	Seat cover, low	1	1	135	1511	Inner hexagon nut M 6 x 75 DIN 913	1	1
58	7460	Seat cover, high	1	1	136	7430	Screw	1	1
59	7460	Seat cover, low	1	1	137	7431	Bush	1	1
60	7460	Seat cover, high	1	1	138	7432	Wing bolt	1	1
61	7460	Seat bracket	1	1	139	7445	Bolt	1	1
62	7460	Clamp	1	1	140	7446	Imagery bolt	2	2
63	7460	Rubber band	1	1	141	7447	Washer	1	1
64	7460	Foot rest, left, cpl.	1	1	142	1527	Washer D 13 DIN 125	6	6
65	7460	Foot rest, right, cpl.	1	1	143	7448	Washer	2	2
66	7460	Bush	2	2	144	7449	Washer	1	1
67	7460	Hexagon screw M 6 x 55 DIN 913	2	2	145	7450	Washer	5	5
68	7460	Spacer bush	2	2	146	7451	Securing nut M 6 x 1 DIN 913	6	6
69	7460	Foot rest spring, left	1	1	147	7452	Securing ring	1	1
70	7460	Foot rest spring, right	1	1	148	7453	Insulator, cpl.	1	1
71	7460	Cylinder head stay, left	1	1	149	7454	Rubber support	2	2
72	7460	Cylinder head stay, right	1	1	150	85	Clamp	2	2
73	7460	Cylinder head stay, left	1	1	151	1521	Securing nut M 6 x 1,5 DIN 913	4	4
74	7460	Cylinder head stay, right	1	1	152	1522	Spring ring D 4 DIN 127	1	1
75	7460	Hexagon nut M 6, 14mm	2	2	153	6883	Hexagon nut M 4 DIN 913	1	1
76	7460	Spring ring M 6 DIN 127	2	2	154	282	Clamp	1	1
77	7460	Hexagon screw M 6 x 20 DIN 913	2	2			Spring	1	1
78	7460	Winding wire	1	1					
79	7460	Filter cage	1	1					
80	7460	Filter foam	1	1					
81	7460	Air box	1	1					
82	7460	Hexagon screw M 6 x 20 DIN 913	2	2					
83	7460	Hexagon screw M 6 x 25 DIN 913	2	2					
84	7460	Hexagon screw M 6 x 25 DIN 913	2	2					
85	7460	Hexagon screw M 6 x 25 DIN 913	2	2					
86	7460	Hexagon screw M 6 x 25 DIN 913	2	2					
87	7460	Hexagon screw M 6 x 25 DIN 913	2	2					
88	7460	Hexagon screw M 6 x 25 DIN 913	2	2					
89	7460	Hexagon screw M 6 x 25 DIN 913	2	2					
90	7460	Hexagon screw M 6 x 25 DIN 913	2	2					
91	7460	Hexagon screw M 6 x 25 DIN 913	2	2					
92	7460	Hexagon screw M 6 x 25 DIN 913	2	2					
93	7460	Hexagon screw M 6 x 25 DIN 913	2	2					
94	7460	Hexagon screw M 6 x 25 DIN 913	2	2					
95	7460	Hexagon screw M 6 x 25 DIN 913	2	2					
96	7460	Hexagon screw M 6 x 25 DIN 913	2	2					
97	7460	Hexagon screw M 6 x 25 DIN 913	2	2					

x - yard goods

alternations preserved



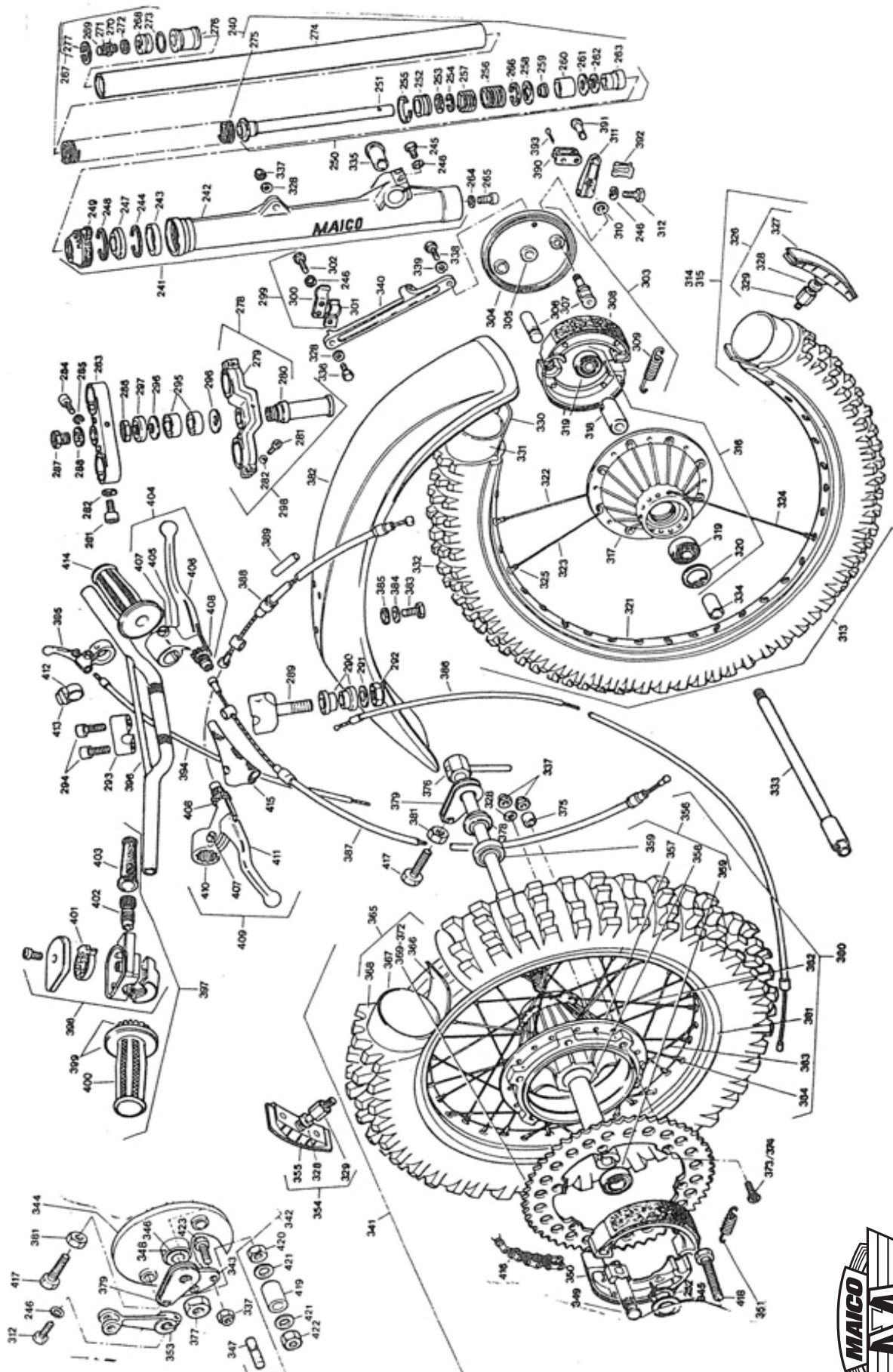

Part. No.	Comp. No.	Description	MC 250 351	MC 490 354	Part. No.	Comp. No.	Description	MC 250 353	MC 490 354
240	4636	Fork leg cpl.	2	2	353	2247	Knockout spindle	1	1
241	4637	Fork slider cpl.	2	2	354	2350	Spacer bush	1	1
242	4638	Fork slider	2	2	355	2430	Bush	1	1
243	4484	Guide bush	2	2	356	2118	Hexagon screw M 6 x 40 DIN 934	1	1
244	4477	Circlip SM 46	2	2	357	4492	Securing nut SM 6 DIN 980	1	1
245	4571	Hexagon screw M 6 x 30 DIN 934	4	4	358	1569	Hexagon screw M 6 x 30 DIN 934	1	1
246	4510	Spring ring B 8 DIN 128	7	7	359	1714	Spring washer B 8 DIN 127	1	1
247	4475	Seal	2	2	360	2147	Brake plate, front	1	1
248	4440	Circlip SM 35 x 1,5	2	2	361	2515	Rear wheel, cpl.	1	1
249	4441	Nipple	2	2	362	2507	Brake plate, cpl.	1	1
250	4635	Damper cpl.	2	2	363	2526	Cover plate	1	1
251	4832	Damper tube	2	2	364	2142	Brake plate	1	1
252	4447	Damper piston	2	2	365	2526	Bush	1	1
253	4448	Washer 21,4 x 20,2 x 0,8	2	2	367	2505	Pivot bolt	1	1
254	4449	Circlip SM 24	2	2	368	2528	Bush	1	1
255	4450	Piston ring	2	2	369	2528	Brake toggle	1	1
256	4452	Stop spring soft	2	2	370	486	Brake shoe, cpl.	2	2
257	4460	Stop spring hard	2	2	371	6123	Tension spring for brake shoe	2	2
258	4426	Valve seat	2	2	372	1874	Securing ring 25 x 1,2 DIN 478	1	1
259	4454	Valve	2	2	373	2843	Brake lever	1	1
260	4437	Damper insert	2	2	374	2474	Tyre holder cpl.	1	1
261	4436	Washer 29,4 x 26,7 x 0,7	2	2	375	2507	Tyre holder plate	1	1
262	4457	Securing ring 37 x 1,5 DIN 472	2	2	376	2511	Rear hub cpl.	1	1
263	4456	Bush for damper	2	2	377	1930	Rear hub	1	1
264	4459	Sealing ring A 10 x 15 DIN 1603	2	2	378	2676	Spacer tube, rear	1	1
265	1675	Inner hexagon screw M 10 x 25 DIN 934	2	2	379	225	Ball bearing 4303 2RS CS	2	2
266	4428	Circlip SM 39	2	2	380	2511	Rear wheel, only	1	1
267	4429	Seal, cpl.	2	2	381	4686	Rim	1	1
268	4431	Seal	2	2	382	4687	Spoke, small flange	18	18
269	2184	Valve, cpl.	2	2	383	6666	Spoke, large flange	18	18
270	2186	Valve insert	2	2					
271	2187	Valve cap	2	2	384	2408	Nipple M 4,5	16	16
272	277	Sealing ring A 8 x 11,5 DIN 7603	2	2	385	2512	Rear wheel with tyre	1	1
273	4464	O-ring 24,74 x 3,33	2	2	386	2005	Rin strap	1	1
274	4637	Fork tube	2	2	387	2015	Tube 4,50 x 38"	1	1
275	4629	Fork spring	2	2	388	2008	Tyre 4,50 x 38"	1	1
276	4628	Spacer tube	2	2	389	2523	Sprocket T10, optional	-	-
277	4457	Securing ring 37 x 1,5 DIN 472	2	2	390	2522	Sprocket T10, optional	-	-
278	4639	Lower cross head cpl.	2	2	391	2521	Sprocket T14, optional	-	-
279	4640	Lower cross head	2	2	392	2514	Sprocket T16, optional	-	-
280	4671	Steering tube	1	1	393	1880	Screw M 8 x 50 DIN 7991	5	5
281	3270	Inner hexagon screw M 10 x 40 DIN 934	4	4	394	1807	Screw M 8 x 40 DIN 7991	5	5
282	2512	Spring ring 1 10 DIN 128	4	4	395	4492	Spacer bush	5	5
283	4473	Upper cross head	1	1	396	2519	Knockout spindle cpl.	1	1
284	1628	Inner hexagon screw M 8 x 40 DIN 912	1	1	397	1709	Securing nut SM 10 x 1,5 DIN 980	1	1
285	1911	Spring ring SM DIN 128	1	1	398	2146	Spacer ring	1	1
286	4474	Steering head nut	1	1	399	2510	Chain tensioner cpl.	2	2
287	4475	Screw plug	1	1	400	2515	Slip-ring	1	1
288	4476	Washer 8 25 DIN 125	1	1	401	4670	Hexagon screw M1 DIN 554	4	4
289	4477	Handle bar clamp low	2	2	402	4493	Front fender	1	1
290	45	Rubber buffer	4	4	403	4569	Hexagon screw M 6 x 20 DIN 934	4	4
291	4642	Washer	2	2	404	2150	Washer 1,4 DIN 904	4	4
292	1653	Securing nut M10 DIN 980	2	2	405	2708	Rubber washer	4	4
293	4478	Upper handle bar clamp	1	1	406	2454	Throttle cable	1	1
294	1628	Inner hexagon screw M 8 x 25 DIN 934	4	4	407	4759	Clutch cable	1	1
295	2577	Roller bearing	2	2	408	4758	Twist cable	1	1
296	2756	Slip-ring	2	2	409	2275	Insulating hose 5 8 x 0,7 DIN 46221	1	1
297	4480	Cover plate	1	1	410	4751	Cable holder	1	1
298	4641	Telescopic fork	1	1	411	4482	Belt	1	1
299	4257	Cable holder cpl.	1	1	412	4751	Clip for bolt	1	1
300	4258	Cable holder	1	1	413	1807	Split pin 5,2 x 25 DIN 94	5	5
301	4255	Cable clamp	1	1	414	375	Decompressor cable	-	1
302	1565	Hexagon screw M 8 x 12 DIN 934	1	1	415	145	Lever for decompressor cpl.	-	1
303	4644	Brake plate cpl.	1	1	416	4686	Clamp for handle bar	1	1
304	2236	Brake plate, only, w. bush	1	1	417	4690	Throttle grip	1	1
305	2238	Brake plate bush	1	1	418	4687	Throttle bearing cpl. (w.cover + screws)	1	1
306	2418	Pivot bolt	1	1	419	4262	Grip with cover	1	1
307	2419	Brake toggle	1	1	420	2146	Cover	1	1
308	1522	Brake shoe	2	2	421	4684	Cap	1	1
309	4146	Tension spring for brake shoe	2	2	422	2711	Support	1	1
410	183	Rubber washer	1	1	423	2212	Rubber cap	1	1
411	4145	Front brake lever	1	1	424	2275	Clutch lever, cpl.	1	1
412	1570	Hexagon screw M 6 x 25 DIN 934	2	2	425	2215	Bracket for clutch lever	1	1
413	4638	Front wheel, cpl.	1	1	426	2275	Hand clutch lever	1	1
414	4637	Front wheel with tyre	1	1	427	533	Screw with nut	2	2
415	4632	Front wheel, only	1	1	428	217	Adjusting screw with nut	2	2
416	4633	Front hub, cpl.	1	1	429	2238	Brake lever cpl.	1	1
417	4630	Front hub	1	1	430	2217	Strap for brake lever with screw	1	1
418	2428	Spacer tube for front hub	1	1	431	2271	Brake hand lever	1	1
419	2427	Ball bearing 4302 RS DIN 625	2	2	432	2222	Kill button with rubber cap	1	1
420	1951	Securing ring 25 x 1,5 DIN 472	1	1	433	2221	Rubber cap	1	1
421	4675	Acrofit rim	1	1	434	2510	Rubber grip	1	1
422	4674	Spoke large flange, outer	9	9	435	2704	Lever cover	2	2
423	4675	Spoke large flange, inner	9	9	436	4744	Chain	1	1
424	4676	Spoke small flange	18	18	437	1515	Hexagon screw M 8 x 25 DIN 934	2	2
425	2242	Nipple 4,5 M 4	36	36	438	1618	Hexagon screw M 10 x 50 DIN 934	1	1
426	166	Tyre holder cpl.	1	1	439	2540	Bush, shaft	1	1
427	2568	Tyre holder plate, cpl.	1	1	440	1674	Hexagon nut M 10 DIN 934	1	1
428	1934	Washer 8 10,4 DIN 125	8	8	441	1735	Washer 8 10,4 DIN 125	2	2
429	289	Nut for tyre holder	2	2	442	1695	Securing nut M 10 DIN 980	1	1
430	2001	Tyre 1.00-21"	1	1	443	1589	Hexagon screw M 8 x 30 DIN 934	3	3
431	2002	Tyre 1.00-21*	1	1					
432	2003	Tyre 1.00-21* Del.D	1	1					

* = yard goods





alpha e

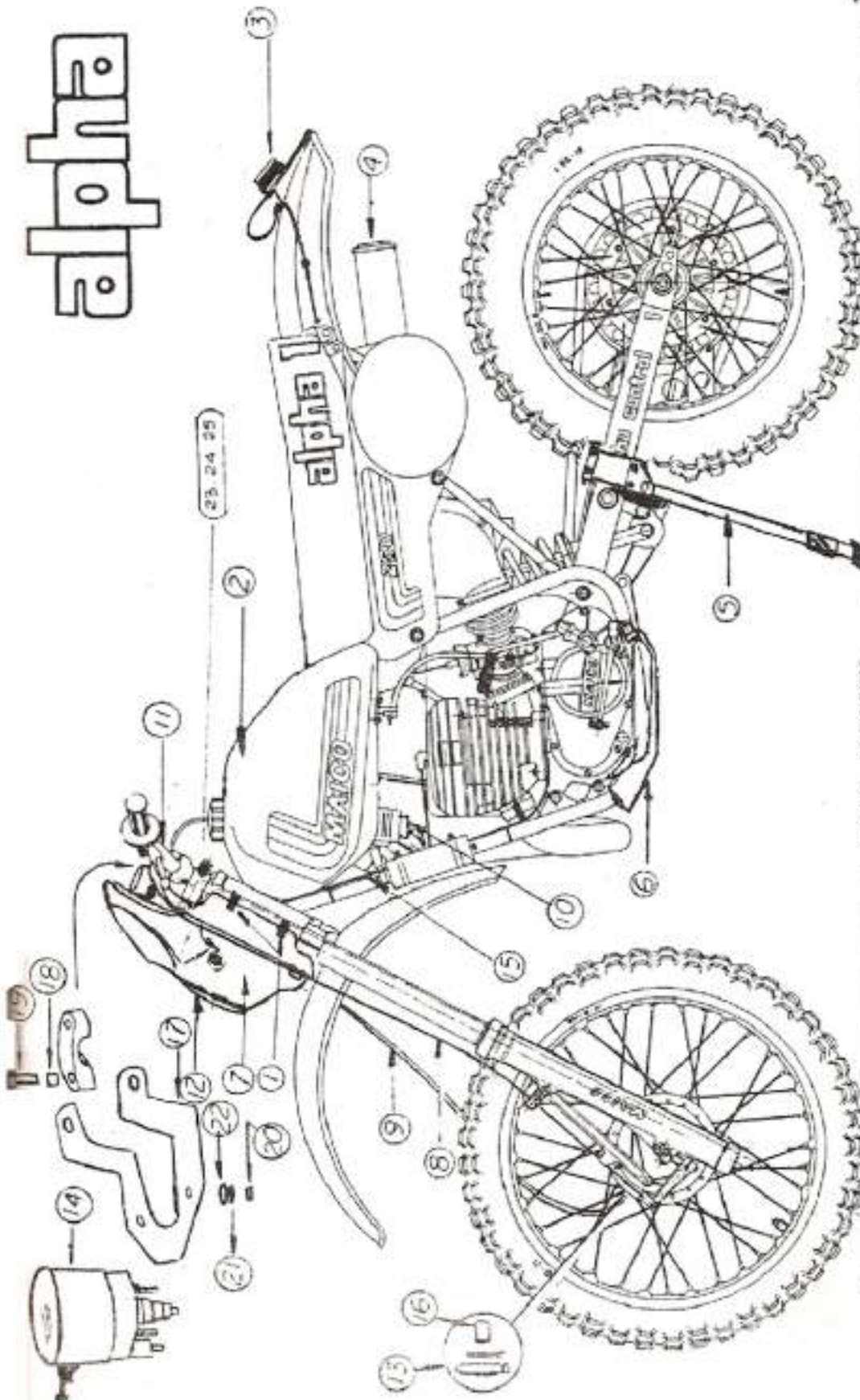

9054

ALPHA E - ENGLISH PARTS

Fig. No.	Part No.	Description	Fig. No.	Part No.	Description	Fig. No.	Part No.	Description
(1)	683	Clamp	(7)	7448	No plate shield	(16)	5625	Spacer CEV
(2)	7590	Gas tank 2.8 Gal	(8)	7184	Brake cable	(17)	3002	Sperto mount
(3)	82189	Gas tank & Gal	(9)	7134	Speedometer cable	(18)	7136	Spacer
(4)	82190	Totl 14ght	(10)	7101	Wiring main	(19)	1648	Bolt
(5)	82195	Spark arrester muffler 250	(11)	7100	Wiring w/lt switch	(20)	1649	Kit 2mm
(6)	82196	Spark arrester muffler 490	(12)	7165	Headlight	(21)	1758	Washer
(7)	82192	Side stand CPL	(12a)	82189a	Headlight	(22)	2708	Washer
(8)	82191	Sold plate CPL	(13)	7341	CV drive	(23)	1591	Bolt
(9)	82189	No Plate shield	(14)	3262	CV drive	(24)	1734	Washer
(10)		Accessories - Crossline Products	(15)	2002	Wiring hardware	(25)	1511	Washer

ALPHA E - ENDURO ENGINE PARTS

Picture No.	Part No.	Description
99	2025	Mainshaft
101	3449	1st gear on mainshaft G 17T
102	3706	Spacer ring
103	3435	4th gear on mainshaft MG 26T
104	3443	3rd gear on mainshaft G 23T
105	492	Retainer ring
106	3448	2nd gear on mainshaft G 20T
107	3723	Shim
108	2949	5th gear on mainshaft 28T GT
109	3893	Spacer washer
110	5697	Layshaft GT1
111	913	Needle gauge
112	3446	1st gear on layshaft 28T G1
113	3450	Twin block 18/21 G
114	3456	Shim
115	3447	2nd gear on layshaft 24T G1
116	3757	Needle gauge
117	2048	Drive shaft 29T GT
118	2038	Plug
120	513	Bearing
170	3530	Sleeve
171	1630	Socket screw M 5x16
172	1731	Washer
173	1123	Nut
176	1567	Hexagon screw
177	1732	Shim
178	1690	Hexagon nut MM6 DIN 980
184	5396	Bosch electronic ignition CPL
185	5397	Stator (NA)
186	5398	Rotor (NA)
187	5399	Electronic Box
188	5404	Support for electronic box
189	3884	Cable plug
190	60	Cable plug
191	1126	Cable plug
192	589	High tension lead
193	3308	Connector
194	3087	Rubber cap
195	3305	Connector female
196	3577	Connector housing
197	3596	Connector female
198	5730	Cable
199	2611	Cable sleeve
200	2610	Cable sleeve
201	2608	Cable sleeve
202	2607	Cable housing
109.1	3201	0.8 mm shim

