

# 1981 SPARE PARTS CATALOGUE

MODEL: Mega 2

CHASSIS TYPE:	MC 250/T	Type 350	Engine Type 350
	MC 400/T	Type 351	Engine Type 351
	MC 490/T	Type 352	Engine Type 352

## CHASSIS DESCRIPTION

Mega form frame with boxed backbone. 50mm shortened frame profile and 50mm shortened fork slider with 35mm shortened fork tubes. New brake pedal and rear wheel setup. New pipe design. New style fender, side panels, Corte Cosso rebuildable reservoir piggyback shocks 365mm long.

## ENGINE DESCRIPTION

Large engine cases with different stud pattern. 490 piston ported engine. 250's are reed valve injection and equipped with 38mm carburetor.

## Frame Identification

Stamped on the steering head:

First 3 numbers

350 0000

## Engine Identification

Stamped on the engine cases:

First 3 numbers

250 MT 350 0000

400 RT 351 0000

490 RT 352 0000

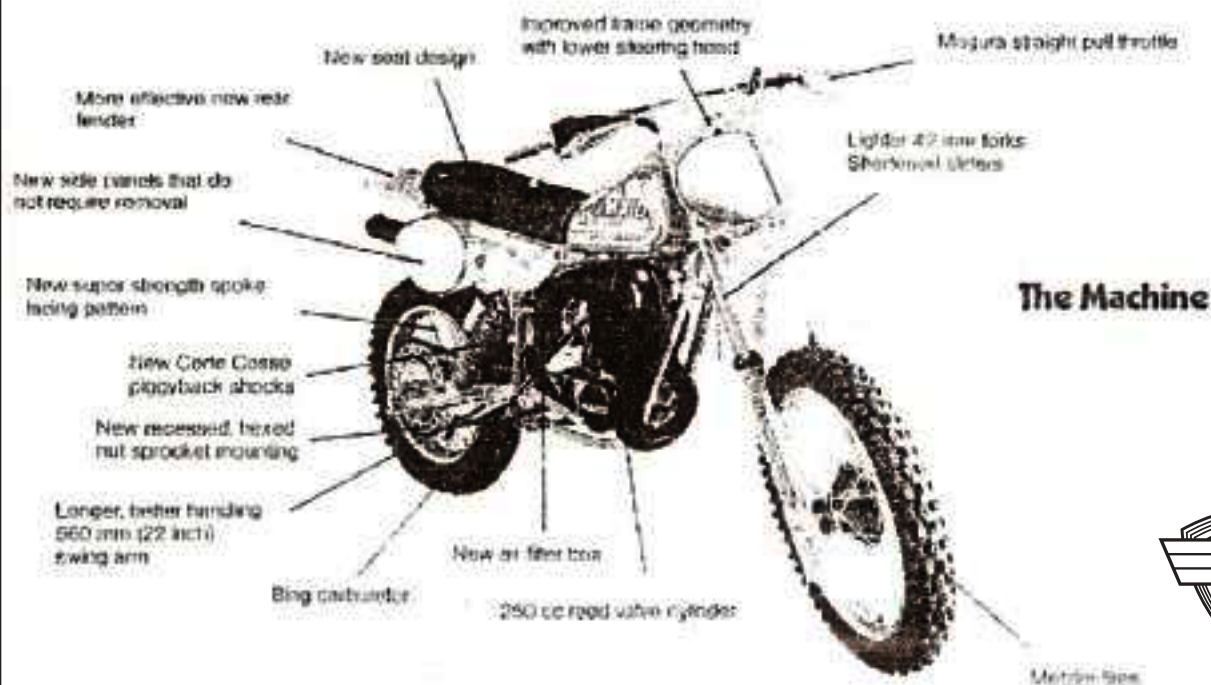

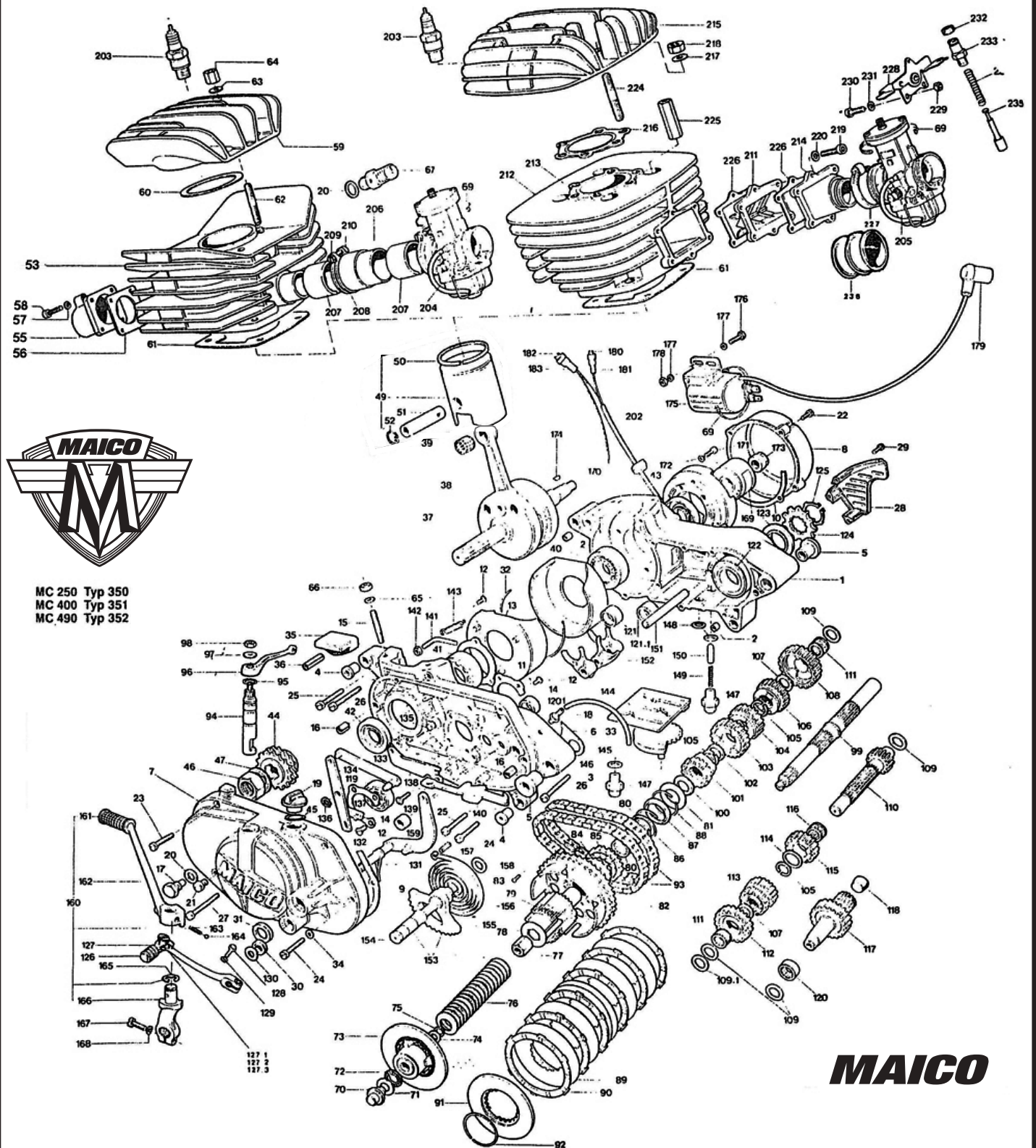

MC 250 Typ 350  
 MC 400 Typ 351  
 MC 490 Typ 352

**MAICO**

EDV No.	Description	MC 250 350	MC 400 351	MC 490 352	Pict No.	EDV No.	Description	MC 250 350	MC 400 351	MC 490 352
6782	Crankcase right hand	1	1	1	59	6584	Cylinder head	-	1	-
1997	Internal ring	2	2	2	-	6541	Cylinder head	-	-	1
6794	Crankcase left hand	1	1	1	60	720	Cylinder head gasket	-	1	-
1995	Engine mounting bushes	4	4	4	-	6942	Cylinder head gasket	-	-	1
1994	Spacer bush for swing arm	2	2	2	61	6793	Cylinder base gasket 0,3 mm	-	-	-
1993	Crankcase gasket	1	1	1	-	6794	Cylinder base gasket 0,5 mm	1	1	1
2143	Crankcase cover	1	1	1	-	6795	Cylinder base gasket 0,7 mm	-	-	-
1991	Ignition cover	1	1	1	62	2968	Cylinder head stud	-	5	5
1990	Crankcase cover gasket left hand	1	1	1	63	1745	Washer $\phi$ 6,2 x 20 x 1,8	-	5	5
1989	Crankcase cover gasket right hand	1	1	1	64	78	Hexagon nut	-	5	5
1988	Main bearing cover plate	1	1	1	65	1714	Spring washer B 8 DIN 137	-	4	4
1795	Counter sunk screw M 5 x 8 DIN 955	11	11	11	66	1670	Hexagon nut M 8 DIN 934	-	4	4
1987	Crankshaft housing	2	2	2	67	517	Decompression valve cpl.	-	1	1
1986	MS bearing cover plate	2	2	2	68	-	-	-	-	-
1787	Stud screw M 6 x 25 DIN 940	4	4	4	69	6760	Rubber cable clip	2	2	2
1831	Tension pla 8 x 10 DIN 7346	2	2	2	70	5720	Push pin	1	1	1
805	Oil drain plug	1	1	1	71	1090	Bearing plate	1	1	1
1985	Breather	1	1	1	72	1084	Needle cage	1	1	1
1984	Oil filling plug	1	1	1	73	5716	Guide for clutch disc	1	1	1
410	Sealing ring A 14 x 18 DIN 7603	1	1	1	74	2050	Washer 10,1 x 18,2 x 0,6	1	1	1
1529	Cylinder head screw M 8 x 10 DIN 84	1	1	1	75	1842	Securing ring	1	1	1
1528	Cylinder head screw M 6 x 25 DIN 84	4	4	4	76	448	Cup spring	10	10	10
1530	Cylinder head screw M 6 x 39 DIN 84	3	3	3	77	448	Guide nut	1	1	1
1538	Cylinder head screw M 6 x 35 DIN 84	5	5	5	78	447	Lock plate for guide nut	1	1	1
1539	Cylinder head screw M 6 x 40 DIN 84	6	6	6	79	2989	Clutch body	1	1	1
1541	Cylinder head screw M 6 x 50 DIN 84	1	1	1	80	736	Needle cage	2	2	2
1542	Cylinder head screw M 6 x 55 DIN 84	3	3	3	81	444	Thrust washer	1	1	1
1983	Counter sprocket cover	1	1	1	82	6602	Clutch housing with kickstarter	1	-	-
1553	Cylinder head screw M 6 x 18 DIN 84	3	3	3	-	1905	Clutch wheel	-	-	1
1865	Sealing ring AS 12 x 22 x 7 DIN 3760	1	1	1	-	-	-	-	-	1
1866	Sealing ring A 18 x 25 x 7	1	1	1	-	-	-	-	-	1
1313	Spring rubber $\phi$ 4-250 long	x	x	x	83	1955	Over head rivet 4 x 10 DIN 662	8	8	8
203	Breather tube $\phi$ 4 x 1,5	x	x	x	84	729	Kickstarter ratchet wheel	1	1	1
407	Flat washer A 6 x 10 DIN 7620	2	2	2	85	730	Kickstarter pinion	1	1	1
2133	Sliding piece	1	1	1	86	731	Ratchet spring	1	1	1
1815	Tension pin 8 x 35 DIN 7346	1	1	1	87	5502	Spring cup	1	1	1
3225	Crankshaft, cpl.	-	-	-	88	5997	Circlip	1	1	1
3258	Crankshaft, cpl.	-	-	-	89	3398	Inner ring	6	6	6
4131	Crankshaft part exchange	-	-	-	90	2396	Clutch disc	6	6	6
4132	Crankshaft part exchange	-	-	-	91	5721	Terminal disc	1	1	1
4162	Connecting rod cpl.	-	-	-	92	491	Circlip	1	1	1
4163	Connecting rod cpl.	-	-	-	93	6803	Primary chain	2	2	2
424	Needle bearing red 0-2	1	1	1	94	407	Clutch spindle	1	1	1
-	Needle bearing blue 2-4	1	1	1	95	464	Sealing ring for clutch spindle	1	1	1
-	Needle bearing white 4-6	1	1	1	96	2866	Clutch lever	1	1	1
426	Roller bearing NU 325 C 3 DIN 5412	1	1	1	97	1732	Washer 8 6,4 DIN 125	1	1	1
693	Ball bearing 3505 C 3 DIN 628	1	1	1	98	1600	Hexagon nut NM 6 DIN 980	1	1	1
547	Sealing ring	1	1	1	99	2025	Mainshaft	1	1	1
3469	Sealing ring	1	1	1	100	2042	M 8 shim	1	1	1
6826	Sprocket for crankshaft	-	-	-	101	3441	1st gear pinion on mainshaft 19 teeth	1	-	-
6827	Sprocket for crankshaft	-	-	-	-	3449	1st gear pinion on mainshaft 17 teeth	-	1	1
1891	Sealing ring for oil filling plug	1	1	1	102	3706	Spacer ring	1	1	1
3240	Guide nut on crankshaft	1	1	1	103	3435	4th gear pinion on mainshaft 20 teeth	1	1	1
3254	Securing plate	1	1	1	104	3434	3rd gear pinion on mainshaft 24 teeth	1	-	-
6918	Piston 66,35 $\phi$ cpl.	1	-	-	-	3567	3rd gear pinion on mainshaft 23 teeth	-	1	1
6920	Piston 67,15 $\phi$ cpl.	1	-	-	105	402	Circlip	3	3	3
6921	Piston 67,35 $\phi$ cpl.	1	-	-	106	3440	2nd gear pinion on mainshaft 21 teeth	1	-	-
532	Piston 70,95 $\phi$ cpl.	-	1	-	-	3448	2nd gear pinion on mainshaft 25 teeth	-	1	1
2467	Piston 77,14 $\phi$ cpl.	-	1	-	107	3723	Shim for 1st gear	2	2	2
2452	Piston 77,34 $\phi$ cpl.	-	1	-	108	2039	5th gear pinion on mainshaft 26 teeth	1	1	1
2072	Piston 77,54 $\phi$ cpl.	-	1	-	109	3993	Spacer washer	5	5	5
2470	Piston 77,74 $\phi$ cpl.	-	1	-	110	5987	Layshaft (M1)	1	1	1
2471	Piston 77,94 $\phi$ cpl.	-	1	-	111	913	Needle cage K16 x 21 x 10	2	2	2
6913	Piston 86,44 $\phi$ cpl.	-	-	1	112	3436	1st gear pinion on layshaft 26 teeth	1	-	-
6915	Piston 86,64 $\phi$ cpl.	-	-	1	-	3446	1st gear pinion on layshaft 28 teeth	-	1	1
6916	Piston 86,84 $\phi$ cpl.	-	-	1	113	3442	Twinklack pinion on layshaft 15/21 teeth	1	1	1
6917	Piston 87,04 $\phi$ cpl.	-	-	1	-	-	-	-	-	-
6918	Piston 87,24 $\phi$ cpl.	-	-	1	114	3458	Shim for 2nd gear	1	1	1
6919	Piston 87,44 $\phi$ cpl.	-	-	1	115	3459	2nd gear pinion on layshaft 23 teeth	1	-	-
6919	Piston ring 67,00 $\phi$	1	-	-	-	3467	2nd gear pinion on layshaft 24 teeth	-	1	1
6924	Piston ring 67,20 $\phi$	1	-	-	116	3757	Needle cage K20 x 24 x 12	1	1	1
6925	Piston ring 67,40 $\phi$	1	-	-	-	-	-	-	-	-
534	Piston ring 77,05 $\phi$	-	1	-	-	-	-	-	-	-
2435	Piston ring 77,25 $\phi$	-	1	-	-	-	-	-	-	-
2437	Piston ring 77,40 $\phi$	-	1	-	-	-	-	-	-	-
2079	Piston ring 77,60 $\phi$	-	1	-	-	-	-	-	-	-
2439	Piston ring 77,80 $\phi$	-	1	-	-	-	-	-	-	-
2440	Piston ring 78,00 $\phi$	-	1	-	-	-	-	-	-	-
6914	Piston ring 86,5 $\phi$	-	-	1	-	-	-	-	-	-
6920	Piston ring 86,7 $\phi$	-	-	1	-	-	-	-	-	-
6921	Piston ring 86,9 $\phi$	-	-	1	-	-	-	-	-	-
6922	Piston ring 87,1 $\phi$	-	-	1	-	-	-	-	-	-
6923	Piston ring 87,3 $\phi$	-	-	1	-	-	-	-	-	-
6924	Piston ring 87,5 $\phi$	-	-	1	-	-	-	-	-	-
535	Piston pin	1	1	1	-	-	-	-	-	-
537	Piston pin	1	1	1	-	-	-	-	-	-
538	Circlip	2	2	2	-	-	-	-	-	-
6991	Radial cylinder cpl.	-	-	1	-	-	-	-	-	-
6938	Radial cylinder cpl.	-	-	1	-	-	-	-	-	-
2159	Cylinder liner	-	-	1	-	-	-	-	-	-
6940	Cylinder liner	-	-	1	-	-	-	-	-	-
6930	Exhaust flange	-	-	1	-	-	-	-	-	-
228	Gasket for exhaust flange	-	-	1	-	-	-	-	-	-
1704	Spring ring B 8 DIN 127	-	4	4	-	-	-	-	-	-
1635	Socket screw M 6 x 25 DIN 912	-	4	4	-	-	-	-	-	-



Pict. No.	EDV No.	Description	350 MC 250	351 MC 400	352 MC 490	The Following Part Numbers have been changed and corrected		
117	2037	Drive shaft 28 teeth	1	1	1			
118	2038	Plug	1	1	1			
119	309	Ball bearing 6305 C3 DIN 625	1	1	1	Picture No.	Part No.	Description
120	513	Needle bearing HK 1612	2	2	2	120.1	5596	Layshaft bearing left hand
121	514	Needle bearing HK 1616	2	2	2	121.1	5598	Layshaft bearing right hand
122	375	Ball bearing 6208 2 RS C3 DIN 625	1	1	1	109.1	3201	0.8mm shim
123	2044	Spacer ring	1	1	1	126	6530	Rubber pad
124	2483	Sprocket 13 teeth	1	1	1	127-1	6787	Lever
125	3720	Sprocket 14 teeth	1	1	1	127.3	6588	Screw
125	5848	Lock ring 29 X 1.5 DIN 671	1	1	1		6589	Spring
125/177	6585	Gear change lever	1	1	1	236	3143	Intake manifold
126	1570	Hexagon screw M 6 x 25 DIN 933	1	1	1	49	6922	Piston 3rd over size 250
129	1726	Spring washer A 6,4 DIN 6798	1	1	1		6923	Piston 4th over size 250
130	2324	Washer 12,1 x 26,2 x 1	1	1	1		6929	Piston 5th over size 250
131	573	Return spring	1	1	1	50	2067	3rd over piston ring 250
132	6911	Gear change crank	1	1	1		6927	4th over piston ring 250
133	2306	Pullrod	1	1	1		6928	5th over piston ring 250
134	2374	Pullrod pivot arm	1	1	1			
135	1903	Pivot pin A 8 x 20 DIN 1469	1	1	1			
136	1836	Securing ring B x 0,8 DIN 471	1	1	1			
137	2378	Hooked ratchet sliding arm	1	1	1			
138	2508	Guide plate	1	1	1			
139	1795	Countersunk screw 5 x 8 DIN 955	2	2	2			
140	2510	Hooked ratchet-T 1	1	1	1			
141	2388	Hook	1	1	1			
142	1667	Hexagon nut M 6 DIN 934	1	1	1			
143	576	Tension spring for hooked ratchet	1	1	1			
144	3406	Shifting plate cpl.	1	1	1			
145	3402	Shifting segment	1	1	1			
146	2297	Shim 10,5 x 19,2 x 1	1	1	1			
147	2393	Guide screw	2	2	2			
148	410	Sealing ring A 14 x 10	1	1	1			
149	2335	Tension spring	2	2	2			
150	2316	Pawl pin	1	1	1			
151	2399	Gear selection fork spindle	1	1	1			
152	3414	Gear selection fork	3	3	3			
153	2566	Kickstarter spindle cpl.	1	1	1			
154	2550	Kickstarter spindle	1	1	1			
155	761	Kickstarter quadrant	1	1	1			
156	666	Return spring	1	1	1			
157	1829	Tension bush 5 x 20 DIN 1481	1	1	1			
158	1750	Shim 12,2 x 30,2 x 0,5	1	1	1			
159	3353	Internal ring	1	1	1			
160	3035	Kickstarter lever cpl.	1	1	1			
161	658	Rubber pad	1	1	1			
162	6033	Kickstarter lever	1	1	1			
163	3867	Compressions spring for kickstarter	1	1	1			
164	1874	Ball Ø 7	1	1	1			
165	1842	Lock washer	1	1	1			
166	5034	Kickstarter joint	1	1	1			
167	1570	Hexagon screw M 6 x 25 DIN 933	1	1	1			
168	1704	Spring ring B 6	1	1	1			
169	3586	Metaplat ignition cpl.	1	1	1			
170	3530	Rubber sleeve	1	1	1			
171	1830	Socket screw M 5 x 18 DIN 912	3	3	3			
172	1731	Shim Ø 5,3 DIN 125	3	3	3			
173	1123	Nut for generator	1	1	1			
174	1881	Woodruff key 3 x 3,7 DIN 6838	1	1	1			
175	3900	Ignition coil metaplat	1	1	1			
176	1567	Hexagon screw M 6 x 18 DIN 933	2	2	2			
177	1732	Shim B 6,4 DIN 125	4	4	4			
178	1690	Hexagon nut NM 6 DIN 910	2	2	2			
179	3610	Cable plug	1	1	1			
180	3576	Connector 6,3-1 DIN 46247	1	1	1			
181	3536	Connector housing 6,3	1	1	1			
182	3585	Connector 9,5-6 DIN 46247	1	1	1			
183	3547	Connector housing 9,5	1	1	1			
202	2867	Wirehousing B Ø 3 x 0,4 DIN 40621	x	x	x			
203	603	Spark plug Champion 142	1	1	1			
204	6335	Carburetor cpl. Bing V54/40/101/II	--	1	--			
--	6904	Carburetor cpl. Bing V54/60/106/II	--	--	1			
205	6905	Carburetor cpl. Bing V54/38/111/II	1	--	--			
206	6733	Intake flange	--	1	1			
207	5342	Bush	--	1	1			
208	5334	Clamp	--	1	1			
209	620	Screw	--	1	1			
210	621	Nut	--	1	1			
211	6796	Reed valve cpl.	1	--	--			
212	6788	Cylinder 250 cpl.	1	--	--			
213	6789	Cylinder liner Ø 67	1	--	--			
214	6996	Intake flange	1	--	--			
215	6791	Cylinder head 250	1	--	--			
216	6792	Cylinder head gasket	1	--	--			
217	1734	Washer B 8,4 DIN 125	6	--	--			
218	1670	Hexagon nut M 6 DIN 934	10	--	--			
219	1835	Socket screw M 6 x 25 DIN 912	6	--	--			
220	1510	Washer B 6 DIN 126	6	--	--			
224	2967	Cylinder head stud	6	--	--			
225	6787	Nut	2	--	--			
226	6810	Intake gasket	2	--	--			
227	6813	Clamp	1	--	--			
228	6912	Choke lever	1	--	--			
229	6914	nut	2	--	--			
230	6913	screw	2	--	--			
231	1509	Washer	2	--	--			
232	6911	Rubber cap	1	--	--			
233	6910	Choke housing	1	--	--			
234	6809	Spring	1	--	--			
235	6806	Choke piston	1	--	--			



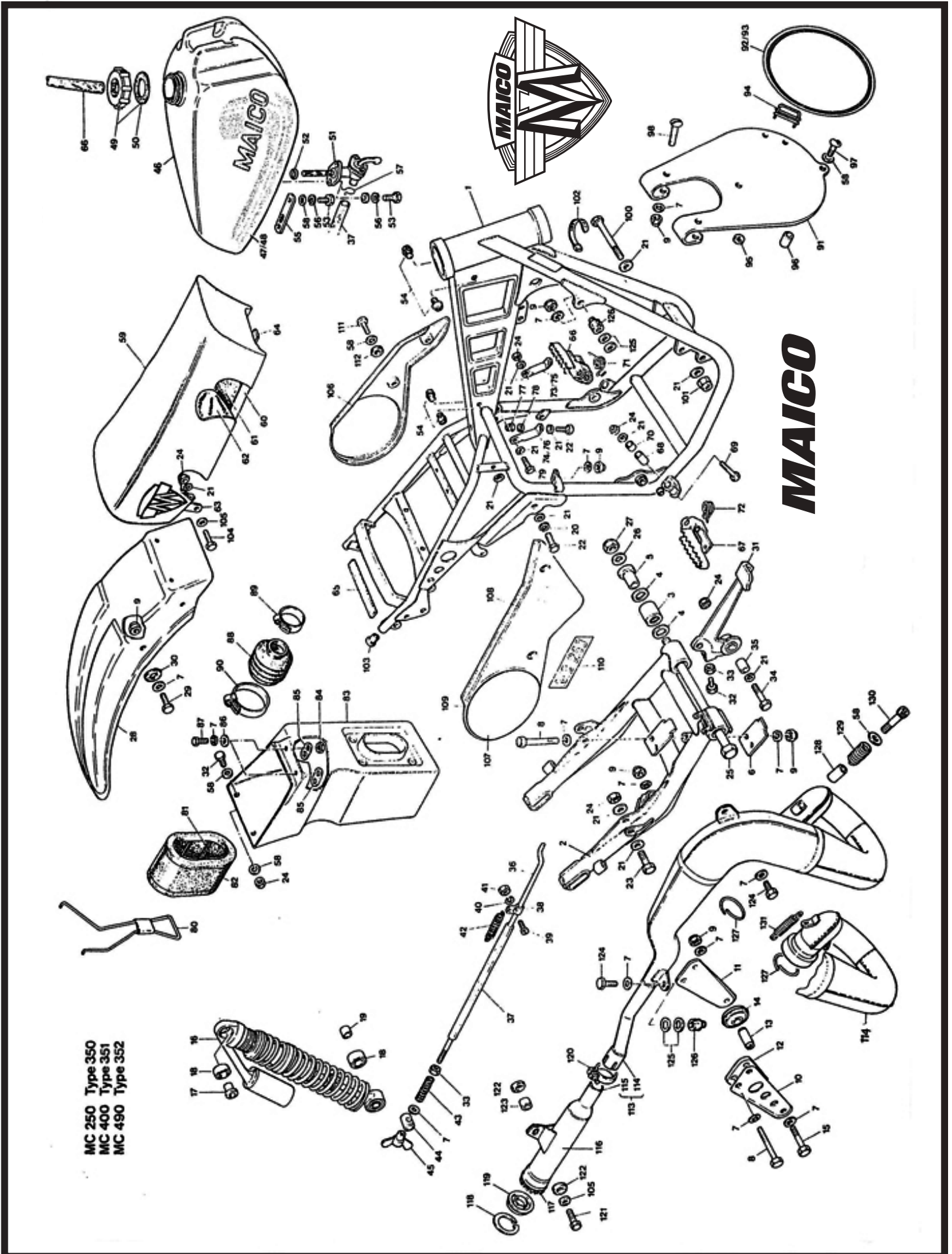

MC 250 Type 350  
MC 400 Type 351  
MC 490 Type 352



**MAICO**

Pict. No.	EDV No.	Description	MC 250			Pict. No.	EDV No.	Description	MC 400		
			250	351	400				352	250	351
1	6827	Frame cpl.	1	1	1	82	6545	Air filter foam	1	1	1
2	6851	Swing arm	1	1	1	83	6743	Air box	1	1	1
3	2632	Needle cage HK 2020	2	2	2	84	1630	Hexagon nut NM 6 DIN 960	4	4	4
4	1530	O-ring	4	4	4	85	6709	Hook	2	2	2
5	1631	Swing arm bush	2	2	2	86	3529	Washer	2	2	2
6	1632	Guide plate	2	2	2	87	1570	Hexagon screw M6 x 25 DIN 933	2	2	2
7	1732	Washer B 6.4 DIN 125	30	30	30	88	343	Intake manifold	1	1	1
8	1575	Hexagon screw M6 x 80 DIN 931	3	3	3	89	683	Clamp	1	1	1
9	1680	Hexagon nut NM 6 DIN 960	13	13	13	90	348	Clamp	1	1	1
10	1533	Chain guide right	1	1	1	91	6555	Front no. panel	1	1	1
11	1634	Chain guide left	1	1	1	92	6252	Number plate decal, green front	1	-	-
12	1635	Plastic guide	2	2	2	93	6281	Number plate decal, yellow front	-	1	1
13	1535	Bush for roller	3	3	3	94	6247	Cable guide	1	1	1
14	1567	Roller	2	2	2	95	6265	Spring nut	2	2	2
15	5533	Hexagon screw M6 x 40 DIN 931	1	1	1	96	2094	Sliding roller	2	2	2
16	6650	Damper cpl.	2	2	2	97	6253	Plastic screw M6 x 30	2	2	2
	6775	Spring set black - hard	nB	nB	nB	98	3711	Plastic screw M6 x 22	2	2	2
	6772	Spring set gold - soft	nB	nB	nB	99	6254	Set mount bolts, parts of pict. no. 160,4 x 21, 101	1	1	1
	6765	Spring set red - medium	nB	nB	nB	100	1610	Hexagon screw, M6 x 120 DIN 931	2	2	2
	6773	Set piston shaft BE-sand	nB	nB	nB	101	1700	Nut M4 x DIN 980	2	2	2
	6787	Set piston shaft 2H - GP	nB	nB	nB	102	325	Rubber cable clip	8	8	8
	6772	Set piston shaft 5 G - Enduro	nB	nB	nB	103	6705	Rubber plug	2	2	2
17	6638	Bush	2	2	2	104	1567	Hexagon screw M6 x 16 DIN 933	2	2	2
18	6659	Silentbloc	4	4	4	105	1758	Washer B 6.4 DIN 1021	3	3	3
19	6679	Bush	2	2	2	106	6746	Side panel left	1	1	1
20	1305	Spring ring B 8 DIN 127	2	2	2	107	4153	Green number plate decal	-	2	2
21	1734	Washer B 6.4 DIN 125	23	23	23		4152	Yellow no. plate decal	2	-	-
22	1594	Hexagon screw M6 x 40 DIN 931	4	4	4	108	6752	Decal right	1	1	1
23	1595	Hexagon screw M6 x 40 DIN 931	2	2	2		6730	Decal left	1	1	1
24	1692	Securing nut NM 8 DIN 981	6	6	6	109	6749	Side panel right	1	1	1
25	3937	Swing arm spindle	1	1	1	110	6747	Sticker 250	1	-	-
26	1718	Spring washer B 14 DIN 137	1	1	1		6883	Sticker 400	-	-	-
27	5011	Nut NM 14 x 1,5 DIN 980	1	1	1		6755	Sticker 490	-	-	-
28	6669	Rear fender	1	1	1	111	5550	Screw M6 x 16 DIN 988	4	4	4
29	1558	Hexagon screw M6 x 16 DIN 933	4	4	4	112	2700	Rubber washer	4	4	4
30	2100	Rubber washer	4	4	4	113	6865	Exhaust system cpl.	1	-	-
31	6699	Brake lever	1	1	1		6856	Exhaust system cpl.	-	1	1
32	1589	Hexagon screw M6 x 20 DIN 933	3	3	3	114	6601	Exhaust system	1	-	-
33	1667	Hexagon nut M6 DIN 934	2	2	2		6844	Exhaust system	-	1	1
34	1599	Hexagon screw M6 x 60 DIN 931	1	1	1	115	6892	Silencer cpl.	1	-	-
35	6702	Bush for brake lever	1	1	1		6810	Silencer cpl.	-	1	1
36	6703	Rear brake rod	1	1	1	116	6893	Silencer	1	-	-
37	406	Hose	1	1	1		6876	Silencers	-	1	1
38	327	Clamp	1	1	1	117	6501	Exhaust packing	1	-	-
39	1527	Cylinder head screw M4 x 10 DIN 94	1	1	1		6651	Exhaust packing	-	1	1
40	1702	Spring ring B 4 DIN 127	1	1	1	118	1094	Securing ring 70 x 2.5 DIN 472	1	1	1
41	1665	Hexagon nut M4 DIN 934	1	1	1	119	6662	Silencer end cap	1	1	1
42	236	Extension spring	1	1	1	120	5474	Clamp S 38/15	1	1	1
43	342	Compression spring	1	1	1	121	1591	Hexagon screw M6 x 25 DIN 933	1	1	1
44	244	Nipple holder	1	1	1	122	3245	Rubber washer	2	2	2
45	243	Wing nut	1	1	1	123	5453	Bush for exhaust mount	1	1	1
46	6713	Tank with decal	1	1	1	124	1657	Hexagon screw M6 x 16 DIN 933	2	2	2
47	6714	Tank decal left	1	1	1	125	5430	Asbestos washer	4	4	4
48	6715	Tank decal right	1	1	1	126	1156	Assembled for exhaust	2	2	2
49	6515	Tank cap cpl.	1	1	1	127	168	Asbestos cord	x	x	x
50	6516	Sealing ring	1	1	1	128	6276	Silence for exhaust spring	-	1	1
51	6309	Pet cock	1	1	1	129	6275	Spring for exhaust	-	1	1
52	6510	O-ring	1	1	1	130	1723	Socket screw M6 x 70 DIN 912	-	1	1
53	1525	Hexagon screw M6 x 14 DIN 933	4	4	4	131	6866	Spring for exhaust	2	-	-
54	6631	Rubber stop	4	4	4						
55	6511	Holding plate for tank	1	1	1						
56	1704	Spring ring B6 DIN 127	4	4	4						
57	2832	Hose clip	2	2	2						
58	1750	Washer B 6.4 DIN 9321	12	12	12						
59	6723	Seat cpl.	1	1	1						
	6726	Seat cpl. high	nB	nB	nB						
60	6723	Seat base	1	1	1						
61	6724	Seat foam	1	1	1						
	6727	Seat foam high	nB	nB	nB						
62	6728	Seat cover, low	1	1	1						
	6728	Seat cover high	nB	nB	nB						
63	6721	Seat bracket	1	1	1						
64	6722	Clamp holder for seat	1	1	1						
65	6799	Rubber strap, adhesive	x	x	x						
66	6733	Foot peg left	1	1	1						
67	6736	Foot peg right	1	1	1						
68	6738	Bush for foot peg	2	2	2						
69	1567	Hexagon screw M6 x 33 DIN 931	2	2	2						
70	6750	Spacer bush	2	2	2						
71	6739	Foot peg spring left	1	1	1						
72	6740	Foot peg spring right	1	1	1						
73	6741	Cylinder head stay left	1	-	-						
74	6742	Cylinder head stay right	1	-	-						
75	6660	Cylinder head stay left	-	1	1						
76	6661	Cylinder head stay right	-	1	1						
77	78	Hexagon nut long M6, 14 mm	2	2	2						
78	1511	Spring ring B 8 DIN 125	2	2	2						
79	1509	Hexagon screw M 8 x 20 DIN 950	2	2	2						
80	6540	Holding wire	1	1	1						
81	6544	Air filter cage	1	1	1						



