

MAICO

1984 Spare Parts

1984 is first year for M-STAR. (USA only)

NOTE : This parts listing only lists those parts which differ from the 1983 model. When searching for a 1984 part number, if the part is not listed here, use the part listed for the 1983 model.

Contents:

Page 113 : Engine diagram 500 - see page 118-section A for parts changed for 1984.

Page 114 : Enduro gearbox 250, 500 - see page 118-section B for parts list.

Page 115 - 117 : Frame parts for 500 - see 1983 diagrams for corresponding drawing (Bild) numbers.

Page 118 : Parts list for engine parts changed for 1984. See page 127-128 for MX gears.

Page 119 - 126 : Parts for 250, 500 changed for 1984. (This list duplicates SC500 frame parts listed in pages 115 - 117.)

Page 124 : SC 250 Engine parts pertaining to water cooling system.

Page 127 - 128 : Motocross gearbox parts, SC 250 and SC 500.

Model:	SC 250	SC 500
Chassis Type:	SC 250 - 363	SC 500 - 364
Engine Type :	SC 250 - 363	SC 500 - 364

Chassis Description

250 has changes to accommodate water cooling. Frame is silver. Gas tank/radiator shrouds for 250 differ from 500 because of water cooling. Plastic is by UFO. Blue seat by Technosel.

Engine Description

250 engine is water cooled. 500 is air cooled. Transmission is changed to 5-speed in both models. All non-splined gears now ride on needle bearings. Enduro is 5-speed wide ratio transmission.

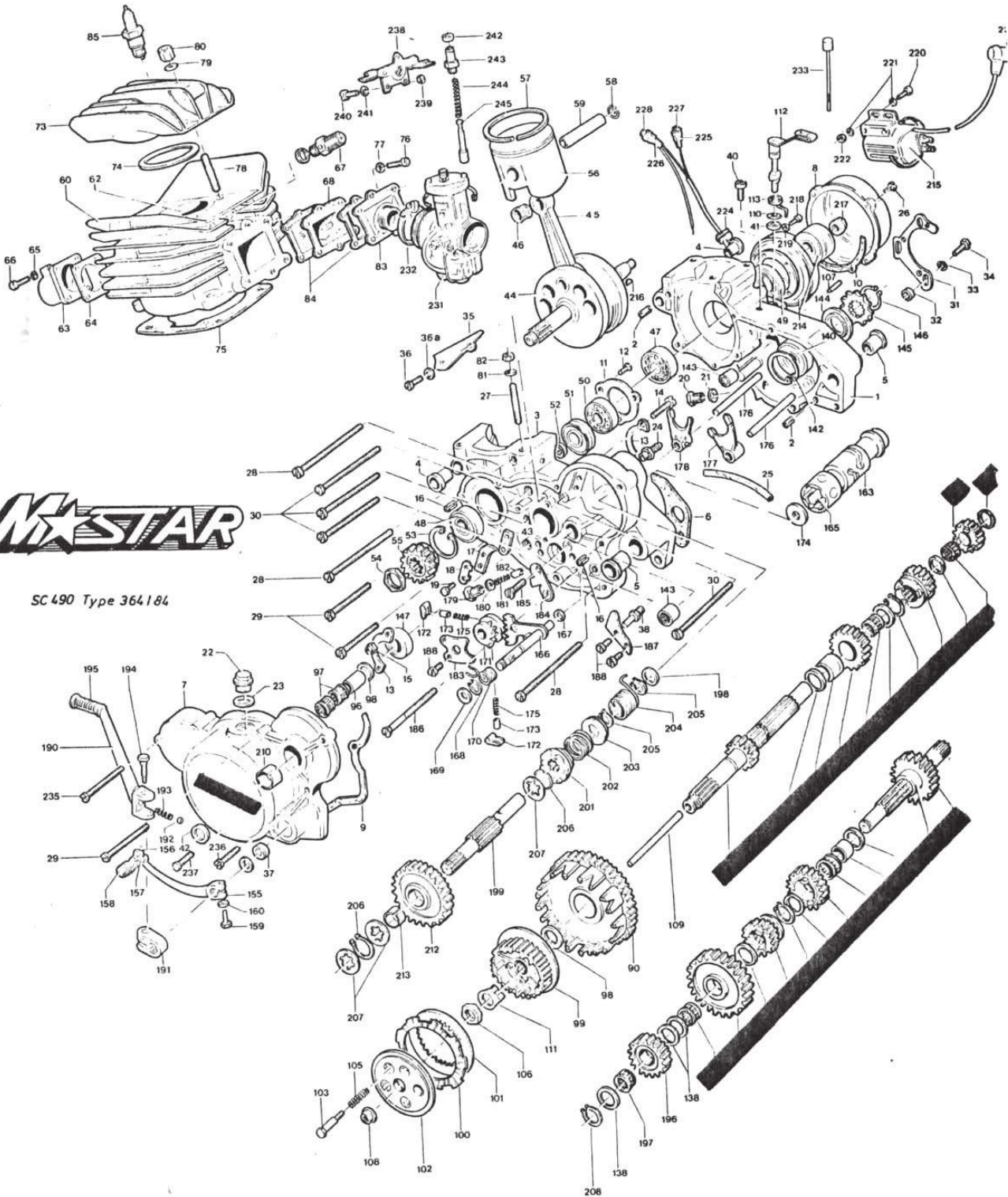

MAICO

SC 490 Type 364184

STD SPKT 52/14
CHAIN 116L



E-Getriebe 1984

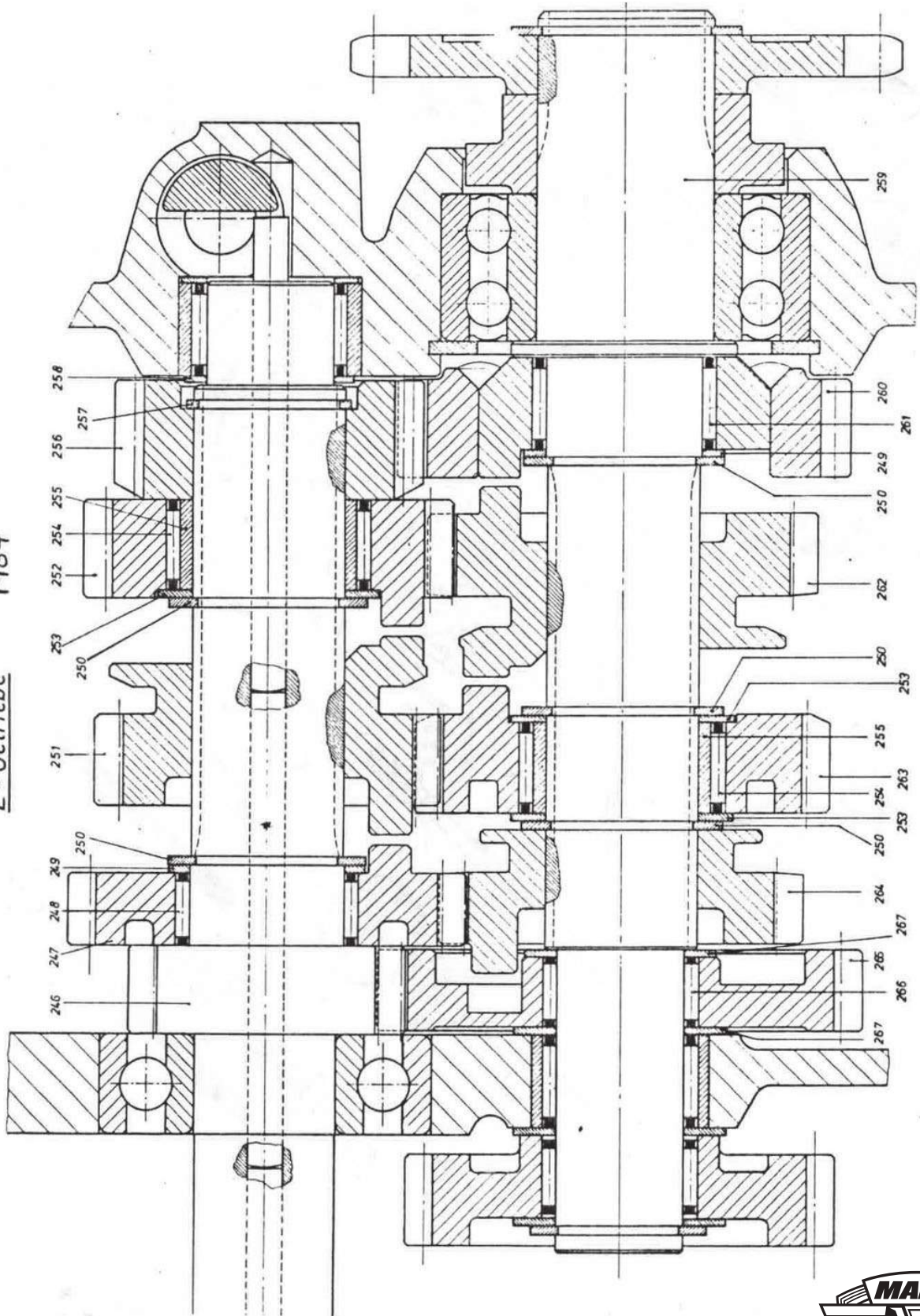

24/84



Supplement to the spare parts catalogue(only valid for SC 490 USA/84)

Please consider the following parts if you order spare parts.

Take the picture-number of the explosion design; control at first in the supplement for SC 490 USA/84 if the picture-number is indicated; if not take the order-number under the picture-number for type 362 MC 490 modell 83.

Bild Nr.	EDV Nr.	Bezeichnung	Typ 364
1	8507	Frame	1
2	8650	Telescopic fork cpl.	1
3	8649	Fork leg cpl.	2
4	8648	Fork slider cpl.	2
5	8646	Fork slider with bush	2
13	8647	Fork wiper	2
6	8645	Fork slider only	2
61	8510	Rear wheel swing arm	1
67	7875	Bush	2
69	8606	Toggle arm cpl.	1
70	8607	Toggle	1
71	8608	Bush	4
73	8609	Hinge bearing	1
73a	8610	Washer	2
73b	8611	Sealing ring	2
74a,91		no indications	
92	8513	Chain guide	1
		Parts of chain guide	
	8514	Plastic plate for chainguide	2
	8515-101	Spacer tube LOWER	2
	8516	Spacer tube UPPER	2
	8493	Supporting plate for chain guide (alum)	2
	1937	Roller for chain guide	2
	1580	Hexagon screw M6x45 DIN 933	2
	1690	Securing nut NM 6	2
93	1596	Hexagon Screw M8x50 Din 931	1
94	1734	Washer B 84 DIN 125	2
95	1692	Securing nut NM 8 DIN 980	1

- 2 -

Bild Nr.	EDV Nr.	Description	Type 364
98	8517	Rear wheel swing arm with bearings	1
103	8612	Spindle	1
104, 106		no indications	
105	8614	Securing nut M 14x1,5	1
111	8651	Rear fender	1
117	8521	Throttle cpl.	1
120	8623	Brake lever cpl.	1
121-123		no indications	
125	8522	Clutch lever cpl.	1
126,127		no indications	
	8552	Hand cover	1
		Fastening for hand protection	
	8524	Screw M5x20 DIN 85	2
	1689	Securing nut NM5 DIN 980	2
131		no indications	
149	7883	Tire 90/80x21 Metzeler 51 G	1
184	7881	Rear axle	1
185	7888	Sprocket Z 50	
	7886	Sprocket Z 52 (STD)	
	7887	Sprocket Z 54	
203	7884	Tire 140/80x18 Metzeler 70 G	1
223,225,226		no indications	
224	8526	Tank	1
227	8529	Tank cap	1
228	8531	Cover gasket	1
		Tank fastening	
	8603	Cable sleeve	2
	8604	Spacer tube	2
	1750	Washer B 6,4 DIN 9021	2
	1570	Hexagon Screw M6x25 DIN 933	2



- 3 -

Bild Nr.	EDV Nr.	Description	Type 364
232	3738	Oval head screw	2
233-235,238		no indications	
243	8537	Seat cpl.	1
244	8541	Seat padding	1
245	8542	Seat cover	1
	8538	Plastic-snout	1
	8539	Holding plate	1
	8540	Blind rivet	1
276	7988	Splash guard	1
	1568	Hexagon screw M6x18 DIN 933	2
	1690	Securing nur NM6 DIN 980	2
	1750	Washer B 6,4 DIN 9021	4
297	8544	Chain with lock 5/8"x 1/4" 116	1
299-300		no indications	
		Seat fastening	
303	1567	Hexagon screw M6x16 DIN 933	2
	1750	Washer B 6,4 DIN 9921	4
	1690	Securing nur NM 6 DIN 980	2
304	8546	Seat SIDE Seat panel left	1
305	8547	Decal left yellow	1
306,307		no indications	
308	8550	Seat SIDE Seat panel right	1
309	8551	Decal left yellow	1
310,311		no indications	



Engine SC 490 USA/84

Bild Nr.	EDV Nr..	Description	Type 364
7	8652	Clutch cover	1
8	8653	Ignition case cover	1
161	8631	Shifting drum	1
163	8632	Shifting drum	1
177	8214	Shifting fork AW	2
178	8633	Shifting fork HW XE	1

ENDURO E-gear (look at the explosion design)

246	8617	Main shaft E 14 Z	1
247	8618	5th gear on main shaft HW E 25 Z	1
248	8079	Needle cage K 22x26x10	1
249	8619	Washer 22x28x1	2
250	8235	Securing ring A 21x1,2 DIN 471	5
251	8620	3rd gear on main shaft HW E 20 Z	1
252	8621	4th gear on main shaft HW XE 23 Z	1
253	8310	Washer 21,5x31,5x1	3
254	8313	Needle cage K 25x29x13	2
255	8312	Innering LR 21,5x25x13	2
256	8622	2nd gear on main shaft HW E 17 Z	1
257	8233	Circlip SW 21	1
258	8311	Washer 18x24x1	1
259	8624	Output shaft XE	1
260	8625	2nd gear on output shaft AW E29Z	1
261	8626	Needle cage K 22x26x13	1
262	8627	4th gear on output shaft XE 24 Z	1
263	8628	3rd gear on output shaft E 26 Z	1
264	8629	5th gear on output shaft E 21 Z	1
265	8630	1st gear on output shaft E 33 Z	1
266	8266	Needle cage K 18x22x10	1
267	8243	Washer 18x27x1	2

1st 2.36
2nd 1.71
3rd 1.30
4th 1.04
5th .84



1984

Hinterradfederung 250 und 490

8606 1 Gelenkhebel, vollst. bestehend aus:

1 Hinge lever, cpl.

- 8607 1 Gelenkhebel
- 8608 4 Lagerbuchse
- 7850 2 Kegel-Schmiernippel AM6
- 8609 1 Gelenklager
- 8610 2 Distanzscheibe
- 8611 2 Dichtring
- 1465 1 Gewindestift

- 1 Hinge lever
- 4 Spacer bush
- 2 Nipple
- 1 Hinge bearing
- 2 Spacer washer
- 2 Sealing ring
- 1 Threaded stud

8513 1 Kettenführung, vollst. bestehend aus:

1 Chain guide, cpl.

- 8514 2 Kunststoffplatte für Kettenführung
- 8515 2 Distanzrolle
- 8516 2 Distanzrolle
- 8493 2 Stützblech
- 1937 2 Gleitrolle
- 1580 2 Skt.-Schraube 116x45
- 1732 2 Scheibe B 6,4
- 1690 2 Si.-Mutter NM6

- 2 Plastic plate f. chain guide
- 2 Spacer roller
- 2 Spacer roller
- 2 Support plate
- 2 Sliding roller
- 2 Hexagon screw
- 2 Washer
- 2 Securing nut

8517 1 Hinterrad-Schwinge, vollst. bestehend aus:

1 Rear swing arm, cpl.

- 8510 1 Hinterrad-Schwinge
- 3932 2 Nadelhülse
- 1930 4 Präzisions-O-Ring
- 1931 2 Buchse f. Hinterrad-Schwinge
- 7863 2 Rundstopfen

- 1 Rear swing arm
- 2 Needle housing
- 4 O-ring
- 2 Bush f. swing arm
- 2 Plug

8612 1 Achse für Hinterrad-Schwinge, vollst. bestehend aus:

1 Rear swing arm spindle, cpl.

- 8613 1 Achse f. Hinterrad-Schwinge
- 8614 1 Bundmutter

- 1 Rear swing arm spindle
- 1 Nut

120

- 2 -

7860	1 Federbein Öhrlins Modell 84	1 Rear shock Öhrlins
8553	1 Rahmen SC 250 LC	1 Frame SC 250 LC
8507	1 Rahmen SC 490	1 Frame SC 490
	1 Gabel bestehend aus:	1 Front fork 2 Fork spring
		7619 2 Gabelfeder
8657	1 Vorderradkotflügel	1 Front fender
8519	1 Hinterradkotflügel	1 Rear fender
	1 Lenker (Handle bar)	1 Throttle grip, cpl. 1 Clutch lever, cpl. 1 Hand brake lever, cpl. 1 Set Plastic hand cover left & right 2 Screw
		8521 1 Gasgriff, kpl. 8522 1 Kupplungshebel, kpl. 8523 1 Handbremshebel, kpl. 8552 1 Satz Handschutz li. und re. 8524 2 Flachkopfschraube M5 x 20 DIN 85 1689 2 Sich.-Mutter NM5 DIN 1689
7883	1 Vorderrad	2 Securing nut
		1 Front wheel 1 Front tire 90/80-21" "Metzeler Perfect Cross:
7884	1 Hinterrad	1 Rear wheel 1 Rear tire 140/80/18" "Perfect Cross f. SC490 1 Rear tire 120/90/18" "Perfect Cross f. SC 250 lc 1 Rear sprocket 52 T 1 Rear sprocket 54 T
		7883 1 Reifen 90/80-21" "Metzeler Perfect Cross" 7884 1 Reifen 140/80/18" "Perfect Cross f. SC490 7885 1 Reifen 120/90/18" "Perfect Cross f. SC 250 lc 7886 1 Zahnkranz 52 Z. 7887 1 Zahnkranz 54 Z.



Tank SC 490

8525	1 Tank mit Dekor bestehend aus:	8526 1 Tank 8527 1 Tankdekor, links 8528 1 Tankdekor, rechts	1 Tank with decal 1 Tank 1 Tank decal, left 1 Tank decal, right
8529	1 Tankdeckel, vollst. bestehend aus:	8530 1 Tankdeckel 8531 1 Deckeldichtung	1 Tank cap. cpl. 1 Tank cap 1 Sealing ring for tank cap
8533	1 Tank, vollst. bestehend aus:	8525 1 Tank mit Dekor 8529 1 Tankdeckel, vollst. 6509 1 Benzininhahn 6510 1 O-Ring 8789 2 Linsenschraube B 4, 8x16 2832 2 Benzinschlauch 2 Schlauchklemmring	1 Tank, cpl. 1 Tank with decal 1 Tank cap cpl. 1 Gasoline tap 1 O-ring 2 Screw 1 Gasoline hose 2 clamp
8603	2 Gummitülle f. Tank		2 Rubber cap f. tank
1570	2 Skt.-Schraube M6x25		2 Hexagon screw
1750	2 Scheibe B 6,4		2 Washer
8604	2 Distanzrohr		2 Spacer tube
8535	2 Gummistreifen		2 Rubber strap
		Tank SC 250 Lc	
8555	1 Tank mit Dekor bestehend aus:	8556 1 Tank 8527 1 Tankdekor, links 8528 1 Tankdekor, rechts	1 Tank with decal 1 Tank 1 Tank decal, left 1 Tank decal, right

8557	1 Tank, vollst. bestehend aus:	8555 1 Tank mit Dekor 8529 1 Tankdeckel, vollst. 6509 1 Benzinhahn 6510 1 O-Ring 8789 2 Linsenschraube B 4,8x16 2832 1 Benzinschlauch 2 Schlauchklemmring	Tank, cpl. 1 Tank with decal 1 Tank cap, cpl. 1 Gasoline tap 1 O-ring 2 Screw B 4,8x16 1 Gasoline hose 2 Clamp
8558	1 Skt-Schraube M6x100		1 Hexagon screw
1690	1 Si-Mutter NM6		1 Securing nut NM6
8602	2 Anlagebuchse		2 Washer
8604	2 Distanzrohr		2 Spacer tube
1750	2 Scheibe B 6,4		2 Washer B 6,4
8537	1 Sitzbank, blau		1 Seat, blue
	Wasserkühlung	5 Gummitülle 8581 1 Kühler, links 8582 1 Schutzgitter, links 8583 3 Scheibe R 5,5 DIN 440 A 3738 5 Linsenschraube B 4,8x13 DIN 7981 8584 6 Halteklammer 8585 1 Schutzgitter, rechts 8586 1 Kühler, rechts 8587 1 Skt.-Mutter M6 DIN 557 1750 1 Scheibe A 6,4 DIN 9021	Water cooled 5 Rubber cap 1 Radiator, left 1 Guard for radiator 3 Washer 5 Screw 6 Clamp 1 Guard for radiator, right 1 Radiator, right 1 Hexagon screw 1 Washer A 6,4 DIN 9021



Wasserkühlung

2708	1	Gummischeibe		Water cooled
1525	2	Skt.-Schraube M6x14 DIN 933		1 Rubber washer
1732	4	Scheibe B 6,4 DIN 125		2 Hexagon screw
8588	1	Trägerschiene		4 Washer
8589	1	Protektor links		1 Mounting rail
8590	1	Protektor rechts		1 Protector, left
8593	1	Druckschlauch		1 Protector, right
8594	1	Verbindungsschlauch		1 Pressure tube
6130	14	Schlauchbinder		1 Rubber link tube
8596	1	Wasserpumpenrad		14 Clamp
8597	1	Pumpendeckeldichtung		1 Sprocket for water pump
8598	1	Wasserpumpendeckel		1 gasket
1633	4	Innenskt.-schraube M6x20 DIN 912		1 Cap for water pump
1510	4	Federring B6 DIN 128		4 Hexagon screw
8599	1	Anschlußstutzen		4 Spring ring
8600	1	Winkelstutzen		1 Intake flange
8601	1	O-Ring 17x2		1 Link stud
1633	2	Innenskt.-schraube M6x20 DIN 912		1 O-Ring 17x2
1510	2	Federring B 6 DIN 128		2 Hexagon screw
8605	1	Innenskt.-schraube M5x10 DIN 912		2 Spring ring
1741	1	Scheibe A 5,3 DIN 9021		1 Hexagon screw
3257	1	Gummitülle		1 Washer
5050	4	Linsenschraube M6x16 Din 7985		1 Rubber cap
1564	2	Sechskantschraube M6x10 DIN 933		1 Screw
1750	6	Scheibe B 6,4 DIN 9021		1 Hexagon screw
8662	1	T-Verbindungsstueck		6 Washer
8663	1	V-Verbindungsstueck		1 T-piece
8669	1	Pumpenradwelle		1 V-piece
8670	1	Distanzbuchse		1 Pump sprocket spindle
1865	1	Wellendichting AS 12x22x7		1 Spacer bush
8615	2	Rillenkugellager		1 Sealing ring
8714	1	Kühlerschlauch, links		2 Ball bearing 12x21x5
8715	1	Kühlerschlauch, rechts		1 Condition tube, left
8716	1	Saugerschlauch, links		1 Condition tube, right
8717	1	Saugerschlauch, rechts	WD.	1 Intake tube, left
				1 Intake tube, right



124 - 6 -

8569	1 Kurbelwelle, vollst. SC 250 lc		1 Crankshaft, cpl. SC 250 lc
4089	1 AT-Kurbelwelle SC 250 lc		1 Crankshaft SC 250 lc, part exchange
8664	1 Nadellager 0-2		1 Needle bearing 0-2
8665	1 Nadellager 2-4		1 Needle bearing 2-4
8666	1 Nadellager 4-6		1 Needle bearing 4-6
8571	1 Mutter auf KW		1 Crankshaft nut
8572	1 Zylinder, vollst. SC 250 lc		1 Cylinder, cpl. SC 250 lc
		8573	1 Cylinder
		8505	1 Buchse Ø 67
8574	1 Zylinderkopf SC 250 lc		1 Cylinder head SC 250 lc
8575	1 Zyl.-Kopfdichtung SC 250 lc		1 Cylinder head gasket SC250lc
8577	1 Ansaugstutzen SC 250 lc		1 Intake flange
8576	7 Stiftschraube M 8x40 DIN 835 SC 250 lc		1 Screw
8578	7 Flanschmutter M8		1 Flansch nut
3143	1 Ansaugverbindungsstück SC 250 lc		1 Intake manifold
4144	1 AT-Zylinder SC		1 Cylinder SC 250 lc, part exchange
8506	2 Membranzunge		1 Reed valve tongue
1564	1 Skt.-Schraube M6x10		1 Hexagon screw
407	1 Flachdichtring A6x10		1 Flat sealing ring

- 7 -

	Auspuff SC 250 lc	Exhaust system SC 250 lc
8564	1 Auspuffanlage, vollst. bestehend aus:	1 Exhaust system, cpl. 1 Exhaust system welded 1 Silencer, cpl.
		8565 1 Auspuff, geschw. 8360 1 Schalldämpfer, vollst.
	1 Kurbelgehäuse SC 250 lc	1 Crankcase SC 250 lc
8566	1 Kupplungsdeckel	1 Crankcase cover, left
8568	1 Lima-Deckel, rot	1 Ignition cover, red
	Zubehör	
8544	1 Kette 116 Glieder	1 Rear chain 116 links
8559	1 Typschild	1 Type plate
1567	2 Skt.-Schraube M6x16	2 Hexagon screw
1750	4 Scheibe A 6,4	4 Washer
1690	2 Si.-Mutter NM6	2 Securing nut

- 8 -



126

- 8 -

8545

Seitennummernschild links, vollst.

bestehend aus:

- 8546 1 Seitennummernschild, links
- 8547 1 Abziehfolie, links

Side panel left, cpl.

- 1 Side panel left
- 1 Sticker left

8549

Seitennummernschild rechts, vollst.

bestehend aus:

- 8550 1 Seitennummernschild, rechts
- 8551 1 Abziehfolie, rechts

Side panel right, cpl.

- 1 Side panel right
- 1 Sticker right



- 9 -

Getriebe		Gear - MX	
8635	1 Getriebehauptwelle (X)	1	Mainshaft (X) 16T
8636	1 Klauenlosrad 5.Gg.HW(X)	1	5th Gear on mainshaft HW "X" 25T
8079	1 Nadelkranz K 22x26x10	1	Needle bearing
8619	1 Scheibe	1	Washer
8235	2 Sicherungsring A 21x1,2 DIN 471	2	Securing ring
8637	1 Klauenrad 3.Gg.HW (X)	1	3rd Gear on mainshaft (X) 21T
8621	1 Losrad 4.Gg.HW (X,E)	1	4th Gear on mainshaft (X,E)
8312	1 Innenring	1	Inner ring
8313	1 Nadelkranz K 25x29x13	1	Needle bearing
8310	1 Scheibe	1	Washer
8638	1 Zahnrad 2.Gg. HW X	1	2nd Gear on mainshaft
8233	1 Sprengring SW 21	1	Circlip
8311	1 Scheibe 18x24x1	1	Washer
8126	1 Rillenkugellager 6204 ZC3 DIN 625	1	Ball bearing
8247	1 Außenring m. Nadelkranz RNA0 18x26x13	1	Needle bearing
8253	1 Paßscheibe PS 18x25x1 DIN 988	1	Washer
8624	1 Abtriebswelle (X,E)	1	Out put shaft (X,E)
8640	1 Losrad 2.Gg. AW (X)	1	2nd Gear on out put shaft
8626	1 Nadelkranz K 22x26x13	1	Needle bearing
8619	1 Scheibe 22x28x1	1	Washer
8235	3 Sicherungsring	3	Securing ring
8627	1 Klauenrad 4.Gg. AW (X,E)	1	4th Gear on out put shaft (X,E)
8641	1 Klauenlosrad 3.Gg. AW (X)	1	3rd Gear on out put shaft (X)

127

- 10 -

8312	1 Innenring
8313	1 Nadelkranz K 25x29x13
8310	2 Scheibe
8642	1 Klauenrad 5.Gg. AW (X)
8643	1 Losrad 1.Gg. AW (X)
8266	1 Nadelkranz K 18x22x10
8243	1 Anlaufscheibe 1.Gg.
8644	1 Anlaufscheibe 1 Gg.
8247	1 Außenring m. Nadelkranz RNA0 18x26x13
8121	1 Rillenkugellager 2-reihig 3205 2RS C3
8248	1 Distanzrohr a. AW
8250	1 Kettenrad 13 Z
8251	1 Kettenrad 14 Z
8252	1 Kettenrad 15 Z
8263	1 Kettenrad 16 Z
6305	1 Sicherungsring I 52x2 DIN 472
1879	1 Sicherungsring A 25x1,2 DIN 471

