

MAICO



MAGNUM

**Get Serious.
Move up to the
Maico Magnum
250 400 450**

Technical data, owners manual

**NAMES ARE MADE ON
MAICO**

MAICO MAGNUM
OWNERS MANUAL

I. PREFACE:

This short instruction manual covers the most important information for proper maintenance and successful use of the following MAICO models:

MAICO 250 MAGNUM, MAICO 400 MAGNUM, MAICO 450 MAGNUM.

The chassis and engine of the Magnums have been newly designed in order to meet the latest requirements of the Moto-Cross and Cross-Country sport.

Due to constant developments of these machines. MAICO reserves the right to change details and/or data.

II. TECHNICAL INFORMATION:

	MAGNUM 250	MAGNUM 400	MAGNUM 450
Engine	Air cooled two stroke with loop scavenging.		
Displacement	247 ccm	386 ccm	438 ccm
Bore & Stroke	67 x 70 mm	77 x 83 mm	82 x 83 mm
Horsepower (DIN)	38 hp 27.2 KW 7600 rpm	44 hp 32.4 KW 6600 rpm	48 hp 35.3 KW 6600 rpm
Fuel	High octane with oil mix.		
Oil mixture	Oil: Fuel = 1 : 20-25 (Two stroke oil) = 1 : 20-25 MC3 Bel-Ray = 1 : 40-50 MC1 Bel-Ray = 1 : 100 MAICO MC-GP-100 mix oil		
Ignition timing (BTDC)	1.9-2.1 mm	2.3-2.5 mm	2.3-2.5 mm
Spark plug	Champion N2; N84G; NGK B9ES; Champion N59G		
Ignition	Pointless electronic (CDI) ignition. Motoplat.		
Transmission	Dog shifting 5 speed transmission with moved back driven drive shaft.		
Gear lube	600 cc SAE 20 W 50 (HD)		
Carburetor	Bing carburetor : V54/II		
Jetting	Pilot jet - 75 Jet needle - 361 (Pos. middle) (No: 1) Needle jet - 326 Main jet - 170 Slide - 140 1		

II. TECHNICAL INFORMATION:

	MAGNUM 250	MAGNUM 400	MAGNUM 450
Front suspension	Maico telescopic air forks. Front wheel travel 254 mm (10")		
Rear suspension	Pressurized reservoir gas shocks. Progressive spring. Rear wheel travel 254 mm (10")		
Tank	Round shaped aluminum tank. Capacity 9.3 lit. (2.46 Gal)		

III. TORQUE SPECIFICATIONS:

1. Crankshaft sprocket nut:	SW 32	M25x1.5	20 kpm	144 ft.lb.
2. Clutch nut(on Mainshaft):	SW 17	M12x1.5	7 kpm	50 ft.lb.
3. Magneto nut (Left handed thread):	SW 17	M12x1 L	7 kpm	50 ft.lb.
4. Cylinder head studs:		M10	2.5 kpm	18 ft.lb.
5. Cylinder head nuts:	SW 13	M8	2.5 kpm	18 ft.lb.
6. Cylinder base studs:		M8	2 kpm	14 ft.lb.
7. Cylinder base nuts:	SW 13	M8	2-2.5 kpm	14-18 ft.lb.
8. Locking bolts: (For detent and shifting cam guide.)	SW 19	M14x1.5	2.5-3.0 kpm	18-22 ft.lb.
9. Crankcase and Clutch cover screws (not applied on Mag cover screws).		M6	0.9 kpm	6.5 ft.lb.
10. Engine mounting bolts:	SW 13	M8	2.5 kpm	18 ft.lb.
11. Head stay bolts	SW 13	M8	2.5 kpm	18 ft.lb.
12. Front axle:		M14x1.5	4.0 kpm	29 ft.lb.
13. Swing arm axle:	SW 22	M14x1.5	6.5 kpm	47 ft.lb.
14. Rear axle:	SW 24	M16x1.5	7.5 kpm	54 ft.lb.
15. Fork slider studs:		M8	1.5 kpm	11 ft.lb.
16. Nut on the fork slider studs:	SW 13	M8	1.8 kpm	13 ft.lb.
17. Damper cone:		M48x1.5	7.5 kpm	54 ft.lb.
18. Damper tube holding bolt:		M8	2.0 kpm	14 ft.lb.
19. Fork tube pinch bolts:		M10	4.0-4.5 kpm	29-32.5ft.lb.
20. Hexagon nut for steering tube:		M27x1	Adjust without tension.	
21. Brake stopper arm bolt front:	SW 13	M8	2.0 kpm	14 ft.lb.
22. Brake stopper arm bolt rear:	SW 17	M10	4.0 kpm	29 ft.lb.
	SW 13	M8	2-2.5 kpm	14-18 ft.lb.

CARBURETOR ADJUSTMENT:

The best performance and engine output depends on fine adjustment of the carburetor for various working conditions such as altitude and temperature. Improper adjustment of the carburetor causes the engine to perform below its actual output.

Pilot jet: Functions up to approximately 25% slide opening.
Fine adjustment through air regulating screw (small screw).

Pilot System:

- Functions when throttle slide closed. The throttle slide stop screw (idling screw) adjusts idling rpm - approximately 1000 rpm. Clean idling is regulated with air regulating screw (small screw). Turning the screw further in gives a richer idling mixture; turning the screw further out gives a leaner idling mixture. When bike is in motion with throttle slide closed and engine idles too fast (lean mixture), use the next larger pilot jet.

Midrange:

-Functions with throttle slide partially open. Adjustments are made with needle jet and needle position. Adjustment is influenced by pilot system for bottom end, and by the main jet for top end. If mixture is too rich during acceleration, the needle should be lowered. When engine pings (metallic knocking) during acceleration, the needle should be raised. If lowering or raising of needle is not sufficient, install smaller or larger needle jet.

Midrange During Acceleration:

- Functions from idling to throttle wide open. During acceleration, engine output should increase steadily. If power comes on unevenly, or all of a sudden at high rpm, or engine smokes, pilot system or needle jet system is too rich. When engine pings during acceleration, the needle should be raised. If raising of needle is not sufficient, use larger needle jet.

Top End:

- Throttle slide wide open. When engine pings in wide open position (spark plug white), use larger main jet. Installation of larger main jet requires also larger needle jet, so that fuel flow is not restricted by needle jet. If engine runs too rich (spark plug dark), use smaller main jet.

IMPORTANT:

In order to prevent engine seizures, always start with larger jets first, then try next smaller size.

At temperatures below 10⁰c (50⁰F) or low altitudes (0 - 300 feet above sea level), use one or two sizes larger main jet (160-165-170-175). At high temperatures or high altitudes, use smaller main jets.



Needle jet: Functions at midrange, 15% to 80% slide opening.
Fine adjustment through jet needle (3 positions).

Main jet: Functions between 50% and 100% slide opening.

Adjustment of the Carburetor:

All adjustments should be made only on a warmed up engine. Always change one component only, then test ride again. The basic carburetor jetting is valid for 1200 feet above sea level and temperatures between 18^oc - 25^oc (64^o-77^oF).



V. Telescopic Fork:

Telescopic fork with 38 \emptyset mm fork tubes, aluminum fork sliders with 2 seals and removeable guide bush. Front wheel travel 254mm, progressively operating dampening unit with linear wound springs (marked green). Linear wound spring is assisted by compressed air: (1 atu - 14 psi).

Oil capacity of 360-370ccm per leg. Bel-Ray LT 100-LT 200 - HL 25 or AFT oil (SAE 10).

(Proper oil level should be measured 16cm from upper edge of the fork tube. Measurement should be made without spring - fork should be compressed fully.)

Oil capacity and air pressure can be varied depending on body weight and track conditions. (\pm 20cc oil volume; \pm 0.2 atu (2.8 psi) air pressure.)

Not much	Oil	smoother fork	Less	Air-pressure	smoother fork
Much		harder fork	Much		harder fork

VI. Set-up, Maintenance and Care:

a) Jobs before starting engine:

- Transmission - check oil level.
- Clutch play should be checked (2-3mm on clutch lever).
- Tighten spark plug and check spark plug cap.
- Check carburetor flange for tightness. (Do not overtighten as it will cause the rubber flange to break.)
- Check throttle for throttle slide, return to idling position.
- Check air filter to see if it's oiled, -never let it dry.
- Check chain slack - Slack min. \pm 20mm; Slack max. \pm 35mm. (When lifting the chain up, chain should touch the upper chain guide bush.)
- Adjust brakes.

b) Service after 1 hour:

- Retighten cylinder head - cold cylinder (see torque specifications).
- Retighten the engine mounting bolts - (see torque specifications).
- Retighten mag nut and check timing (see torque specifications).
- Check engine for oil leakages and check oil level.
- Axle nuts (rear, front, swing arm) should be retightened (see torque specifications).
- Check all bolts and nuts for tightness.
- Check the spokes (front & rear), tighten if necessary.
- Adjust the chain play and lube chain. (Check chain slack and alignment.)
- Steering head play should be checked and retightened if necessary. (See torque specifications.)
- Change fork oil. Clean wipers and grease.
- Change or clean air filter and soak with oil.

c) Maintenance and Service:

- Ignition: Check timing every 5 races. (See technical information.)

CAUTION: Ignition box must always be grounded to the frame, solid mounting, without silent block and ground wires.

Never kick or turn engine with disconnected spark plug cap. Spark plug must always be grounded. (Ignition will be destroyed if electrical circuit is incomplete.)

Never pull spark plug cap when engine runs!!! When ignition is defective - always exchange both stator and rotor together - otherwise, timing marks will not match.

- Transmission: Check oil level every run - change oil every three races. Check clutch for function - if necessary, change clutch springs (if clutch slips).

CAUTION: Do not use hammer on clutch lock washer tool to secure the clutch lock washer on Magnum engines. Bend lock washer carefully with tool by applying 2-way puller. In order to avoid damage of the clutch bearing holding plate, never hit the clutch bearing.

- Primary chain and magnet oil drain plug should be checked every 3 races. If there are excessive metal chips on drain plug, find cause and replace defective parts.

Air Filter:

Before each race, air filter should be checked, cleaned and oiled.

Forks:

Fork oil should be changed every 5 races. Steering play should be checked and tightened if necessary.

CAUTION: When installing or removing the front wheel, fork sliders should be free of tension. First tighten axle and then tighten the fork slider pinch bolts.

Swing Arm:

Grease the swing arm bearing every 10 races.

Wheels:

Before each race, spokes should be checked and retightened or replaced if necessary.

Chain:

After every race, chain should be cleaned and checked for wear. Check chain for proper slack.

Cables:

Cables should be lubricated with cable lube. Levers should be oiled also. It is very important to replace damaged cables.

Brakes:

Adjust the brakes if necessary and check brake shoes on and off.

Printed in West-Germany

MAICO

FAHRZEUGFABRIK G. m. b. H.
7403 Ammerbuch 2 - Pfäffingen

MAICO

1978 SPARE PARTS CATALOGUE

MODEL : Magnum

CHASSIS TYPE :	MC 250/T	Type 336	Engine Type 336
	MC 400/T	Type 337	Engine Type 337
	MC 440/T	Type 338	Engine Type 338

CHASSIS DESCRIPTION:

New red frame with stronger steering head and stronger engine mount - New swing-arm - Corte Cosso reservoir gas shocks - 360mm long - Front wheel and rear wheel travel 254mm - Round shape aluminum tank High pipe with new silencer. Air forks with 38mm fork tubes. New number panels, fenders - Gold color rims.

ENGINE DESCRIPTION:

New engine with moved back countershaft sprocket - Swing arm pivot pin through the engine cases - 4 Engine mountings. High performance cylinder with centrally located combustion chamber cylinder head with one spark plug - Motoplat ignition - New location for the shifting mechanism.

COLOR : RED

FRAME IDENTIFICATION:

Stamped on the steering head
First 3 numbers: 336 0000

ENGINE TYPE IDENTIFICATION:

Stamped on the left side of the Engine case.

First 3 numbers
*RT : 336 0000
*MT : 337 0000

*Transmission code.

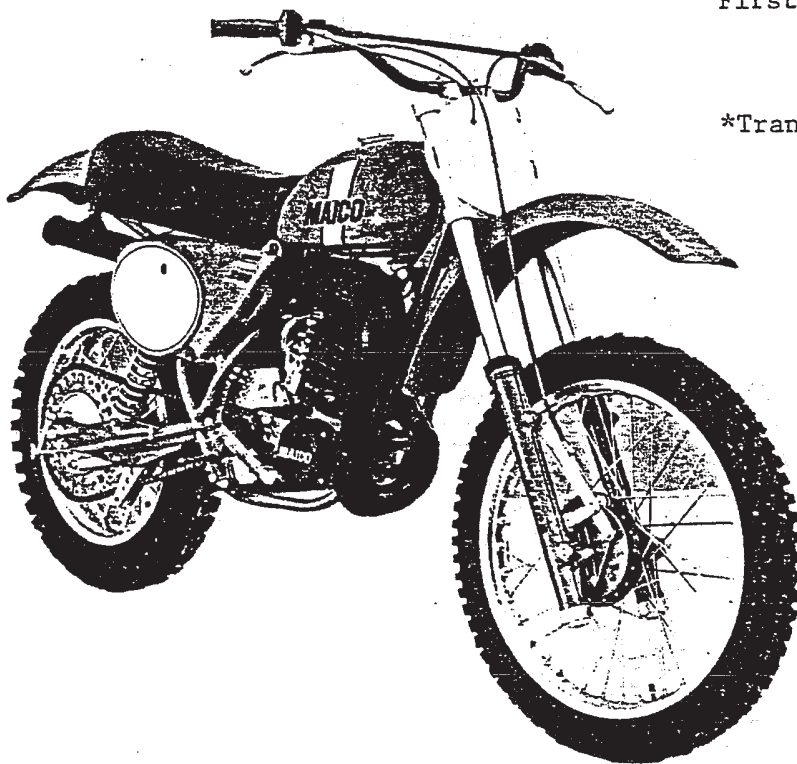

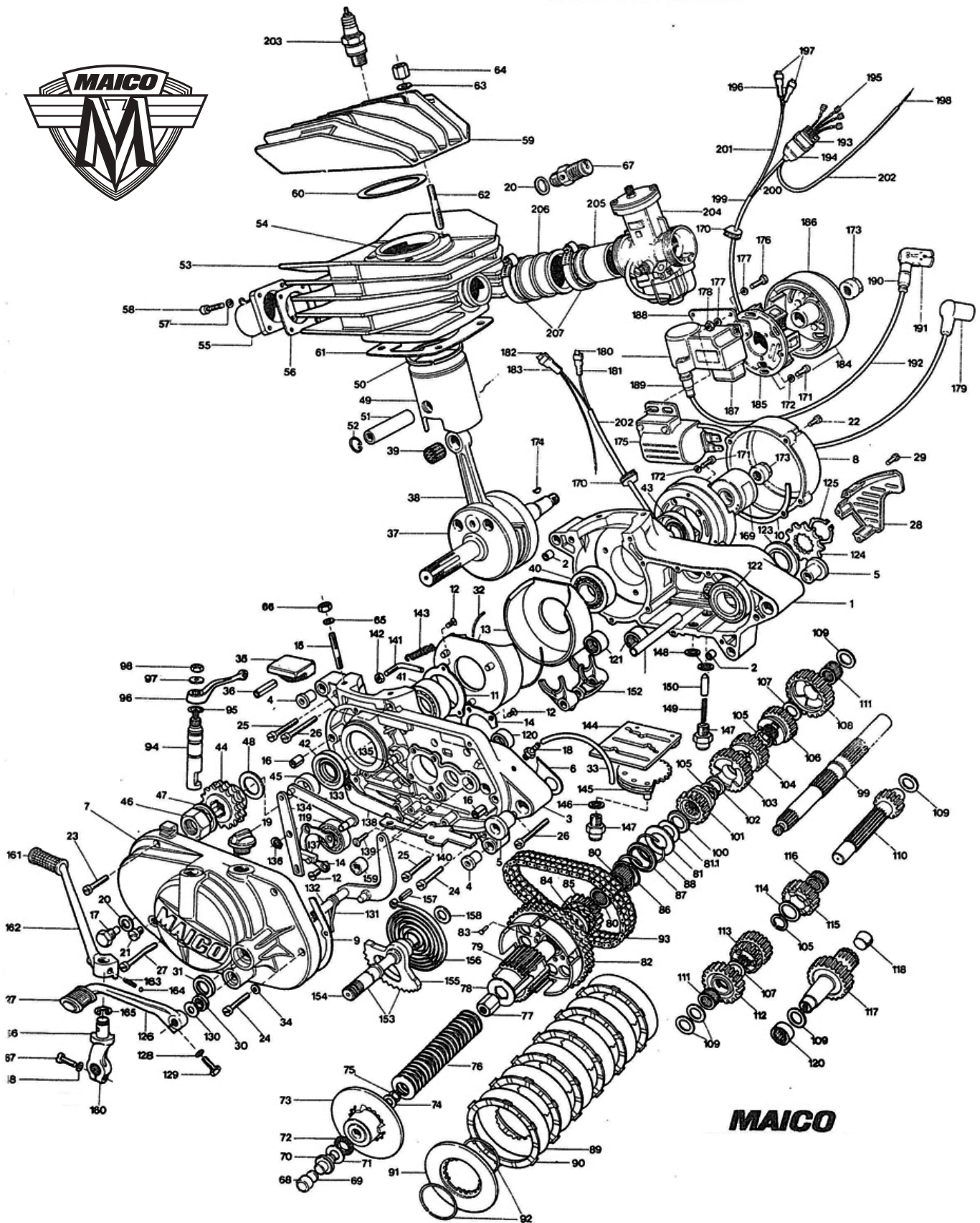

Picture No.	Part No.	Description	MC 250	MC 400	MC 440	GS 250	GS 400	GS 440
1	1998	Crankcase right hand	1	1	-	1	1	-
	1982	Crankcase right hand	-	-	1	-	-	1
2	1997	Internal ring	2	2	2	2	2	2
3	1996	Crankcase left hand	1	1	-	1	1	-
	1979	Crankcase left hand	-	-	1	-	-	1
4	1995	Emgine mounting bushes	6	6	6	6	6	6
5	1994	Spacer bush for swing arm	2	2	2	2	2	2
6	1993	Crankcase gasket	1	1	1	1	1	1
7	1992	Crankcase cover	1	1	1	1	1	1
8	1991	Ignition cover	1	1	1	1	1	1
9	1990	Crankcase cover gasket left hand	1	1	1	1	1	1
10	1989	Crankcase cover gasker right hand	1	1	1	1	1	1
11	1988	Main bearing cover plate	1	1	1	1	1	1
12	1795	Counter sunk screw M 5x8 Din 965	11	11	11	11	11	11
13	1987	Crankshaft housing	2	-	-	2	-	-
14	1986	MS bearing cover plate	2	2	2	2	2	2
15	1787	Stud screw M 8x28 Din 940	4	4	4	4	4	4
16	1831	Tension pin 8x10 Din 7346	2	2	2	2	2	2
17	400	Oil drain plug	1	1	1	1	1	1
18	1985	Breather	1	1	1	1	1	1
19	1984	Oil filling plug	1	1	1	1	1	1
20	410	Spacer ring	1	2	2	1	2	2
21	1526	Cylinder head screw M 8x10 Din 84	1	1	1	1	1	1
22	1536	Cylinder head screw M 6x25 Din 84	4	4	4	4	4	4
23	1550	Cylinder head screw M 6x30 Din 84	3	3	3	3	3	3
24	1538	Cylinder head screw M 6x35 Din 84	5	5	5	5	5	5
25	1539	Cylinder head screw M 6x40 Din 84	6	6	6	6	6	6
26	1541	Cylinder head screw M 6x50 Din 84	2	2	2	2	2	2
27	1542	Cylinder head screw M 6x55 Din 84	2	2	2	2	2	2
28	1983	Counter sprocket cover	1	1	1	1	1	1
29	1533	Cylinder head screw M 6x18 Din 84	3	3	3	3	3	3
30	1865	Sealing ring AS 12x22x7 Din 3760	1	1	1	1	1	1
31	1866	Sealing ring A 18x28x7	1	1	1	1	1	1
32	1313	Sprint rubber	X	-	-	X	-	-
33	263	Breather tube	X	X	X	X	X	X
34	407	Flat washer A 6x10 Din 7603	2	2	2	2	2	2
35	2133	Sliding piece	1	1	1	1	1	1
36	1835	Tension pin 8x36 Din 1481	1	1	1	1	1	1
37	3225	Crankcase cpl	1	-	-	1	-	-
	3258	Crankcase cpl	-	1	1	-	1	1
	4131	Crankshaft part exchange	1	-	-	1	-	-
	4132	Crankshaft part exchange	-	1	1	-	1	1

Picture No.	Part No.	Description	MC 250	MC 400	MC 440	GS 250	GS 400	GS 440
38	4163	Connecting rod cpl	1	1	-	1	1	-
	4162	Connecting rod cpl	-	1	1	-	1	1
39	424	Needle bearing Red 0-2						
		Needle bearing Blue 2-4	1	1	1	1	1	1
		Needle bearing White 4-6						
40	426	Roller bearing NU 305 C3 Din 628	1	1	1	1	1	1
41	693	Ball bearing 3305 C3 Din 628	1	1	1	1	1	1
42	547	Sealing ring	1	1	1	1	1	1
43	3469	Sealing ring	1	1	1	1	1	1
44	3220	Duplex sprocket	1	-	-	-	-	-
	714	Triplex sprocket	-	1	1	1	1	1
45	713	Spacer	-	1	1	1	1	1
46	3240	Guide nut on crankshaft	1	1	1	1	1	1
47	3254	Securing plate	1	1	1	1	1	1
48	862	Washer 0.2 thick	When needed					
	3111	Washer 0.3 thick	When needed					
49	522	Piston std. 66.95	1	-	-	1	-	-
	2059	Piston 1st oversize 67.10	1	-	-	1	-	-
	2060	Piston 2nd oversize 67.25	1	-	-	1	-	-
	2061	Piston 3rd oversize 67.40	1	-	-	1	-	-
	532	Piston std. 76.93	-	1	-	-	1	-
	2069	Piston 1st oversize 77.08	-	1	-	-	1	-
	2070	Piston 2nd oversize 77.23	-	1	-	-	1	-
	2071	Piston 3rd oversize 77.38	-	1	-	-	1	-
	2072	Piston 4th oversize 77.53	-	1	-	-	1	-
	2110	Piston std. 81.92	-	-	1	-	-	1
	2112	Piston 1st oversize 82.07	-	-	1	-	-	1
	2114	Piston 2nd oversize 82.22	-	-	1	-	-	1
	2116	Piston 3rd oversize 82.37	-	-	1	-	-	1
	2118	Piston 4th oversize 82.52	-	-	1	-	-	1
50	523	Piston ring std. 67.00	1	-	-	1	-	-
	2064	Piston ring 1st oversize 67.15	1	-	-	1	-	-
	2065	Piston ring 2nd oversize 67.30	1	-	-	1	-	-
	2066	Piston ring 3rd oversize 67.45	1	-	-	1	-	-
	534	Piston ring std. LD 77.00	-	1	-	-	1	-
	2076	Piston ring 1st oversize 77.15	-	1	-	-	1	-
	2277	Piston ring 2nd oversize 77.30	-	1	-	-	1	-
	2078	Piston ring 3rd oversize 77.45	-	1	-	-	1	-
	2079	Piston ring 4th oversize 77.60	-	1	-	-	1	-
	2111	Piston ring LD Std. 82.22	-	-	1	-	-	1
	2113	Piston ring 1st oversize 82.151	-	-	1	-	-	1
	2115	Piston ring 2nd oversize 82.30	-	-	1	-	-	1
	2117	Piston ring 3rd oversize 82.45	-	-	1	-	-	1
	2119	Piston ring 4th oversize 82.60	-	-	1	-	-	1

Picture No.	Part No.	Description	MC 250	MC 400	MC 440	GS 250	GS 400	GS 440
51	535	Piston pin	1	-	-	1	-	-
	537	Piston pin	-	1	1	-	1	1
52	536	Circlip	2	2	2	2	2	2
53	2154	Radial cylinder cpl MC	1	-	-	-	-	-
	2157	Radial cylinder cpl MC	-	1	-	-	-	-
	2161	Radial cylinder cpl MC	-	-	1	-	-	-
	5698	Radial cylinder cpl GS	-	-	-	1	-	-
	5715	Radial cylinder cpl GS	-	-	-	-	1	-
	5725	Radial cylinder cpl GS	-	-	-	-	-	1
	4135	Cylinder part-exchange	1	-	-	1	-	-
	4136	Cylinder part-exchange	-	1	-	-	1	-
	4137	Cylinder part-exchange	-	-	1	-	-	1
54	5038	Cylinder liner	1	-	-	1	-	-
	2159	Cylinder liner	-	1	-	-	1	-
	2163	Cylinder liner	-	-	1	-	-	1
55	467	Exhaust flange MC	1	1	1	-	-	-
	5699	Exhaust flange GS 0 20	-	-	-	1	-	-
	5716	Exhaust flange GS 0 24	-	-	-	-	1	1
56	298	Gasket for exhaust flange	1	1	1	1	1	1
57	1704	Spring ring B 6 Din 127	4	4	4	4	4	4
58	1635	Socket screw M 6x25 Din 912	4	4	4	4	4	4
59	2156	Cylinder head Radial	1	-	-	1	-	-
	2160	Cylinder head Radial	-	1	-	-	1	-
	2164	Cylinder head Radial	-	-	1	-	-	1
60	65	Cylinder head gasket	1	-	-	1	-	-
	720	Cylinder head gasket	-	1	-	-	1	-
	2582	Cylinder head gasket	-	-	1	-	-	1
61	3004	Cylinder head gasket 0.3 thick						
	721	Cylinder head gasket 0.5 thick						
	2237	Cylinder head gasket 0.7 thick						
62	2967	Cylinder head stud	5	-	-	5	-	-
	2968	Cylinder head stud	-	5	5	-	5	5
63	1734	Washer B 8.4 Din 125	5	5	5	5	5	5
64	78	Hexagon nut	5	5	5	5	5	5
65	1714	Spring washer B 8 Din 137	4	4	4	4	4	4
66	1670	Hexagon nut M 8 Din 934	4	4	4	4	4	4
67	517	Decompression valve cpl	-	1	1	-	1	1
68	2251	Push pin cap	1	1	1	1	1	1
69	2252	Spacer 1.5 thick						
	2253	Spacer 2.0 thick						
	2254	Spacer 2.4 thick						
	2255	Spacer 2.8 thick						
	2256	Spacer 3.2 thick						
	2257	Spacer 1.75 thick						

Picture No.	Part No.	Description	MC 250	MC 400	MC 440	GS 250	GS 400	GS 440
70	2889	Push pin	1	1	1	1	1	1
71	1096	Bearing plate	1	1	1	1	1	1
72	1084	Needle cage	1	1	1	1	1	1
73	2886	Guide for clutch disc	1	1	1	1	1	1
74	2890	Washer 10.1x18.2x0.6	1	1	1	1	1	1
75	1842	Securing ring	1	1	1	1	1	1
76	449	Cup spring	20	20	20	20	20	20
77	448	Guide nut	1	1	1	1	1	1
78	447	Lock plate for guide nut	1	1	1	1	1	1
79	2580	Clutch body	1	1	1	1	1	1
80	736	Needle cage	2	2	2	2	2	2
81	444	Thrust washer	1	1	1	1	1	1
81.1	1884	Spacer washer 17x25x0.2	When needed					
	3432	Spacer washer 17x25x0.3	When needed					
82	2895	Clutch housing with kickstarter ratchet wheel	1	-	-	-	-	-
	2944	Clutch housing with kickstarter ratchet wheel	-	1	1	1	1	1
83	1906	Oval head rivet	8	8	8	8	8	8
84	729	Kickstarter ratchet wheel	1	1	1	1	1	1
85	730	Kickstarter pinion	1	1	1	1	1	1
86	731	Ratchet spring	1	1	1	1	1	1
87	732	Spring cup	1	1	1	1	1	1
88	733	Spring ring	1	1	1	1	1	1
89	3390	Inner disc	6	6	6	6	6	6
90	3396	Clutch disc	6	6	6	6	6	6
91	3391	Terminal disc	1	1	1	1	1	1
92	461	Circlip	2	2	2	2	2	2
93	2899	Duplex-chain	1	-	-	1	-	-
	2947	Triplex-chain	-	1	1	-	1	1
94	462	Clutch spindle	1	1	1	1	1	1
95	464	Sealing ring for clutch spindle	1	1	1	1	1	1
96	2898	Clutch lever	1	1	1	1	1	1
97	1732	Washer B 6.4 Din 125	1	1	1	1	1	1
98	1690	Hexagon nut NM 6 Din 980	1	1	1	1	1	1
99	2025	Main shaft	1	1	1	1	1	1
100	2043	M S shim	1	1	1	1	1	1
101	3441	1st gear pinion on mainshaft 19 teeth	1	-	-	-	-	-
	3449	1st gear pinion on mainshaft 17 teeth	-	1	1	1	1	1
102	3706	Spacer ring	1	1	1	1	1	1
103	3435	4th gear pinion on mainshaft 26 teeth	1	1	1	1	1	1
104	3434	3th gear pinion on mainshaft 24 teeth	1	-	-	-	-	-
	3967	3th gear pinion on mainshaft 23 teeth	-	1	1	-	-	-
	3443	3th gear pinion on mainshaft 23 teeth	-	-	-	1	1	1

Picture No.	Part No.	Description	MC 250	MC 400	MC 440	GS 250	GS 400	GS 440
105	492	Retainer ring	3	3	3	3	3	3
106	3440	2nd gear pinion on mainshaft 21 teeth	1	-	-	-	-	-
	3448	2nd gear pinion on mainshaft 20 teeth	-	1	1	1	1	1
107	3723	Shim for 1st gear	2	2	2	2	2	2
108	2039	5th gear pinion on mainshaft 28 teeth	1	1	1	-	-	-
	2049	5th gear pinion on mainshaft 29 teeth	-	-	-	1	1	1
109	3893	Spacer washer	5	5	5	5	5	5
110	3437	Layshaft	1	1	1	-	-	-
	3445	Layshaft	-	-	-	1	1	1
111	913	Needle cage K 16x21x10	2	2	2	2	2	2
112	3438	1st gear pinion on layshaft 26 teeth	1	-	-	-	-	-
	3446	1st gear pinion on layshaft 28 teeth	-	1	1	1	1	1
113	3442	Twin block pinion on layshaft 19/21 teeth	1	1	1	-	-	-
	3450	Twin block pinion on layshaft 18/21 teeth	-	-	-	1	1	1
114	3456	Shim for 2nd gear	1	1	1	1	1	1
115	3439	2nd gear pinion on layshaft 23 teeth	1	-	-	-	-	-
	3447	2nd gear pinion on layshaft 24 teeth	-	1	1	1	1	1
116	3757	Needle cage K 20x24x12	1	1	1	1	1	1
117	2037	Drive shaft 28 teeth	1	1	1	-	-	-
	2048	Drive shaft 29 teeth	-	-	-	1	1	1
118	2038	Plug	1	1	1	1	1	1
119	339	Ball bearing 6303 CS Din 625	1	1	1	1	1	1
120	513	Needle bearing HK 1612	2	2	2	2	2	2
121	514	Needle bearing BK 1616	2	2	2	2	2	2
122	375	Ball bearing 6206 2RS C3 Din 625	1	1	1	1	1	1
123	2044	Spacer ring	1	1	1	1	1	1
124	3465	Sprocket 13 teeth	1	1	1	-	-	-
	3720	Sprocket 14 teeth	-	-	-	1	1	1
125	1848	Lock ring 29x1.5 Din 471	1	1	1	1	1	1
126	2327	Gear change lever	1	1	1	1	1	1
127	556	Rubber pad	1	1	1	1	1	1
128	1570	Hexagon screw M 6x25 Din 933	1	1	1	1	1	1
129	1712	Spring washer B 6 Din 137	1	1	1	1	1	1
130	2324	Washer 12.1x26.2x1	1	1	1	1	1	1
131	573	Return spring	1	1	1	1	1	1
132	2503	Gear change crank	1	1	1	1	1	1
133	2336	Pullrod	1	1	1	1	1	1
134	2374	Pullrod pivot arm	1	1	1	1	1	1
135	1903	Pivot arm A 8x20 Din 1469	1	1	1	1	1	1
136	1836	Securing ring 8x0.8 Din 471	1	1	1	1	1	1
137	2376	Hooked ratchet sliding arm	1	1	1	1	1	1
138	2375	Guide plate	1	1	1	1	1	1

Picture No.	Part No.	Description	MC 250	MC 400	MC 440	GS 250	GS 400	GS 440
139	1795	Countersunk screw 5x8 Din 965	2	2	2	2	2	2
140	3326	Hooked ratchet "T"	1	1	1	1	1	1
141	2388	Hook	1	1	1	1	1	1
142	1667	Hexagon nut M 6 Din 934	1	1	1	1	1	1
143	576	Tension spring for hooked ratchet	1	1	1	1	1	1
144	3406	Shifting plate cpl	1	1	1	1	1	1
145	3402	Shifting segment	1	1	1	1	1	1
146	2397	Shim 10.6x18.2x1	1	1	1	1	1	1
147	2393	Guide screw	2	2	2	2	2	2
148	410	Sealing ring A 14x18	2	2	2	2	2	2
149	2395	Tension spring	1	1	1	1	1	1
150	2396	Pawl pin	1	1	1	1	1	1
151	2399	Gear selection fork spindle	1	1	1	1	1	1
152	3414	Gear selection fork	3	3	3	3	3	3
153	2566	Kickstarter spindle cpl	1	1	1	1	1	1
154	2559	Kickstarter spindle	1	1	1	1	1	1
155	761	Kickstarter Quadrant	1	1	1	1	1	1
156	666	Return spring	1	1	1	1	1	1
157	1828	Tension bush 5x26 Din 1481	1	1	1	1	1	1
158	1753	Shim 12.2x30.2x0.5	1	1	1	1	1	1
159	3353	Internal ring	1	1	1	1	1	1
160	5035	Kickstarter lever cpl	1	1	1	1	1	1
161	656	Rubber pad	1	1	1	1	1	1
162	5033	Kickstarter lever	1	1	1	1	1	1
163	3867	Compress spring for kickstarter	1	1	1	1	1	1
164	1874	Ball 0 7	1	1	1	1	1	1
165	1840	Lock washer RS	1	1	1	1	1	1
166	5034	Kickstarter joint	1	1	1	1	1	1
167	1570	Hexagon screw M 6x25 Din 933	1	1	1	1	1	1
168	1704	Spring ring B 6	1	1	1	1	1	1
169	3598	Motoplat Ignition cpl	1	1	1	-	-	-
170	3530	Rubber sleeve	1	1	1	1	1	1
171	1630	Socket screw M 5x16 Din 912	3	3	3	4	4	4
172	1731	Shim B 5.3 Din 125	1	1	1	1	1	1
173	1123	Nut for generator	1	1	1	1	1	1
174	1881	Woodruff key 3x3.7 Din 6888	1	1	1	1	1	1
175	3600	Ignition coil Motoplat	1	1	1	-	-	-
176	1567	Hexagon screw M 6x16 Din 933	2	2	2	4	4	4
177	1732	Shim B 6.4 Din 125	4	4	4	8	8	8
178	1690	Hexagon nut NM 6 Din 980	2	2	2	4	4	4
179	3610	Cable plug	1	1	1	-	-	-
180	3576	Connector 6,3-1 Din 46247	1	1	1	-	-	-
181	3596	Connector housing 6,3	1	1	1	-	-	-
182	3595	Connector 9,5-6 Din 46247	1	1	1	-	-	-

Picture No.	Part No.	Description	MC 250	MC 400	MC 440	GS 250	GS 400	GS 440
183	3597	Connector housing 9,5	1	1	1	-	-	-
184	5396	Bosch Elektronik MHKZ	-	-	-	1	1	1
185	5397	Stator	-	-	-	1	1	1
186	5398	Rotor	-	-	-	1	1	1
187	5399	Electronic box	-	-	-	1	1	1
188	5404	Support for Electronic box	-	-	-	1	1	1
189	3884	Cable plug water proof	-	-	-	1	1	1
190	600	Cable plug water proof	-	-	-	1	1	1
191	1126	Cable plug	-	-	-	1	1	1
192	589	High tension lead 0 Din 72561	-	-	-	X	X	X
193	3308	Connector	-	-	-	1	1	1
194	3087	Rubber cap for electronic box	-	-	-	1	1	1
195	3305	Connector female	-	-	-	4	4	4
196	3577	Connector housing	-	-	-	2	2	2
197	3576	Connector female 6,3-1 Din 46247	-	-	-	2	2	2
198	5730	Cable FLK B1 Din 72551 black	-	-	-	X	X	X
199	2611	Wire housing B 0 8x0,7 Din 40621	-	-	-	X	X	X
200	2610	Wire housing B 0 6x0,6 Din 40621	-	-	-	X	X	X
201	2608	Wire housing B 0 4x0,5 Din 40621	-	-	-	X	X	X
202	2607	Wire housing B 0 3x0,4 Din 40621	-	-	-	X	X	X
203	603	Spark plug Champion N 2	1	1	1	1	1	1
204	5320	Carburetor cpl Bing V54-2	1	1	1	1	1	1
205	681	Flange	1	1	1	1	1	1
206	3143	Carburetor manifold	1	1	1	1	1	1
207	683	Clamp	2	2	2	2	2	2
	2948	Small gasket set consists of 6,9,10,60,61	1	-	-	1	-	-
	2949	Small gasket set consists of 6,9,10,60,61	-	1	-	-	1	-
	2950	Small gasket set consists of 6,9,10,60,61	-	-	1	-	-	1
	2958	Large gasket set consists of 6,9,10,20,30,31,34,42,43,56,60,61,95,148	1	-	-	1	-	-
	2959	Large gasket set consists of 6,9,10,20,30,31,34,42,43,56,60,61,95,148	-	1	-	-	1	-
	2960	Large gasket set consists of 6,9,10,20,30,31,34,42,43,56,60,61,95,148	-	-	1	-	-	1
	3602	Sealing paste for ignition	1	1	1	1	1	1

X - meters

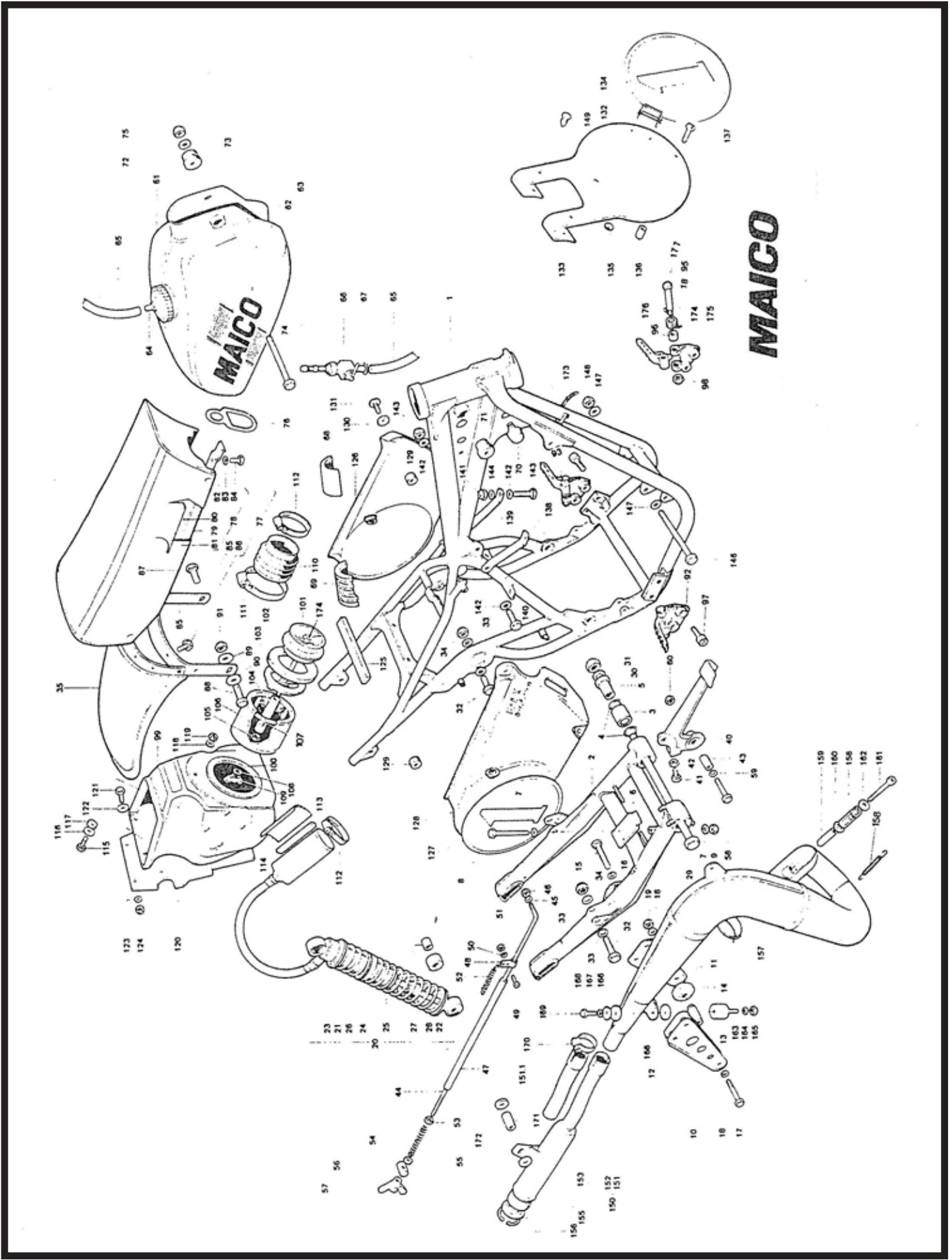

Picture No.	Part No.	Description	Quantity		
			250	400	440
1	5	Frame cpl	1	1	1
2	1929	Swing arm	1	1	1
3	3932	Needle cage HK 2030	2	2	2
4	1930	O ring	4	4	4
5	1931	Bush for swing arm	2	2	2
6	1932	Guide plate for swing arm	2	2	2
7	1732	Washer B 6.4 Din 125	2	2	2
8	1575	Hexagon screw M 6x60 Din 931	1	1	1
9	1690	Hexagon nut NM 6x60 Din 980	1	1	1
10	1933	Chain guide plate right hand	1	1	1
11	1934	Chain guide plate left hand	1	1	1
12	1935	Plastic plate for chain guide	2	2	2
13	1936	Spacer bush for chain guide	3	3	3
14	1937	Roller for chain guide	2	2	2
15	1580	Hexagon screw M 6x45 Din 933	2	2	2
16	1704	Spring ring B 6 Din 127	2	2	2
17	1500	Hexagon screw M 6x40 Din 931	1	1	1
18	1732	Washer B 6,4 Din 125	2	2	2
19	1690	Hexagon nut M 6 Din 980	1	1	1
20	6141	Rear shock cpl	2	2	2
21	1942	Upper spring cup	1	1	1
22	1943	Lower spring cup	1	1	1
23	1944	Circlip SW 40	1	1	1
24	1945	Guide ring for spring	1	1	1
25	1946	Spring long	1	1	1
26	1947	Spring short	1	1	1
27	1948	Bush	2	2	2
28	1940	Silent bloc	2	2	2
29	3937	Swing arm spindle	1	1	1
30	1718	Spring washer B 14 Din 137	1	1	1
31	5011	Hexagon nut NM 14x1.5 Din 980-8	1	1	1
32	1594	Hexagon screw M 8x40 Din 931	4	4	4
33	1734	Washer B 8,4 Din 125	8	8	8
34	1692	Self locking nut M 8 Din 980	4	4	4
35	5393	Rear fender	1	1	1
36	1571	Hexagon screw M 6x30 Din 931	4	4	4
37	1732	Washer B 6,4 Din 125	4	4	4
38	1750	Washer 6,4 Din 9021	8	8	8

Picture No.	Part No.	Description	Quantity		
			250	400	440
39	1690	Self locking nut NM 6 Din 980	4	4	4
40	6156	Front brake lever	1	1	1
41	1570	Hexagon screw M 6x25 Din 933	1	1	1
42	1667	Hexagon nut M 6 Din 934	1	1	1
43	6158	Bush for brake lever	1	1	1
44	1977	Rear brake rod	1	1	1
45	1732	Washer B 6,4 Din 125	1	1	1
46	1690	Self locking nut NM 6 Din 980	1	1	1
47	406	Ventilation hose	*	*	*
48	237	Clamp	1	1	1
49	1527	Cylinder head screw M 4x10 Din 84	1	1	1
50	1702	Spring ring B 4 Din 127	1	1	1
51	1665	Hexagon nut M 4 Din 934	1	1	1
52	236	Extension spring	1	1	1
53	1667	Hexagon nut M 6 Din 934	1	1	1
54	242	Pressure spring	1	1	1
55	1732	Washer B 6,4 Din 125	1	1	1
56	244	Nipple holder	1	1	1
57	243	Wing nut	1	1	1
58	1500	Hexagon screw M 6x40 Din 931	1	1	1
59	1732	Washer B 6,4 Din 125	1	1	1
60	1690	Hexagon nut NM 6 Din 980	1	1	1
61	6160	Tank	1	1	1
62	3520	Maico emblem, left hand	1	1	1
63	3521	Maico emblem, right hand	1	1	1
64	2228	Tank cap	1	1	1
65	406	Gasoline hose	*	*	*
66	2831	Gasoline tap	1	1	1
67	2832	Hose clip	1	1	1
68	3527	Rubber pad for tank	1	1	1
69	3522	Rubber pad for tank rear	1	1	1
70	3866	Moulded rubber mount	2	2	2
71	5348	Bush for tank	2	2	2
72	5344	Rubber ring for tank	2	2	2
73	1734	Washer B 8,4 Din 125	2	2	2
74	1604	Hexagon screw M 8x90 Din 931	1	1	1
75	1692	Self locking nut NM 8 Din 980	1	1	1
76	3397	Tension ring	1	1	1
77	5192	Seat cpl (low)	1	1	1
	5200	Seat cpl (high)	1	1	1

Picture No.	Part No.	Description	Quantity		
			250	400	440
78	5391	Seal low less pos 85 & 86	1	1	1
	6392	Seat cpl high less pos 85 & 86	1	1	1
79	5193	Seat base	1	1	1
80	5194	Seat padding (low)	1	1	1
	5199	Seat padding (high)	1	1	1
81	5195	Seat cover	1	1	1
82	286	Clap holder for seat	1	1	1
83	1704	Spring washer B 6 Din 127	2	2	2
84	1567	Hexagon screw M 6x16 Din 933	2	2	2
85	5197	Seat bracket	1	1	1
86	1728	Self locking screw	4	4	4
87	1568	Hexagon screw M 8x18 Din 933	1	1	1
88	1592	Hexagon screw M 8x30 Din 933	1	1	1
89	1749	Washer 8,4 Din 9021	3	3	3
90	1734	Washer B 8,4 Din 125	1	1	1
91	1692	Self locking nut NM 8 Din 980	2	2	2
92	3779	Foot rest right hand cpl	1	1	1
93	3780	Foot rest left hand cpl	1	1	1
94	3566	Foot rest spring right hand	1	1	1
95	3568	Foot rest spring left hand	1	1	1
96	3565	Bush for foot rest	2	2	2
97	1655	Socket screw M 10x25 Din 6912	2	2	2
98	1692	Self locking nut NM 8 Din 980	2	2	2
99	2258	Air filter box	1	1	1
100	2485	Rubber ring for filter box	1	1	1
101	3182	Flange for air box outside	1	1	1
102	5153	Foam ring	1	1	1
103	3163	Flange for air box	1	1	1
104	3184	Spacer tube	1	1	1
105	1667	Hexagon nut	1	1	1
106	3181	Foam filter	1	1	1
107	3164	Air filter body	1	1	1
108	1750	Washer 6,4 Din 9021	1	1	1
109	2260	Wing nut	1	1	1
110	343	Rubber sleeve	1	1	1
111	348	Clamp	1	1	1
112	683	Clamp	5	5	5
113	5204	Foam seal	*	*	*
114	2261	Strengthening plate for filter box	2	2	2
115	1569	Hexagon screw M 6x20 Din 9021	2	2	2
116	1750	Washer 6,4 Din 9021	1	1	1

Picture No.	Part No.	Description	Quantity		
			250	400	440
117	2708	Rubber washer	1	1	1
118	1732	Washer B 6,4 Din 125	1	1	1
119	1690	Self locking nut NM 6 Din 980	1	1	1
120	6241	Splash guard	1	1	1
121	1567	Hexagon screw M 6x16 Din 933	4	4	4
122	1750	Washer 6,4 Din 9021	6	6	6
123	1732	Washer B 6,4 Din 125	2	2	2
124	1690	Self locking nut NM 6 Din 980	4	4	4
125	5204	Foam seal	*	*	*
126	2264	Side panel left side	1	1	1
127	6252	Number plate transfers green	2	-	-
	4152	Number plate transfers yellow	-	2	2
128	6246	Side panel right side	1	1	1
129	5029	Spacer washer for side panel	6	6	6
130	2708	Rubber washer	6	6	6
131	3711	Plastic screw	6	6	6
132	6247	Cable guide	1	1	1
133	6251	Front number plate	1	1	1
134	6252	Front number plate transfers green	1	-	-
	4152	Front number plate transfers Yellow	-	1	1
135	6265	Spring nut	2	2	2
136	3094	Sliding rollers	2	2	2
137	6253	Plastic screw	2	2	2
138	2277	Cylinder head stay right hand	1	-	-
	2282	Cylinder head stay right hand	-	1	1
139	2278	Cylinder head stay left hand	1	-	-
	2283	Cylinder head stay left hand	-	1	1
140	1591	Hexagon screw M 8x25 Din 933	1	1	1
141	1692	Self locking nut NM 8 Din 980	3	3	3
142	1734	Washer B 8,4 Din 125	4	4	4
143	1592	Hexagon screw M 8x30 Din 933	2	2	2
144	1714	Spring washer B 8 Din 137	2	2	2
145	6254	Set of engine bolts pos 146,147,148	1	1	1
146	1610	Hexagon screw M 8x120 Din 931	2	2	2
147	1734	Washer B 8,4 Din 125	4	4	4
148	1700	Self locking nut NM 8 Din 980	2	2	2
149	6267	Plastic clip	2	2	2
151	6272	Exhaust system, welded	1	-	-
151.1	6277	Exhaust system, welded	-	1	1
152	5466	Silencer cpl	1	-	-
	5485	Silencer cpl	-	1	1

Picture No.	Part No.	Description	Quantity		
			250	400	440
154	5155	Exhaust padding	1	-	-
	3557	Exhaust padding	-	1	1
155	5311	End cap	1	1	1
156	1859	Retaining ring 50x2 Din 472	1	1	1
157	896	Asbestos cord	*	*	*
158	6275	Pressure spring	1	1	1
159	6276	Spacer tube	1	1	1
160	1750	Washer 6,4 Din 9021	1	1	1
161	1523	Hexagon screw M 8x70 Din 912	1	1	1
162	1750	Washer 6,4 Din 9021	1	1	1
163	1166	Silent bloc for exhaust	2	2	2
164	1732	Washer B 6,4 Din 125	2	2	2
165	1690	Self locking nut NM 6 Din 980	2	2	2
166	5430	Washer	4	4	4
167	1750	Washer 6,4 Din 9021	2	2	2
168	1704	Spring ring B 6 Din 127	2	2	2
169	1525	Hexagon screw M 6x14 Din 932	2	2	2
170	5429	Clamp SP	1	-	-
	5474	Clamp SP	-	1	1
171	5453	Bush for silencer securing bolt	1	1	1
172	5345	Rubber washer	2	2	2
173	325	Plastic cable clip	8	8	8
174	3758	Hexagon bolt M 6x130x35	1	1	1

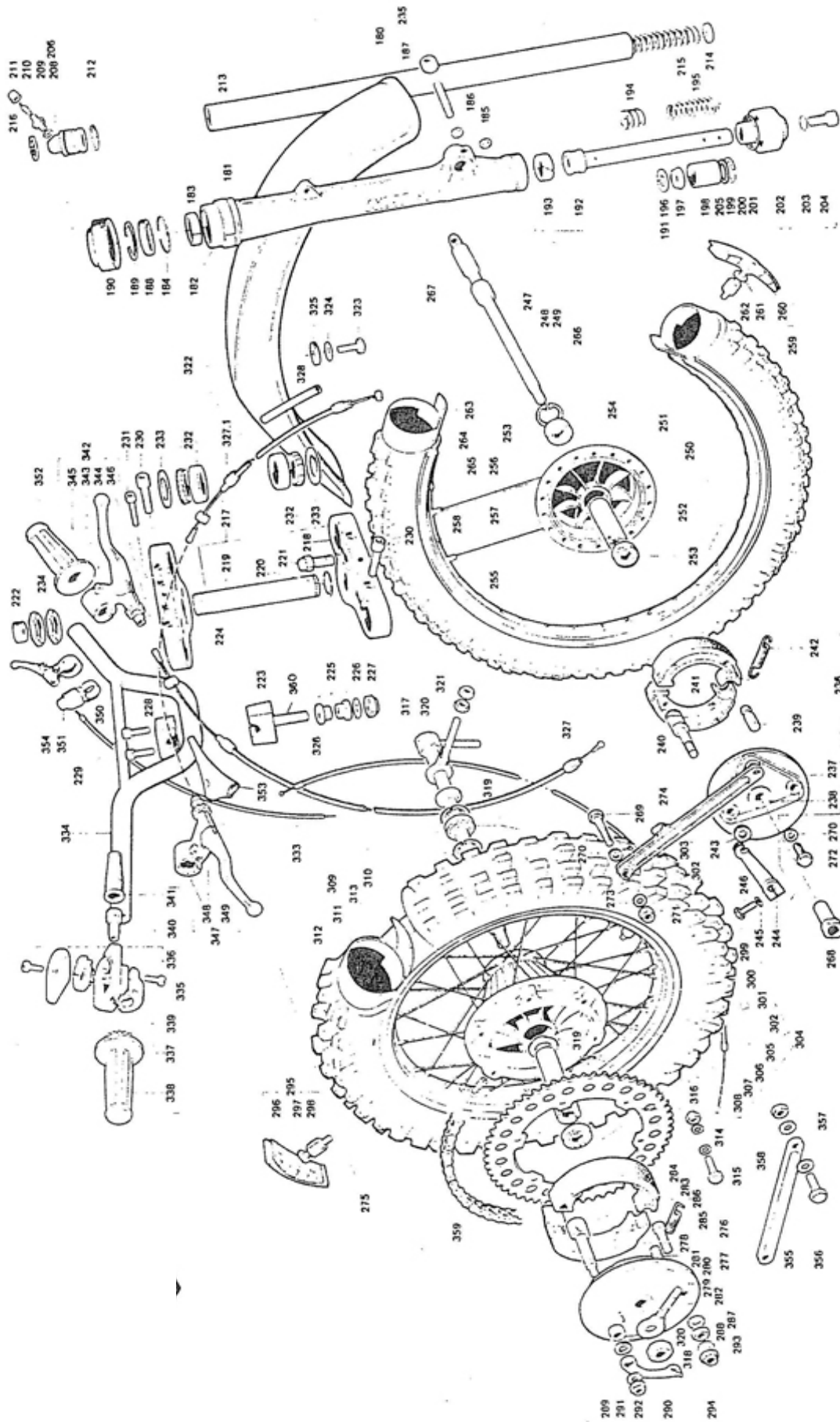

Picture No.	Part No.	Description	Quantity		
			250	400	440
180	6221	Fork leg cpl	2	2	2
181	2170	Slider tube	2	2	2
182	2166	Slider tube with bush	2	2	2
183	2168	Guide bush for main tube	2	2	2
184	2169	Circlip for fork	2	2	2
185	1734	Washer B 8,4 Din 125	4	4	4
186	1783	Stud M 6x30 Din 939	2	2	2
187	1692	Self locking nut NM 8 Din 980	2	2	2
188	2171	Sealing ring RP 37.8x48x6	2	2	2
189	2172	Circlip	2	2	2
190	3907	Sealing ring	2	2	2
191	2178	Damper cpl	2	2	2
192	2176	Damper tube	2	2	2
193	3789	Piston ring for damper	2	2	2
194	2179	Counter spring hard	2	2	2
195	2181	Counter spring soft	2	2	2
196	3369	Valve seat	2	2	2
197	3368	Valve	2	2	2
198	3367	Damper insert	2	2	2
199	3366	Retaining ring 34x1.5 Din 472	2	2	2
200	2182	Bush for damper tube	2	2	2
201	1902	O-ring	2	2	2
202	2183	Damper plug	2	2	2
203	430	Sealing ring A 8x14 Din 7603	2	2	2
204	1653	Socket screw M 8x20 Din 912	2	2	2
205	3777	Spacer washer 0.3			
	3778	Spacer washer 0.5	2	2	2
206	2188	Fork plug cpl	2	2	2
207			2	2	2
208	277	Sealing ring A 8x11.5 Din 7603	2	2	2
209	2185	Air valve body	2	2	2
210	2186	Air valve insert	2	2	2
211	2187	Air valve cap	2	2	2
212	6220	O-ring	2	2	2
213	3790	Main tube	2	2	2
214	2193	O-ring	1	1	1
215	2194	Fork spring	2	2	2
216	3366	Retaining ring 34x1.5 Din 472	2	2	2

Picture No.	Part No.	Description	Quantity		
			250	400	440
217	3371	Lower cross head cpl	1	1	1
218	3372	Lower cross head	1	1	1
219	3373	Steering tube	1	1	1
220	3375	Circlip A 26 Din 7993	1	1	1
221	226	Locking bolt	2	2	2
222	5003	Plug for steering tube	1	1	1
223	290	Lower handlebar clamp	2	2	2
224	3381	Upper cross head	1	1	1
225	15	Rubber buffer	4	4	4
226	1758	Washer	2	2	2
227	1693	Self locking nut NM 10 Din 980	2	2	2
228	88	Upper handlebar clamp	2	2	2
229	1646	Socket screw M 8x30 Din 912	4	4	4
230	1657	Socket screw M 10x40 Din 912	4	4	4
231	1650	Socket screw M 8x60 Din 912	2	2	2
232	3297	Roller bearing L44649/610	2	2	2
233	3296	Nilos ring	2	2	2
234	3533	Hexagon nut	2	2	2
235	6223	Front fork cpl	1	1	1
236	2239	Frone brake plate cpl	1	1	1
237	2236	Front brake plate with bush	1	1	1
238	2238	Bush for brake plate	1	1	1
239	2418	Pivot bolt	1	1	1
240	2419	Brake toggle	1	1	1
241	1322	Brake shoe	2	2	2
242	1323	Tension spring	2	2	2
243	187	Rubber washer	1	1	1
244	1324	Front brake lever	1	1	1
245	1704	Spring washer B 6 Din 127	1	1	1
246	1569	Hexagon screw M 6x20 Din 933	1	1	1
247	6146	Front wheel cpl	1	1	1
248	2240	Front wheel with tire	1	1	1
249	2235	Front wheel bare	1	1	1
	5622	Front wheel bare	1	1	1
250	2234	Front brake drum cpl	1	1	1
251	2233	Front brake drum	1	1	1
252	2428	Spacer tube	2	2	2
253	2427	Ball bearing 6202	1	1	1
254	1853	Retainer ring	1	1	1
255	3497	Front rim	18	18	18
256	2432	Spoke short	18	18	18

Picture No.	Part No.	Description	Quantity		
			250	400	440
257	2433	Spoke long	36	36	36
258	2242	Spoke nipple 4.5/M 4	1	1	1
259	168	Front tire holder cpl	1	1	1
260	2568	Front tire holder plate	1	1	1
261	1734	Washer B 8,4 Din 125	1	1	1
262	289	Nut for tire holder	1	1	1
263	2001	Rim strap 21"	1	1	1
264	2002	Inner tube 3.00x21"	1	1	1
265	2003	Front tire 3.00x21"	1	1	1
266	2242	Front axle	1	1	1
267	2250	Spacer bush	1	1	1
268	2430	Threaded bush	1	1	1
269	1594	Hexagon screw M 8x40 Din 931	1	1	1
270	1734	Washer B 8,4 Din 125	2	2	2
271	1692	Self locking nut NM 8 Din 980	1	1	1
272	1589	Hexagon screw A 18x20 Din 933	1	1	1
273	1714	Spring washer B 8 Din 137	1	1	1
274	2424	Front brake arm	4	4	4
275	6290	Rear wheel cpl	1	1	1
276	3186	Rear brake plate cpl	1	1	1
277	3045	Rear brake plate with parts	1	1	1
278	3187	Rear brake plate	1	1	1
279	183	Spacer bush	2	2	2
280	3188	Cover plate	1	1	1
281	3189	Pivot bolt	1	1	1
282	1901	Oval head nail 3x8 Din 1476	1	1	1
283	151	Brake toggle	1	1	1
284	188	Brake shoe	2	2	2
285	6148	Tension spring	2	2	2
286	3270	Socket screw M 10x40 Din 6912	1	1	1
287	1715	Spring washer	1	1	1
288	1674	Hexagon nut M 10 Din 934	1	1	1
289	187	Rubber washer	1	1	1
290	3190	Rear brake lever	1	1	1
291	1734	Washer B 8,4 Din 125	2	2	2
292	1692	Self locking nut NM 8 Din 980	1	1	1
293	1735	Washer B 10.5 Din 125	1	1	1
294	1693	Self locking nut NM 10 Din 980	1	1	1
295	2434	Rear tire holder	1	1	1
296	2567	Rear tire holder plate	1	1	1
297	1734	Washer B 8,4 Din 125	1	1	1

Picture No.	Part No.	Description	Quantity		
			250	400	440
298	289	Nut for tire holder	1	1	1
299	3875	Rear brake drum cpl	1	1	1
300	3868	Rear brake drum	1	1	1
301	3872	Spacer bush rear cpl	1	1	1
302	205	Ball bearing 6303 2 RS C3	2	2	2
303	1852	Retaining ring 47x1.75	2	2	2
304	3876	Rear wheel bare	1	1	1
305	2405	Rear rim	1	1	1
306	2406	Spoke short	18	18	18
307	2407	Spoke long	18	18	18
308	2408	Spoke nipple	36	36	36
309	3343	Rear wheel with tire	1	1	1
310	2005	Rim strap 18"	1	1	1
311	2015	Inner tube 4.50x18'	1	1	1
312	2008	Tire 4.50x18"	1	1	1
313	3227	Rear wheel sprocket 56 T	1	1	1
	2200	Rear wheel sprocket 54 T	-	-	-
314	1713	Spring washer B 7 Din 137	16	16	16
315	3280	Hexagon screw M 7x40 Din 933	6	6	6
316	1691	Self locking nut NM 7 Din 980	6	6	6
317	3277	Rear axle cpl	1	1	1
318	1709	Self locking nut NM 7 Din 980	1	1	1
319	3880	Spacer ring	1	1	1
320	223	Chain tensioner	2	2	2
321	1670	Hexagon nut M 8 Din 934	4	4	4
322	6142	Front fender	1	1	1
323	1569	Hexagon scrwe M 6x20 Din 933	4	4	4
324	1750	Washer 6,4 Din 9021	4	4	4
325	2708	Rubber washer	4	4	4
326	2456	Throttle cable	1	1	1
327	6150	Clutch cable	1	1	1
327.1	486	Brake cable	1	1	1
328	2275	Isolation hose B 8x0.7 Din 40621	*	*	*
333	315	Decompression cable	-	1	1
334	2230	Handlebar, high black	1	1	1
335	6261	Throttle grip cpl	1	1	1
336	6283	Throttle grip housing	1	1	1
337	6285	Throttle tube with cover	1	1	1
338	2148	Throttle grip, rubber	1	1	1
339	6284	Throttle cam	1	1	1
340	2211	Throttle stop screw	1	1	1

Picture No.	Part No.	Description	Quantity		
			250	400	440
341	2212	Rubber sleeve for stop screw	1	1	1
342	2215	Hand clutch lever cpl	1	1	1
343	2213	Hinge for hand clutch lever	1	1	1
344	2216	Hand clutch lever	1	1	1
345	133	Lever screw with nut	2	2	2
346	212	Adjusting screw with nut	2	2	2
347	2218	Hand brake lever cpl	1	1	1
348	2217	Hinge for hand brake lever with screw	1	1	1
349	2219	Hand brake lever	1	1	1
350	2220	Kill button cpl	1	1	1
351	2221	Rubber cap	1	1	1
352	2512	Rubber grip	1	1	1
353	3166	Lever cover	2	2	2
354	148	Decompression lever cpl	-	1	1
355	1978	Rear brake torque arm	1	1	1
356	1591	Hexagon screw M 8x25 Din 933	1	1	1
357	1734	Washer B 8,4 Din 125	2	2	2
358	1692	Self locking nut NM 8 Din 980	1	1	1
359	2281	Rear chain	1	1	1
360	1661	Socket screw M 10x60 Din 6912	2	2	2

MAICO

1979 SPARE PARTS CATALOGUE

MODEL : Magnum II

CHASSIS TYPE :	MC 250/T	Type 341	Engine Type 336
	MC 400/T	Type 342	Engine Type 337
	MC 440/T	Type 343	Engine Type 338

CHASSIS DESCRIPTION:

Red frame with rear fender
 removable fork caps. New foot pegs - Corte Cosso shocks 370mm long - Front wheel travel increased to 275mm.

New tank decal. Quick

ENGINE DESCRIPTION:

Same as 1978 with modified transfer port cylinder. 440, 400 with 40mm carburetor.

FRAME IDENTIFICATION:

Stamped on the Steering head
 First 3 numbers: 341 0000

ENGINE TYPE IDENTIFICATION:

Stamped on the left side of the engine case
 First 3 numbers: 336 0000

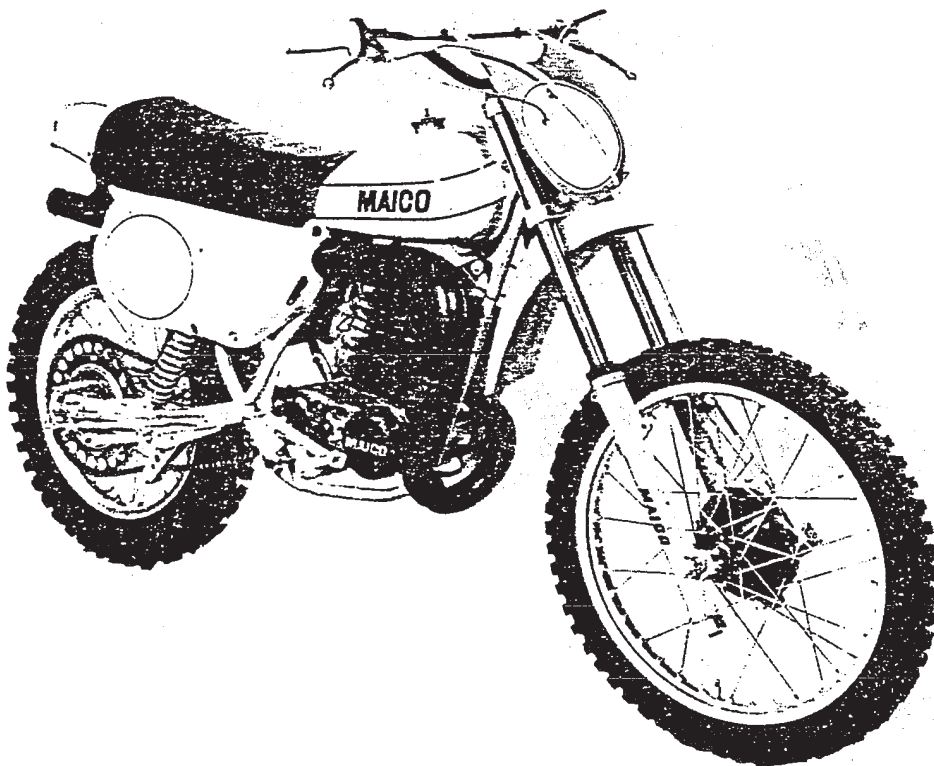

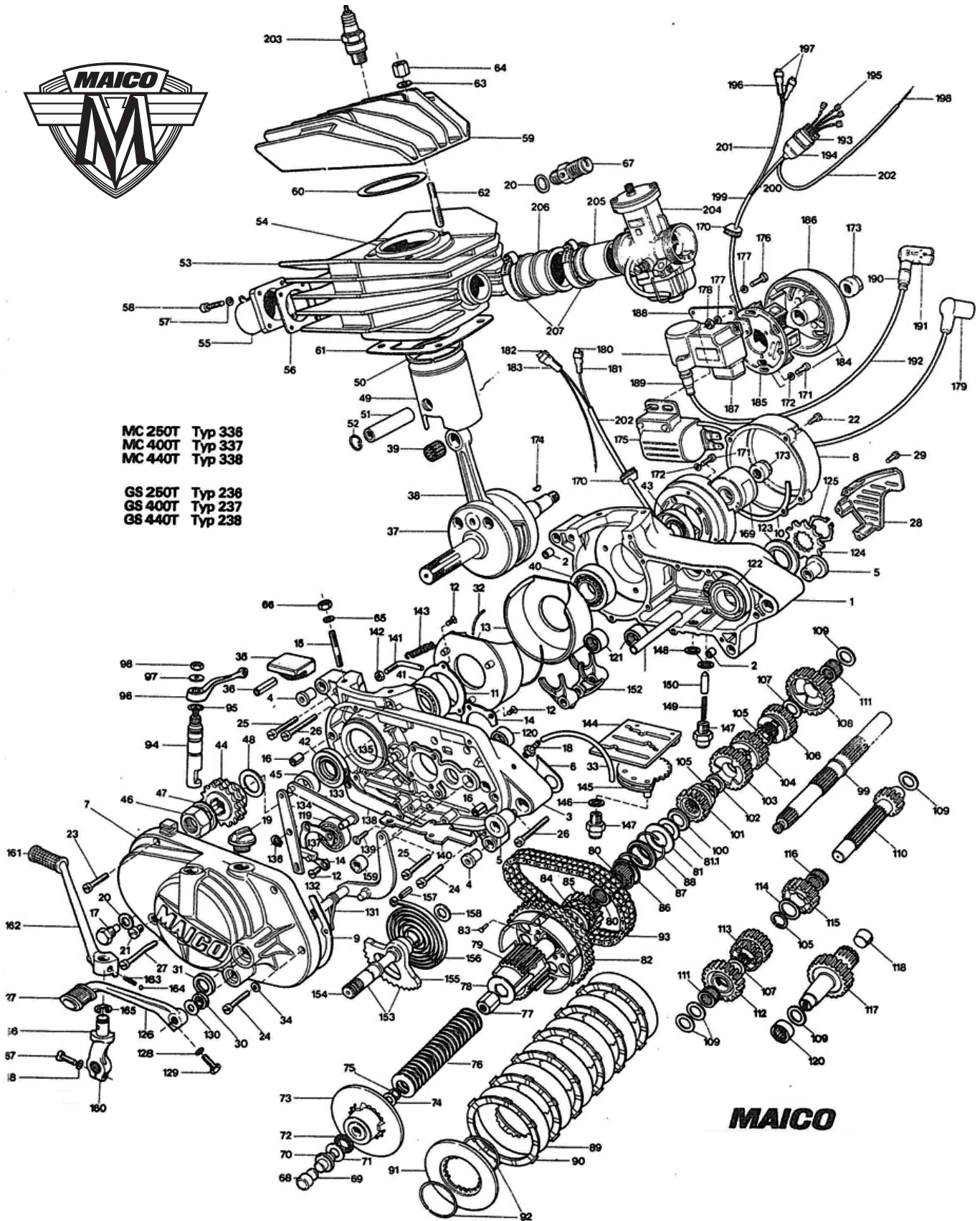

MC 250T Typ 338
 MC 400T Typ 337
 MC 440T Typ 338

GS 250T Typ 238
 GS 400T Typ 237
 GS 440T Typ 238

MAICO

Picture No.	Part No.	Description	MC 250	MC 400	MC 440	GS 250	GS 400	GS 440
1	1998	Crankcase right hand	1	1	-	1	1	-
	1982	Crankcase right hand	-	-	1	-	-	1
2	1997	Internal ring	2	2	2	2	2	2
3	1996	Crankcase left hand	1	1	-	1	1	-
	1979	Crankcase left hand	-	-	1	-	-	1
4	1995	Emgine mounting bushes	6	6	6	6	6	6
5	1994	Spacer bush for swing arm	2	2	2	2	2	2
6	1993	Crankcase gasket	1	1	1	1	1	1
7	1992	Crankcase cover	1	1	1	1	1	1
8	1991	Ignition cover	1	1	1	1	1	1
9	1990	Crankcase cover gasket left hand	1	1	1	1	1	1
10	1989	Crankcase cover gasker right hand	1	1	1	1	1	1
11	1988	Main bearing cover plate	1	1	1	1	1	1
12	1795	Counter sunk screw M 5x8 Din 965	11	11	11	11	11	11
13	1987	Crankshaft housing	2	-	-	2	-	-
14	1986	MS bearing cover plate	2	2	2	2	2	2
15	1787	Stud screw M 8x28 Din 940	4	4	4	4	4	4
16	1831	Tension pin 8x10 Din 7346	2	2	2	2	2	2
17	400	Oil drain plug	1	1	1	1	1	1
18	1985	Breather	1	1	1	1	1	1
19	1984	Oil filling plug	1	1	1	1	1	1
20	410	Spacer ring	1	2	2	1	2	2
21	1526	Cylinder head screw M 8x10 Din 84	1	1	1	1	1	1
22	1536	Cylinder head screw M 6x25 Din 84	4	4	4	4	4	4
23	1550	Cylinder head screw M 6x30 Din 84	3	3	3	3	3	3
24	1538	Cylinder head screw M 6x35 Din 84	5	5	5	5	5	5
25	1539	Cylinder head screw M 6x40 Din 84	6	6	6	6	6	6
26	1541	Cylinder head screw M 6x50 Din 84	2	2	2	2	2	2
27	1542	Cylinder head screw M 6x55 Din 84	2	2	2	2	2	2
28	1983	Counter sprocket cover	1	1	1	1	1	1
29	1533	Cylinder head screw M 6x18 Din 84	3	3	3	3	3	3
30	1865	Sealing ring AS 12x22x7 Din 3760	1	1	1	1	1	1
31	1866	Sealing ring A 18x28x7	1	1	1	1	1	1
32	1313	Sprint rubber	X	-	-	X	-	-
33	263	Breather tube	X	X	X	X	X	X
34	407	Flat washer A 6x10 Din 7603	2	2	2	2	2	2
35	2133	Sliding piece	1	1	1	1	1	1
36	1835	Tension pin 8x36 Din 1481	1	1	1	1	1	1
37	3225	Crankcase cpl	1	-	-	1	-	-
	3258	Crankcase cpl	-	1	1	-	1	1
	4131	Crankshaft part exchange	1	-	-	1	-	-
	4132	Crankshaft part exchange	-	1	1	-	1	1

Picture No.	Part No.	Description	MC 250	MC 400	MC 440	GS 250	GS 400	GS 440
38	4163	Connecting rod cpl	1	1	-	1	1	-
	4162	Connecting rod cpl	-	1	1	-	1	1
39	424	Needle bearing Red 0-2						
		Needle bearing Blue 2-4	1	1	1	1	1	1
		Needle bearing White 4-6						
40	426	Roller bearing NU 305 C3 Din 628	1	1	1	1	1	1
41	693	Ball bearing 3305 C3 Din 628	1	1	1	1	1	1
42	547	Sealing ring	1	1	1	1	1	1
43	3469	Sealing ring	1	1	1	1	1	1
44	3220	Duplex sprocket	1	-	-	-	-	-
	714	Triplex sprocket	-	1	1	1	1	1
45	713	Spacer	-	1	1	1	1	1
46	3240	Guide nut on crankshaft	1	1	1	1	1	1
47	3254	Securing plate	1	1	1	1	1	1
48	862	Washer 0.2 thick	When needed					
	3111	Washer 0.3 thick	When needed					
49	522	Piston std. 66.95	1	-	-	1	-	-
	2059	Piston 1st oversize 67.10	1	-	-	1	-	-
	2060	Piston 2nd oversize 67.25	1	-	-	1	-	-
	2061	Piston 3rd oversize 67.40	1	-	-	1	-	-
	532	Piston std. 76.93	-	1	-	-	1	-
	2069	Piston 1st oversize 77.08	-	1	-	-	1	-
	2070	Piston 2nd oversize 77.23	-	1	-	-	1	-
	2071	Piston 3rd oversize 77.38	-	1	-	-	1	-
	2072	Piston 4th oversize 77.53	-	1	-	-	1	-
	2110	Piston std. 81.92	-	-	1	-	-	1
	2112	Piston 1st oversize 82.07	-	-	1	-	-	1
	2114	Piston 2nd oversize 82.22	-	-	1	-	-	1
	2116	Piston 3rd oversize 82.37	-	-	1	-	-	1
	2118	Piston 4th oversize 82.52	-	-	1	-	-	1
50	523	Piston ring std. 67.00	1	-	-	1	-	-
	2064	Piston ring 1st oversize 67.15	1	-	-	1	-	-
	2065	Piston ring 2nd oversize 67.30	1	-	-	1	-	-
	2066	Piston ring 3rd oversize 67.45	1	-	-	1	-	-
	534	Piston ring std. LD 77.00	-	1	-	-	1	-
	2076	Piston ring 1st oversize 77.15	-	1	-	-	1	-
	2277	Piston ring 2nd oversize 77.30	-	1	-	-	1	-
	2078	Piston ring 3rd oversize 77.45	-	1	-	-	1	-
	2079	Piston ring 4th oversize 77.60	-	1	-	-	1	-
	2111	Piston ring LD Std. 82.22	-	-	1	-	-	1
	2113	Piston ring 1st oversize 82.151	-	-	1	-	-	1
	2115	Piston ring 2nd oversize 82.30	-	-	1	-	-	1
	2117	Piston ring 3rd oversize 82.45	-	-	1	-	-	1
	2119	Piston ring 4th oversize 82.60	-	-	1	-	-	1

Picture No.	Part No.	Description	MC 250	MC 400	MC 440	GS 250	GS 400	GS 440
51	535	Piston pin	1	-	-	1	-	-
	537	Piston pin	-	1	1	-	1	1
52	536	Circlip	2	2	2	2	2	2
53	2154	Radial cylinder cpl MC	1	-	-	-	-	-
	2157	Radial cylinder cpl MC	-	1	-	-	-	-
	2161	Radial cylinder cpl MC	-	-	1	-	-	-
	5698	Radial cylinder cpl GS	-	-	-	1	-	-
	5715	Radial cylinder cpl GS	-	-	-	-	1	-
	5725	Radial cylinder cpl GS	-	-	-	-	-	1
	4135	Cylinder part-exchange	1	-	-	1	-	-
	4136	Cylinder part-exchange	-	1	-	-	1	-
	4137	Cylinder part-exchange	-	-	1	-	-	1
54	5038	Cylinder liner	1	-	-	1	-	-
	2159	Cylinder liner	-	1	-	-	1	-
	2163	Cylinder liner	-	-	1	-	-	1
55	467	Exhaust flange MC	1	1	1	-	-	-
	5699	Exhaust flange GS 0 20	-	-	-	1	-	-
	5716	Exhaust flange GS 0 24	-	-	-	-	1	1
56	298	Gasket for exhaust flange	1	1	1	1	1	1
57	1704	Spring ring B 6 Din 127	4	4	4	4	4	4
58	1635	Socket screw M 6x25 Din 912	4	4	4	4	4	4
59	2156	Cylinder head Radial	1	-	-	1	-	-
	2160	Cylinder head Radial	-	1	-	-	1	-
	2164	Cylinder head Radial	-	-	1	-	-	1
60	65	Cylinder head gasket	1	-	-	1	-	-
	720	Cylinder head gasket	-	1	-	-	1	-
	2582	Cylinder head gasket	-	-	1	-	-	1
61	3004	Cylinder head gasket 0.3 thick						
	721	Cylinder head gasket 0.5 thick						
	2237	Cylinder head gasket 0.7 thick						
62	2967	Cylinder head stud	5	-	-	5	-	-
	2968	Cylinder head stud	-	5	5	-	5	5
63	1734	Washer B 8.4 Din 125	5	5	5	5	5	5
64	78	Hexagon nut	5	5	5	5	5	5
65	1714	Spring washer B 8 Din 137	4	4	4	4	4	4
66	1670	Hexagon nut M 8 Din 934	4	4	4	4	4	4
67	517	Decompression valve cpl	-	1	1	-	1	1
68	2251	Push pin cap	1	1	1	1	1	1
69	2252	Spacer 1.5 thick						
	2253	Spacer 2.0 thick						
	2254	Spacer 2.4 thick						
	2255	Spacer 2.8 thick						
	2256	Spacer 3.2 thick						
	2257	Spacer 1.75 thick						

Picture No.	Part No.	Description	MC 250	MC 400	MC 440	GS 250	GS 400	GS 440
70	2889	Push pin	1	1	1	1	1	1
71	1096	Bearing plate	1	1	1	1	1	1
72	1084	Needle cage	1	1	1	1	1	1
73	2886	Guide for clutch disc	1	1	1	1	1	1
74	2890	Washer 10.1x18.2x0.6	1	1	1	1	1	1
75	1842	Securing ring	1	1	1	1	1	1
76	449	Cup spring	20	20	20	20	20	20
77	448	Guide nut	1	1	1	1	1	1
78	447	Lock plate for guide nut	1	1	1	1	1	1
79	2580	Clutch body	1	1	1	1	1	1
80	736	Needle cage	2	2	2	2	2	2
81	444	Thrust washer	1	1	1	1	1	1
81.1	1884	Spacer washer 17x25x0.2	When needed					
	3432	Spacer washer 17x25x0.3	When needed					
82	2895	Clutch housing with kickstarter ratchet wheel	1	-	-	-	-	-
	2944	Clutch housing with kickstarter ratchet wheel	-	1	1	1	1	1
83	1906	Oval head rivet	8	8	8	8	8	8
84	729	Kickstarter ratchet wheel	1	1	1	1	1	1
85	730	Kickstarter pinion	1	1	1	1	1	1
86	731	Ratchet spring	1	1	1	1	1	1
87	732	Spring cup	1	1	1	1	1	1
88	733	Spring ring	1	1	1	1	1	1
89	3390	Inner disc	6	6	6	6	6	6
90	3396	Clutch disc	6	6	6	6	6	6
91	3391	Terminal disc	1	1	1	1	1	1
92	461	Circlip	2	2	2	2	2	2
93	2899	Duplex-chain	1	-	-	1	-	-
	2947	Triplex-chain	-	1	1	-	1	1
94	462	Clutch spindle	1	1	1	1	1	1
95	464	Sealing ring for clutch spindle	1	1	1	1	1	1
96	2898	Clutch lever	1	1	1	1	1	1
97	1732	Washer B 6.4 Din 125	1	1	1	1	1	1
98	1690	Hexagon nut NM 6 Din 980	1	1	1	1	1	1
99	2025	Main shaft	1	1	1	1	1	1
100	2043	M S shim	1	1	1	1	1	1
101	3441	1st gear pinion on mainshaft 19 teeth	1	-	-	-	-	-
	3449	1st gear pinion on mainshaft 17 teeth	-	1	1	1	1	1
102	3706	Spacer ring	1	1	1	1	1	1
103	3435	4th gear pinion on mainshaft 26 teeth	1	1	1	1	1	1
104	3434	3th gear pinion on mainshaft 24 teeth	1	-	-	-	-	-
	3967	3th gear pinion on mainshaft 23 teeth	-	1	1	-	-	-
	3443	3th gear pinion on mainshaft 23 teeth	-	-	-	1	1	1

Picture No.	Part No.	Description	MC 250	MC 400	MC 440	GS 250	GS 400	GS 440
105	492	Retainer ring	3	3	3	3	3	3
106	3440	2nd gear pinion on mainshaft 21 teeth	1	-	-	-	-	-
	3448	2nd gear pinion on mainshaft 20 teeth	-	1	1	1	1	1
107	3723	Shim for 1st gear	2	2	2	2	2	2
108	2039	5th gear pinion on mainshaft 28 teeth	1	1	1	-	-	-
	2049	5th gear pinion on mainshaft 29 teeth	-	-	-	1	1	1
109	3893	Spacer washer	5	5	5	5	5	5
110	3437	Layshaft	1	1	1	-	-	-
	3445	Layshaft	-	-	-	1	1	1
111	913	Needle cage K 16x21x10	2	2	2	2	2	2
112	3438	1st gear pinion on layshaft 26 teeth	1	-	-	-	-	-
	3446	1st gear pinion on layshaft 28 teeth	-	1	1	1	1	1
113	3442	Twin block pinion on layshaft 19/21 teeth	1	1	1	-	-	-
	3450	Twin block pinion on layshaft 18/21 teeth	-	-	-	1	1	1
114	3456	Shim for 2nd gear	1	1	1	1	1	1
115	3439	2nd gear pinion on layshaft 23 teeth	1	-	-	-	-	-
	3447	2nd gear pinion on layshaft 24 teeth	-	1	1	1	1	1
116	3757	Needle cage K 20x24x12	1	1	1	1	1	1
117	2037	Drive shaft 28 teeth	1	1	1	-	-	-
	2048	Drive shaft 29 teeth	-	-	-	1	1	1
118	2038	Plug	1	1	1	1	1	1
119	339	Ball bearing 6303 CS Din 625	1	1	1	1	1	1
120	513	Needle bearing HK 1612	2	2	2	2	2	2
121	514	Needle bearing BK 1616	2	2	2	2	2	2
122	375	Ball bearing 6206 2RS C3 Din 625	1	1	1	1	1	1
123	2044	Spacer ring	1	1	1	1	1	1
124	3465	Sprocket 13 teeth	1	1	1	-	-	-
	3720	Sprocket 14 teeth	-	-	-	1	1	1
125	1848	Lock ring 29x1.5 Din 471	1	1	1	1	1	1
126	2327	Gear change lever	1	1	1	1	1	1
127	556	Rubber pad	1	1	1	1	1	1
128	1570	Hexagon screw M 6x25 Din 933	1	1	1	1	1	1
129	1712	Spring washer B 6 Din 137	1	1	1	1	1	1
130	2324	Washer 12.1x26.2x1	1	1	1	1	1	1
131	573	Return spring	1	1	1	1	1	1
132	2503	Gear change crank	1	1	1	1	1	1
133	2336	Pullrod	1	1	1	1	1	1
134	2374	Pullrod pivot arm	1	1	1	1	1	1
135	1903	Pivot arm A 8x20 Din 1469	1	1	1	1	1	1
136	1836	Securing ring 8x0.8 Din 471	1	1	1	1	1	1
137	2376	Hooked ratchet sliding arm	1	1	1	1	1	1
138	2375	Guide plate	1	1	1	1	1	1

Picture No.	Part No.	Description	MC 250	MC 400	MC 440	GS 250	GS 400	GS 440
139	1795	Countersunk screw 5x8 Din 965	2	2	2	2	2	2
140	3326	Hooked ratchet "T"	1	1	1	1	1	1
141	2388	Hook	1	1	1	1	1	1
142	1667	Hexagon nut M 6 Din 934	1	1	1	1	1	1
143	576	Tension spring for hooked ratchet	1	1	1	1	1	1
144	3406	Shifting plate cpl	1	1	1	1	1	1
145	3402	Shifting segment	1	1	1	1	1	1
146	2397	Shim 10.6x18.2x1	1	1	1	1	1	1
147	2393	Guide screw	2	2	2	2	2	2
148	410	Sealing ring A 14x18	2	2	2	2	2	2
149	2395	Tension spring	1	1	1	1	1	1
150	2396	Pawl pin	1	1	1	1	1	1
151	2399	Gear selection fork spindle	1	1	1	1	1	1
152	3414	Gear selection fork	3	3	3	3	3	3
153	2566	Kickstarter spindle cpl	1	1	1	1	1	1
154	2559	Kickstarter spindle	1	1	1	1	1	1
155	761	Kickstarter Quadrant	1	1	1	1	1	1
156	666	Return spring	1	1	1	1	1	1
157	1828	Tension bush 5x26 Din 1481	1	1	1	1	1	1
158	1753	Shim 12.2x30.2x0.5	1	1	1	1	1	1
159	3353	Internal ring	1	1	1	1	1	1
160	5035	Kickstarter lever cpl	1	1	1	1	1	1
161	656	Rubber pad	1	1	1	1	1	1
162	5033	Kickstarter lever	1	1	1	1	1	1
163	3867	Compress spring for kickstarter	1	1	1	1	1	1
164	1874	Ball 0 7	1	1	1	1	1	1
165	1840	Lock washer RS	1	1	1	1	1	1
166	5034	Kickstarter joint	1	1	1	1	1	1
167	1570	Hexagon screw M 6x25 Din 933	1	1	1	1	1	1
168	1704	Spring ring B 6	1	1	1	1	1	1
169	3598	Motoplat Ignition cpl	1	1	1	-	-	-
170	3530	Rubber sleeve	1	1	1	1	1	1
171	1630	Socket screw M 5x16 Din 912	3	3	3	4	4	4
172	1731	Shim B 5.3 Din 125	1	1	1	1	1	1
173	1123	Nut for generator	1	1	1	1	1	1
174	1881	Woodruff key 3x3.7 Din 6888	1	1	1	1	1	1
175	3600	Ignition coil Motoplat	1	1	1	-	-	-
176	1567	Hexagon screw M 6x16 Din 933	2	2	2	4	4	4
177	1732	Shim B 6.4 Din 125	4	4	4	8	8	8
178	1690	Hexagon nut NM 6 Din 980	2	2	2	4	4	4
179	3610	Cable plug	1	1	1	-	-	-
180	3576	Connector 6,3-1 Din 46247	1	1	1	-	-	-
181	3596	Connector housing 6,3	1	1	1	-	-	-
182	3595	Connector 9,5-6 Din 46247	1	1	1	-	-	-

Picture No.	Part No.	Description	MC 250	MC 400	MC 440	GS 250	GS 400	GS 440
183	3597	Connector housing 9,5	1	1	1	-	-	-
184	5396	Bosch Elektronik MHKZ	-	-	-	1	1	1
185	5397	Stator	-	-	-	1	1	1
186	5398	Rotor	-	-	-	1	1	1
187	5399	Electronic box	-	-	-	1	1	1
188	5404	Support for Electronic box	-	-	-	1	1	1
189	3884	Cable plug water proof	-	-	-	1	1	1
190	600	Cable plug water proof	-	-	-	1	1	1
191	1126	Cable plug	-	-	-	1	1	1
192	589	High tension lead 0 Din 72561	-	-	-	X	X	X
193	3308	Connector	-	-	-	1	1	1
194	3087	Rubber cap for electronic box	-	-	-	1	1	1
195	3305	Connector female	-	-	-	4	4	4
196	3577	Connector housing	-	-	-	2	2	2
197	3576	Connector female 6,3-1 Din 46247	-	-	-	2	2	2
198	5730	Cable FLK B1 Din 72551 black	-	-	-	X	X	X
199	2611	Wire housing B 0 8x0,7 Din 40621	-	-	-	X	X	X
200	2610	Wire housing B 0 6x0,6 Din 40621	-	-	-	X	X	X
201	2608	Wire housing B 0 4x0,5 Din 40621	-	-	-	X	X	X
202	2607	Wire housing B 0 3x0,4 Din 40621	-	-	-	X	X	X
203	603	Spark plug Champion N 2	1	1	1	1	1	1
204	5320	Carburetor cpl Bing V54-2	1	1	1	1	1	1
205	681	Flange	1	1	1	1	1	1
206	3143	Carburetor manifold	1	1	1	1	1	1
207	683	Clamp	2	2	2	2	2	2
	2948	Small gasket set consists of 6,9,10,60,61	1	-	-	1	-	-
	2949	Small gasket set consists of 6,9,10,60,61	-	1	-	-	1	-
	2950	Small gasket set consists of 6,9,10,60,61	-	-	1	-	-	1
	2958	Large gasket set consists of 6,9,10,20,30,31,34,42,43,56,60,61,95,148	1	-	-	1	-	-
	2959	Large gasket set consists of 6,9,10,20,30,31,34,42,43,56,60,61,95,148	-	1	-	-	1	-
	2960	Large gasket set consists of 6,9,10,20,30,31,34,42,43,56,60,61,95,148	-	-	1	-	-	1
	3602	Sealing paste for ignition	1	1	1	1	1	1

X - meters

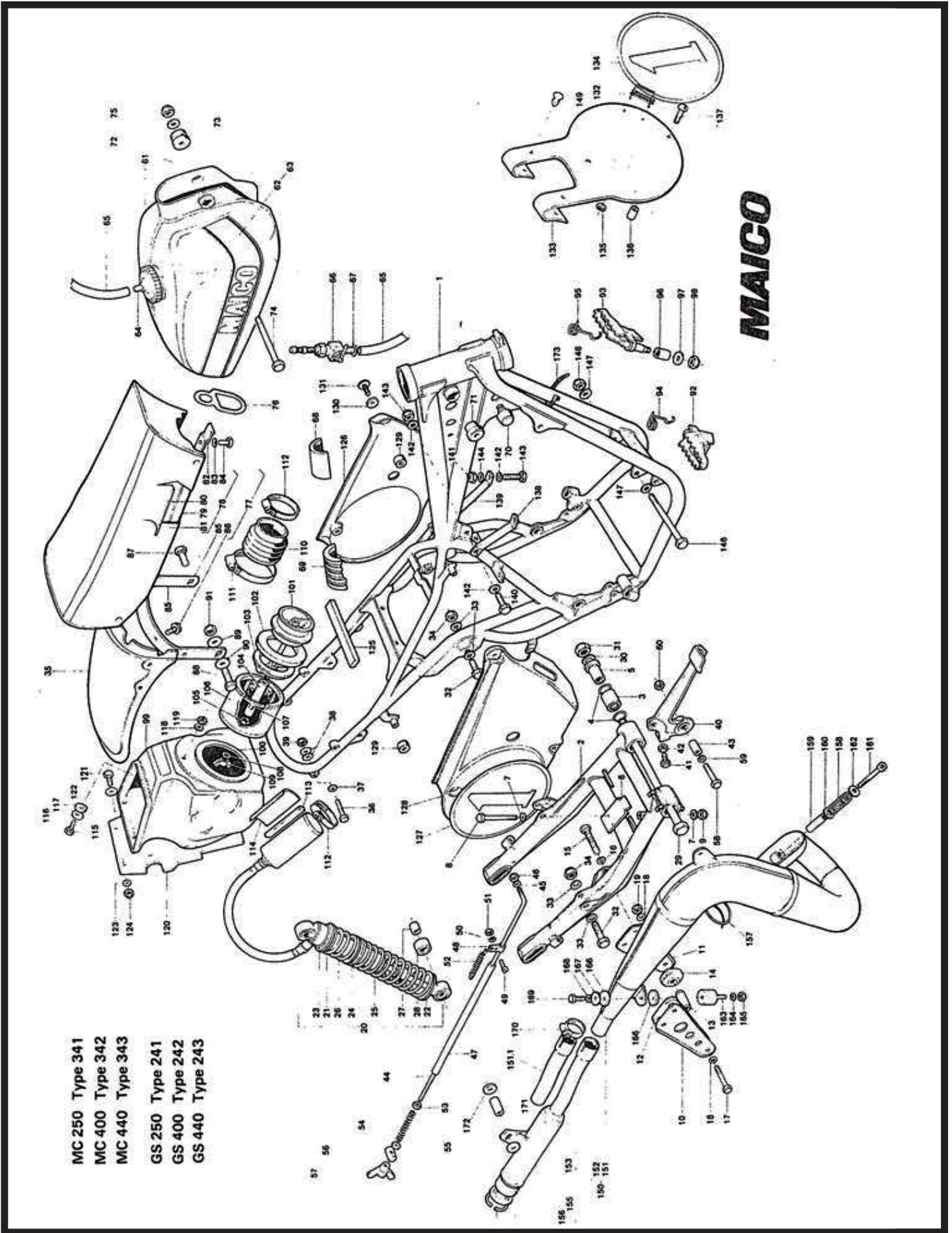

- MC 250 Type 341
- MC 400 Type 342
- MC 440 Type 343
- GS 250 Type 241
- GS 400 Type 242
- GS 440 Type 243

Picture No.	Part No.	Description	MC	MC	MC	GS	GS	GS
			250	400	440	250	400	440
			Quantity					
1	6198	Frame cpl	1	1	1	-	-	-
	6360	Frame cpl	-	-	-	1	1	1
2	6207	Swing arm	1	1	1	-	-	-
	6375	Swing arm	-	-	-	1	1	1
3	3932	Needle cage HK 2030	2	2	2	2	2	2
4	1930	O ring	4	4	4	1	1	1
5	1931	Bush for swing arm	2	2	2	2	2	2
6	1932	Guide plate for swing arm	2	2	2	2	2	2
7	1732	Washer B 6.4 Din 125	2	2	2	2	2	2
8	1575	Hexagon screw M 6x60 Din 931	1	1	1	1	1	1
9	1690	Hexagon nut NM 6x60 Din 980	1	1	1	1	1	1
10	1933	Chain guide plate right hand	1	1	1	1	1	1
11	1934	Chain guide plate left hand	1	1	1	-	-	-
	2287	Chain guide plate left hand	-	-	-	1	1	1
12	1935	Plastic plate for chain guide	2	2	2	2	2	2
13	1936	Spacer bush for chain guide	3	3	3	3	3	3
14	1937	Roller for chain guide	2	2	2	2	2	2
15	1580	Hexagon screw M 6x45 Din 933	2	2	2	2	2	2
16	1704	Spring ring B 6 Din 127	2	2	2	2	2	2
17	1500	Hexagon screw M 6x40 Din 931	1	1	1	1	1	1
18	1732	Washer B 6,4 Din 125	2	2	2	2	2	2
19	1690	Hexagon nut M 6 Din 980	1	1	1	1	1	1
20	6141	Rear shock cpl	2	2	2	-	-	-
	6368	Rear shock cpl	-	-	-	2	2	2
21	1942	Upper spring cup	1	1	1	-	-	-
	6369	Upper spring cup	-	-	-	1	1	1
22	1943	Lower spring cup	1	1	1	-	-	-
	6370	Lower spring cup	-	-	-	1	1	1
23	1944	Circlip SW 40	1	1	1	-	-	-
	6371	Circlip	-	-	-	1	1	1
24	1945	Guide ring for spring	1	1	1	-	-	-
	6372	Guide ring for spring	-	-	-	1	1	1
25	6139	Spring long	1	1	1	-	-	-
	6373	Spring long	-	-	-	1	1	1
26	1947	Spring short	1	1	1	-	-	-
	6374	Spring short	-	-	-	1	1	1
27	1948	Bush	2	2	2	-	-	-
28	1940	Silent bloc	2	2	2	-	-	-
29	3937	Swing arm spindle	1	1	1	1	1	1
30	1718	Spring washer B 14 Din 137	1	1	1	1	1	1
31	5011	Hexagon nut NM 14x1.5 Din 980-8	1	1	1	1	1	1
32	1594	Hexagon screw M 8x40 Din 931	4	4	4	4	4	4

Picture No.	Part No.	Description	MC 250	MC 400	MC 440	GS 250	GS 400	GS 440
33	1734	Washer B 8,4 Din 125	8	8	8	8	8	8
34	1692	Self locking nut M 8 Din 980	4	4	4	4	4	4
35	6143	Rear fender	1	1	1	-	-	-
	6380	Rear fender	-	-	-	1	1	1
36	1571	Hexagon screw M 6x30 Din 931	4	4	4	4	4	4
37	1732	Washer B 6,4 Din 125	4	4	4	4	4	4
38	1750	Washer 6,4 Din 9021	8	8	8	8	8	8
39	1690	Self locking nut NM 6 Din 980	4	4	4	4	4	4
40	6156	Front brake lever	1	1	1	1	1	1
41	1570	Hexagon screw M 6x25 Din 933	1	1	1	1	1	1
42	1667	Hexagon nut M 6 Din 934	1	1	1	1	1	1
43	6158	Bush for brake lever	1	1	1	1	1	1
44	1977	Rear brake rod	1	1	1	1	1	1
45	1732	Washer B 6,4 Din 125	1	1	1	1	1	1
46	1690	Self locking nut NM 6 Din 980	1	1	1	1	1	1
47	406	Ventilation hose	X	X	X	X	X	X
48	237	Clamp	1	1	1	1	1	1
49	1527	Cylinder head screw M 4x10 Din 84	1	1	1	1	1	1
50	1702	Spring ring B 4 Din 127	1	1	1	1	1	1
51	1665	Hexagon nut M 4 Din 934	1	1	1	1	1	1
52	236	Extension spring	1	1	1	1	1	1
53	1667	Hexagon nut M 6 Din 934	1	1	1	1	1	1
54	242	Pressure spring	1	1	1	1	1	1
55	1732	Washer B 6,4 Din 125	1	1	1	1	1	1
56	244	Nipple holder	1	1	1	1	1	1
57	243	Wing nut	1	1	1	1	1	1
58	1500	Hexagon screw M 6x40 Din 931	1	1	1	1	1	1
59	1732	Washer B 6,4 Din 125	1	1	1	1	1	1
60	1690	Hexagon nut NM 6 Din 980	1	1	1	1	1	1
61	6160	Tank	1	1	1	-	-	-
	6386	Tank	-	-	-	1	1	1
62	6161	Maico emblem, left hand	1	1	1	1	1	1
63	6162	Maico emblem, right hand	1	1	1	1	1	1
64	2228	Tank cap	1	1	1	1	1	1
65	406	Gasoline hose	X	X	X	X	X	X
66	2831	Gasoline tap	1	1	1	1	1	1
67	2832	Hose clip	1	1	1	1	1	1
68	3527	Rubber pad for tank	1	1	1	1	1	1
69	3522	Rubber pad for tank rear	1	1	1	1	1	1
70	3866	Moulded rubber mount	2	2	2	2	2	2
71	5348	Bush for tank	2	2	2	2	2	2
72	5344	Rubber ring for tank	2	2	2	2	2	2
73	1734	Washer B 8,4 Din 125	2	2	2	2	2	2
74	1604	Hexagon screw M 8x90 Din 931	1	1	1	1	1	1
75	1692	Self locking nut NM 8 Din 980	1	1	1	1	1	1

Picture No.	Part No.	Description	MC 250	MC 400	MC 440	GS 250	GS 400	GS 440
76	3397	Tension ring	1	1	1	1	1	1
77	5192	Seat cpl (low)	1	1	1	1	1	1
	5200	Seat cpl (high)	1	1	1	1	1	1
78	5391	Seal low less pos 85 & 86	1	1	1	1	1	1
	6392	Seat cpl high less pos 85 & 86	1	1	1	1	1	1
79	5193	Seat base	1	1	1	1	1	1
80	5194	Seat padding (low)	1	1	1	1	1	1
	5199	Seat padding (high)	1	1	1	1	1	1
81	5195	Seat cover	1	1	1	1	1	1
82	286	Clamp holder for seat	1	1	1	1	1	1
83	1704	Spring washer B 6 Din 127	2	2	2	2	2	2
84	1567	Hexagon screw M 6x16 Din 933	2	2	2	2	2	2
85	5197	Seat bracket	1	1	1	1	1	1
86	1728	Self locking screw	4	4	4	4	4	4
87	1568	Hexagon screw M 8x18 Din 933	1	1	1	1	1	1
88	1592	Hexagon screw M 8x30 Din 933	1	1	1	1	1	1
89	1749	Washer 8,4 Din 9021	3	3	3	3	3	3
90	1734	Washer B 8,4 Din 125	1	1	1	1	1	1
91	1692	Self locking nut NM 8 Din 980	2	2	2	2	2	2
92	6228	Foot rest right hand cpl	1	1	1	1	1	1
93	6234	Foot rest left hand cpl	1	1	1	1	1	1
94	6237	Foot rest spring right hand	1	1	1	1	1	1
95	6238	Foot rest spring left hand	1	1	1	1	1	1
96	6239	Bush for foot rest	2	2	2	2	2	2
97	6240	Socket screw M 10x25 Din 6912	2	2	2	2	2	2
98	1692	Self locking nut NM 8 Din 980	2	2	2	2	2	2
99	2258	Air filter box	1	1	1	1	1	1
100	2485	Rubber ring for filter box	1	1	1	1	1	1
101	2259	Flange for air box outside	1	1	1	1	1	1
102	5153	Foam ring	1	1	1	1	1	1
103	3183	Flange for air box	1	1	1	1	1	1
104	3184	Spacer tube	1	1	1	1	1	1
105	1667	Hexagon nut	1	1	1	1	1	1
106	3181	Foam filter	1	1	1	1	1	1
107	3164	Air filter body	1	1	1	1	1	1
108	1750	Washer 6,4 Din 9021	1	1	1	1	1	1
109	2260	Wing nut	1	1	1	1	1	1
110	343	Rubber sleeve	1	1	1	1	1	1
111	348	Clamp	1	1	1	1	1	1
112	683	Clamp	5	5	5	5	5	5
113	5204	Foam seal	X	X	X	-	-	-
114	2261	Strengthening plate for filter box	2	2	2	-	-	-
115	1569	Hexagon screw M 6x20 Din 9021	1	1	1	1	1	1
116	1750	Washer 6,4 Din 9021	1	1	1	1	1	1
117	2708	Rubber washer	1	1	1	1	1	1

Picture No.	Part No.	Description	MC	MC	MC	GS	GS	GS
			250	400	440	250	400	440
118	1732	Washer B 6,4 Din 125	1	1	1	1	1	1
119	1690	Self locking nut NM 6 Din 980	1	1	1	1	1	1
120	6241	Splash guard	1	1	1	-	-	-
	6286	Splash guard	-	-	-	1	1	1
121	1567	Hexagon screw M 6x16 Din 933	4	4	4	4	4	4
122	1750	Washer 6,4 Din 9021	6	6	6	6	6	6
123	1732	Washer B 6,4 Din 125	2	2	2	2	2	2
124	1690	Self locking nut NM 6 Din 980	4	4	4	4	4	4
125	5204	Foam seal	X	X	X	X	X	X
126	2264	Side panel left side	1	1	1	1	1	1
127	6244	Number plate transfers green	2	-	-	-	-	-
	6264	Number plate transfers yellow	-	2	2	2	2	2
128	6246	Side panel right side	1	1	1	1	1	1
129	5029	Spacer washer for side panel	6	6	6	6	6	6
130	2708	Rubber washer	6	6	6	6	6	6
131	3711	Plastic screw	6	6	6	6	6	6
132	6247	Cable guide	1	1	1	-	-	-
133	6251	Front number plate	1	1	1	-	-	-
134	6252	Front number plate transfers green	1	-	-	-	-	-
	6261	Front number plate transfers Yellow	-	1	1	-	-	-
135	6265	Spring nut	2	2	2	-	-	-
136	3094	Sliding rollers	2	2	2	-	-	-
137	6253	Plastic screw	2	2	2	-	-	-
138	2277	Cylinder head stay right hand	1	-	-	-	-	-
	2282	Cylinder head stay right hand	-	1	1	-	1	1
139	2278	Cylinder head stay left hand	1	-	-	1	-	-
	2283	Cylinder head stay left hand	-	1	1	-	1	1
140	1591	Hexagon screw M 8x25 Din 933	1	1	1	1	1	1
141	1692	Self locking nut NM 8 Din 980	3	3	3	3	3	3
142	1734	Washer B 8,4 Din 125	4	4	4	4	4	4
143	1592	Hexagon screw M 8x30 Din 933	2	2	2	2	2	2
144	1714	Spring washer B 8 Din 137	2	2	2	2	2	2
145	6254	Set of engine bolts pos 146,147,148	1	1	1	1	1	1
146	1610	Hexagon screw M 8x120 Din 931	2	2	2	2	2	2
147	1734	Washer B 8,4 Din 125	4	4	4	4	4	4
148	1700	Self locking nut NM 8 Din 980	2	2	2	2	2	2
149	6267	Plastic clip	2	2	2	2	2	2
150	6274	Exhaust system cpl	1	-	-	-	-	-
	6278	Exhaust system cpl	-	1	1	-	-	-
	6394	Exhaust system cpl D, GB, I, F, B	-	-	-	1	-	-
	6395	Exhaust system cpl USA	-	-	-	1	-	-
	6399	Exhaust system cpl D, GB, I, F, B	-	-	-	-	1	1
	6400	Exhaust system cpl USA	-	-	-	-	1	1
151	6272	Exhaust system, welded	1	-	-	-	-	-

Picture No.	Part No.	Description	MC	MC	MC	GS	GS	GS
			250	400	440	250	400	440
	6277	Exhaust system, welded	-	1	1	-	1	1
	6390	Exhaust system, welded D, GB, I, F, B	-	-	-	1	-	-
151.1	5651	Connecting tube for silencer	-	-	-	1	-	-
	5665	Connecting tube for silencer	-	-	-	-	1	1
152	5466	Silencer cpl	1	-	-	-	-	-
	5485	Silencer cpl	-	1	1	-	-	-
	5656	Silencer cpl	-	-	-	1	1	1
153	5465	Silencer, welded	1	-	-	-	-	-
	5484	Silencer, welded	-	1	1	-	-	-
154	5155	Exhaust padding	-	1	1	-	-	-
	3557	Exhaust padding	1	1	1	-	-	-
155	5311	End cap	1	1	1	-	-	-
156	1859	Retaining ring 60x2 Din 472	X	X	X	X	X	X
157	896	Asbestos cord	1	1	1	1	1	1
158	6275	Pressure spring	1	1	1	1	1	1
159	6276	Spacer tube	1	1	1	1	1	1
160	1750	Washer 6,4 Din 9021	1	1	1	1	1	1
161	1523	Hexagon screw M 8x70 Din 912	1	1	1	1	1	1
162	1750	Washer 6,4 Din 9021	2	2	2	2	2	2
163	1166	Silent bloc for exhaust	2	2	2	2	2	2
164	1732	Washer B 6,4 Din 125	2	2	2	2	2	2
165	1690	Self locking nut NM 6 Din 980	4	4	4	4	4	4
166	5430	Washer	2	2	2	2	2	2
167	1750	Washer 6,4 Din 9021	2	2	2	2	2	2
168	1704	Spring ring B 6 Din 127	2	2	2	2	2	2
169	1525	Hexagon screw M 6x14 Din 932	1	-	-	1	1	1
170	5429	Clamp SP 28/15	-	1	1	-	-	-
	5474	Clamp SP 35/15	-	1	1	-	-	-
171	5453	Bush for silencer securing bolt	1	1	1	1	1	1
172	5345	Rubber washer	2	2	2	2	2	2
173	325	Plastic cable clip	8	8	8	8	8	8

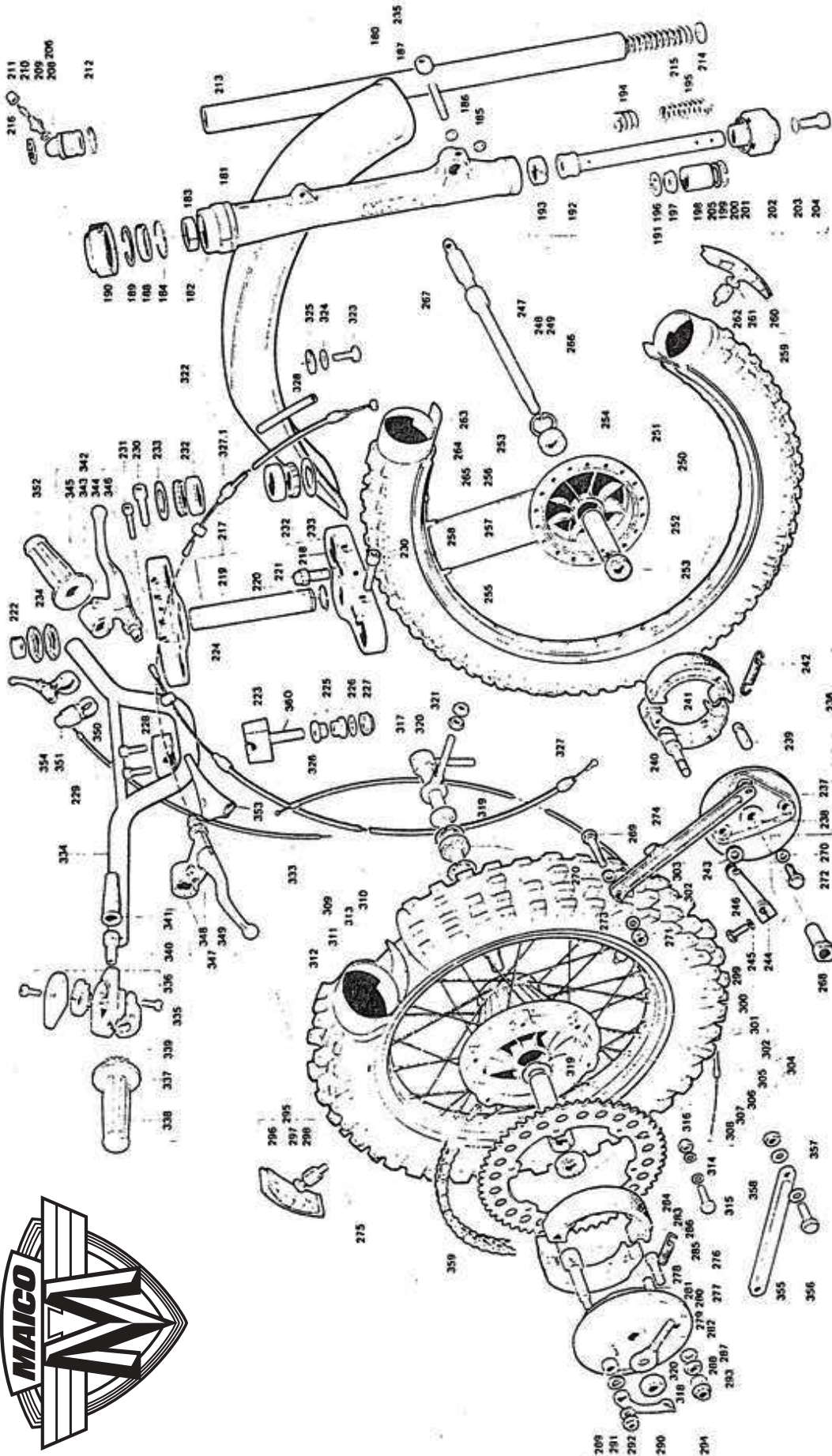

Picture No.	Part No.	Description	MC	MC	MC	GS	GS	GS
			250	400	440	250	400	440
			Quantity					
180	6221	Fork leg cpl	2	2	2	2	2	2
181	2170	Slider tube	2	2	2	2	2	2
182	2166	Slider tube with bush	2	2	2	2	2	2
183	2168	Guide bush for main tube	2	2	2	2	2	2
184	2169	Circlip for fork	2	2	2	2	2	2
185	1734	Washer B 8,4 Din 125	4	4	4	4	4	4
186	1783	Stud M 8x30 Din 939	2	2	2	2	2	2
187	1692	Self locking nut NM 8 Din 980	2	2	2	2	2	2
188	2171	Sealing ring RP 37.8x48x6	2	2	2	2	2	2
189	2172	Circlip	2	2	2	2	2	2
190	3907	Sealing ring	2	2	2	2	2	2
191	6216	Damper cpl	2	2	2	2	2	2
192	6215	Damper tube	2	2	2	2	2	2
193	3789	Piston ring for damper	2	2	2	2	2	2
194	2179	Counter spring hard	2	2	2	2	2	2
195	2181	Counter spring soft	2	2	2	2	2	2
196	3369	Valve seat	2	2	2	2	2	2
197	3368	Valve	2	2	2	2	2	2
198	3367	Damper insert	2	2	2	2	2	2
199	3366	Retaining ring 34x1.5 Din 472	2	2	2	2	2	2
200	6217	Bush for damper tube	2	2	2	2	2	2
201	1902	O-ring	2	2	2	2	2	2
202	2183	Damper plug	2	2	2	2	2	2
203	430	Sealing ring A 8x14 Din 7603	2	2	2	2	2	2
204	1653	Socket screw M 8x20 Din 912	2	2	2	2	2	2
205	3777	Spacer washer 0.3	When needed					
	3778	Spacer washer 0.5	When needed					
206	6218	Fork plug cpl	2	2	2	2	2	2
207	6219	Fork plug	2	2	2	2	2	2
208	277	Sealing ring A 8x11.5 Din 7603	2	2	2	2	2	2
209	2185	Air valve body	2	2	2	2	2	2
210	2186	Air valve insert	2	2	2	2	2	2
211	2187	Air valve cap	2	2	2	2	2	2
212	6220	O-ring	2	2	2	2	2	2
213	6222	Main tube	2	2	2	2	2	2
214	2193	O-ring	1	1	1	1	1	1
215	2194	Fork spring	2	2	2	2	2	2
216	3366	Retaining ring 34x1.5 Din 472	2	2	2	2	2	2

Picture No.	Part No.	Description	MC 250	MC 400	MC 440	GS 250	GS 400	GS 440
217	3371	Lower cross head cpl	1	1	1	1	1	1
218	3372	Lower cross head	1	1	1	1	1	1
219	3373	Steering tube	1	1	1	1	1	1
220	3375	Circlip A 26 Din 7993	1	1	1	1	1	1
221	226	Locking bolt	2	2	2	2	2	2
222	5003	Plug for steering tube	1	1	1	1	1	1
223	2195	Lower handlebar clamp	2	2	2	2	2	2
224	3381	Upper cross head	1	1	1	1	1	1
225	15	Rubber buffer	4	4	4	4	4	4
226	1758	Washer	2	2	2	2	2	2
227	1693	Self locking nut NM 10 Din 980	2	2	2	2	2	2
228	88	Upper handlebar clamp	2	2	2	2	2	2
229	1646	Socket screw M 8x30 Din 912	4	4	4	4	4	4
230	1657	Socket screw M 10x40 Din 912	4	4	4	4	4	4
231	1650	Socket screw M 8x60 Din 912	2	2	2	2	2	2
232	3297	Roller bearing L44649/610	2	2	2	2	2	2
233	3296	Nilos ring	2	2	2	2	2	2
234	3533	Hexagon nut	2	2	2	2	2	2
235	6223	Front fork cpl	1	1	1	1	1	1
236	2239	Frone brake plate cpl	1	1	1	1	1	1
237	2236	Front brake plate with bush	1	1	1	1	1	1
238	2238	Bush for brake plate	1	1	1	1	1	1
239	2418	Pivot bolt	1	1	1	1	1	1
240	2419	Brake toggle	1	1	1	1	1	1
241	1322	Brake shoe	2	2	2	2	2	2
242	1323	Tension spring	2	2	2	2	2	2
243	187	Rubber washer	1	1	1	1	1	1
244	1324	Front brake lever	1	1	1	1	1	1
245	1704	Spring washer B 6 Din 127	1	1	1	1	1	1
246	1569	Hexagon screw M 6x20 Din 933	1	1	1	1	1	1
247	6146	Front wheel cpl	1	1	1	-	-	-
	5624	Front wheel cpl	-	-	-	1	1	1
248	2240	Front wheel with tire	1	1	1	-	-	-
	5623	Front wheel with tire	-	-	-	1	1	1
249	2235	Front wheel bare	1	1	1	-	-	-
	5622	Front wheel bare	-	-	-	1	1	1
250	2234	Front brake drum cpl	1	1	1	-	-	-
	5620	Front brake drum cpl	-	-	-	1	1	1
251	2233	Front brake drum	1	1	1	-	-	-
	5511	Front brake drum	-	-	-	1	1	1

Picture No.	Part No.	Description	MC 250	MC 400	MC 440	GS 250	GS 400	GS 440
252	2428	Spacer tube	1	1	1	1	1	1
253	2427	Ball bearing 6202	2	2	2	2	2	2
254	1853	Retainer ring	1	1	1	1	1	1
255	3497	Front rim	18	18	18	18	18	18
256	2432	Spoke short	18	18	18	18	18	18
257	2433	Spoke long	36	36	36	36	36	36
258	2242	Spoke nipple 4.5/M 4	1	1	1	1	1	1
259	168	Front tire holder cpl	1	1	1	1	1	1
260	2568	Front tire holder plate	1	1	1	1	1	1
261	1734	Washer B 8,4 Din 125	1	1	1	1	1	1
262	289	Nut for tire holder	1	1	1	1	1	1
263	2001	Rim strap 21"	1	1	1	1	1	1
264	2002	Inner tube 3.00x21"	1	1	1	1	1	1
265	2003	Front tire 3.00x21"	1	1	1	1	1	1
266	2247	Front axle	1	1	1	1	1	1
267	2250	Spacer bush	1	1	1	-	-	-
	5625	Spacer bush	-	-	-	1	1	1
268	2430	Threaded bush	1	1	1	1	1	1
269	1594	Hexagon screw M 8x40 Din 931	1	1	1	1	1	1
270	1734	Washer B 8,4 Din 125	2	2	2	2	2	2
271	1692	Self locking nut NM 8 Din 980	1	1	1	1	1	1
272	1589	Hexagon screw M 8x20 Din 933	1	1	1	1	1	1
273	1714	Spring washer B 8 Din 137	1	1	1	1	1	1
274	2424	Front brake arm	1	1	1	1	1	1
275	6290	Rear wheel cpl	1	1	1	1	1	1
276	3186	Rear brake plate cpl	1	1	1	1	1	1
277	3045	Rear brake plate with parts	1	1	1	1	1	1
278	3187	Rear brake plate	1	1	1	1	1	1
279	183	Spacer bush	2	2	2	2	2	2
280	3188	Cover plate	1	1	1	1	1	1
281	3189	Pivot bolt	1	1	1	1	1	1
282	1901	Oval head nail 3x8 Din 1476	1	1	1	1	1	1
283	151	Brake toggle	1	1	1	1	1	1
284	188	Brake shoe	2	2	2	2	2	2
285	6148	Tension spring	2	2	2	2	2	2
286	3270	Socket screw M 10x40 Din 6912	1	1	1	1	1	1
287	1715	Spring washer	1	1	1	1	1	1
288	1674	Hexagon nut M 10 Din 934	1	1	1	1	1	1

Picture No.	Part No.	Description	MC 250	MC 400	MC 440	GS 250	GS 400	GS 440
289	187	Rubber washer	1	1	1	1	1	1
290	3190	Rear brake lever	1	1	1	1	1	1
291	1734	Washer B 8,4 Din 125	2	2	2	2	2	2
292	1692	Self locking nut NM 8 Din 980	1	1	1	1	1	1
293	1735	Washer B 10.5 Din 125	1	1	1	1	1	1
294	1693	Self locking nut NM 10 Din 980	1	1	1	1	1	1
295	2434	Rear tire holder cpl	1	1	1	1	1	1
296	2567	Rear tire holder plate	1	1	1	1	1	1
297	1734	Washer B 8,4 Din 125	1	1	1	1	1	1
298	289	Nut for tire holder	1	1	1	1	1	1
299	3875	Rear brake drum cpl	1	1	1	1	1	1
300	3868	Rear brake drum	1	1	1	1	1	1
301	3872	Spacer bush rear cpl	1	1	1	1	1	1
302	205	Ball bearing 6303 2 RS C3	2	2	2	2	2	2
303	1852	Retaining ring 47x1.75	2	2	2	2	2	2
304	3876	Rear wheel bare	1	1	1	1	1	1
305	2405	Rear rim	1	1	1	1	1	1
306	2406	Spoke short	18	18	18	18	18	18
307	2407	Spoke long	18	18	18	18	18	18
308	2408	Spoke nipple	36	36	36	36	36	36
309	3343	Rear wheel with tire	1	1	1	1	1	1
310	2005	Rim strap 18"	1	1	1	1	1	1
311	2015	Inner tube 4.50x18'	1	1	1	1	1	1
312	2008	Tire 4.50x18"	1	1	1	1	1	1
313	3227	Rear wheel sprocket 56 T	1	1	1	-	-	-
	2200	Rear wheel sprocket 54 T	-	-	-	1	1	1
314	1713	Spring washer B 7 Din 137	16	16	16	16	16	16
315	3280	Hexagon screw M 7x40 Din 933	6	6	6	6	6	6
316	1691	Self locking nut NM 7 Din 980	6	6	6	6	6	6
317	3277	Rear axle cpl	1	1	1	1	1	1
318	1709	Self locking nut NM 15x1,5 Din 980	1	1	1	1	1	1
319	3880	Spacer ring	1	1	1	1	1	1
320	6287	Chain tensioner	2	2	2	2	2	2
321	1670	Hexagon nut M 8 Din 934	4	4	4	4	4	4
322	6142	Front fender	1	1	1	1	1	1
323	1569	Hexagon screw M 6x20 Din 933	4	4	4	4	4	4
324	1750	Washer 6,4 Din 9021	4	4	4	4	4	4
325	2708	Rubber washer	4	4	4	4	4	4

Picture No.	Part No.	Description	MC 250	MC 400	MC 440	GS 250	GS 400	GS 440
326	2456	Throttle cable	1	1	1	1	1	1
327	6150	Clutch cable	1	1	1	1	1	1
327.1	486	Brake cable	1	1	1	1	1	1
328	2275	Isolation hose B 8x0.7 Din 40621	X	X	X	X	X	X
333	315	Decompression cable	-	1	1	-	1	1
334	2230	Handlebar, high black	1	1	1	1	1	1
335	6261	Throttle grip cpl	-	-	-	1	1	1
336	6283	Throttle grip housing	1	1	1	1	1	1
337	6285	Throttle tube with cover	1	1	1	1	1	1
338	2148	Throttle grip, rubber	1	1	1	1	1	1
339	6284	Throttle cam	1	1	1	1	1	1
340	2211	Throttle stop screw	1	1	1	1	1	1
341	2212	Rubber sleeve for stop screw	1	1	1	1	1	1
342	2215	Hand clutch lever cpl	1	1	1	-	-	-
	3630	Hand clutch lever cpl	-	-	-	1	1	1
343	2213	Hinge for hand clutch lever	1	1	1	-	-	-
	2223	Hinge for hand clutch lever	-	-	-	1	1	1
344	2216	Hand clutch lever	1	1	1	1	1	1
345	133	Lever screw with nut	2	2	2	2	2	2
346	212	Adjusting scrwe with nut	2	2	2	2	2	2
347	2218	Hand brake lever cpl	1	1	1	1	1	1
348	2217	Hinge for hand brake lever with screw	1	1	1	1	1	1
349	2219	Hand brake lever	1	1	1	1	1	1
350	2220	Kill button cpl	1	1	1	1	1	1
351	2221	Rubber cap	1	1	1	-	-	-
352	2512	Rubber grip	1	1	1	-	-	-
353	3166	Lever cover	1	1	1	1	1	1
	6169	Lever cover	2	2	2	1	1	1
354	148	Decompression lever cpl	-	-	-	1	1	1
355	1978	Rear brake torque arm	1	1	1	-	1	1
356	1591	Hexagon screw M 8x25 Din 933	1	1	1	1	1	1
357	1734	Washer B 8,4 Din 125	2	2	2	2	2	2
358	1692	Self locking nut NM 8 Din 980	1	1	1	1	1	1
359	2281	Rear chain	1	1	1	1	1	1

MAICO SERVICE BULLETIN

NO: 1/78

RE: 'T' HOOKED RATCHET

ALL MAGNUM ENGINES HAVE A NEW 'T-HOOKED RATCHET'.

THE HOOKED RATCHET SHOULD HAVE FREE MOVEMENT TO AVOID HARD SHIFTING. HARD SHIFTING CAUSES THE GEARS NOT TO ENGAGE IN PROPER POSITION; LEAVING THE DOGS NOT FULLY ENGAGED AND ROUNDING OFF PREMATURELY.

HOOKED RATCHET STAMPED 'T' - PART NO: 3326:

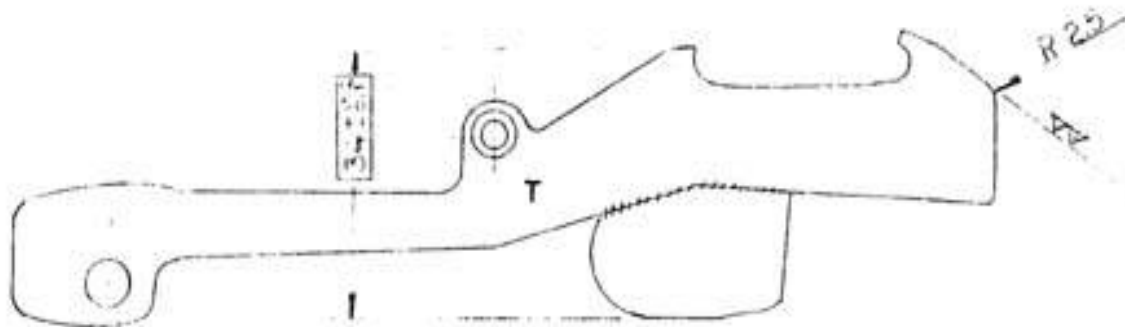

IMPORTANT: CHECK THE HOOKED RATCHET FOR FREE MOVEMENT WHILE UPSHIFTING FROM FIRST TO FIFTH GEAR. IF IT JAMS, THE MEASUREMENT 34 $\begin{matrix} +0.2 \\ -0.1 \end{matrix}$ SHOULD BE REDUCED TO LOWEST TOLERANCE (33.9).

IF THIS IS STILL NOT SUFFICIENT, MARKED SURFACE SHOULD BE GROUND UNTIL HOOKED RATCHET MOVES FREELY. (SURFACE MARKED ∇)

HOOKED RATCHET SHOULD ALSO MOVE FREELY IN THE HOOKED RATCHET GROOVE AND SHOULD NOT JAM AGAINST THE HOOKED RATCHET COVER PLATE.

NOTE: SCREWS FOR BLACK HOOKED RATCHET COVER PLATE MUST BE LOCKTITED. (DO NOT LOCK SCREW WITH PUNCH).

SCREWS FOR BROWN OR GRAY HOOKED RATCHET COVER PLATES MUST BE LOCKED WITH CENTER PUNCH.

CAUTION:

DO NOT USE HAMMER ON CLUTCH LOCK WASHER TOOL TO SECURE THE CLUTCH WASHER ON MAGNUM ENGINES. BEND LOCK WASHER CAREFULLY WITH TOOL BY APPLYING 2-WAY PULLER.

IN ORDER TO AVOID DAMAGE OF THE CLUTCH BEARING HOLDING PLATE, NEVER HIT THE CLUTCH BEARING.

TD:SN
DECEMBER 1, 1977

TECHNICAL SERVICE DEPT. USA



MAICO SERVICE BULLETIN NO: 2/78

RE: FLOAT LEVEL ADJUSTMENT

The float level should be adjusted so that a constant fuel level is maintained in the float bowl.

Proper adjustment is achieved by bending the hinge (up or down) so that:

- a) Float elements are parallel to float chamber surface.
- b) Hinge just touches float needle without compressing it.

FLOAT:

Light weight float has been introduced in all new model carburetors. It is only half of the weight of the previous model floats.

Purpose of the new float:

- 1. Higher closing force on the feed valve.
- 2. Stable fuel level even with heavy engine vibrations or movements.
- 3. Less fuel loss through foaming.
- 4. Constant fuel consumption even under extremely adverse operating conditions.
- 5. Stainless steel hinges: No corrosion, reduced wear of contact areas.

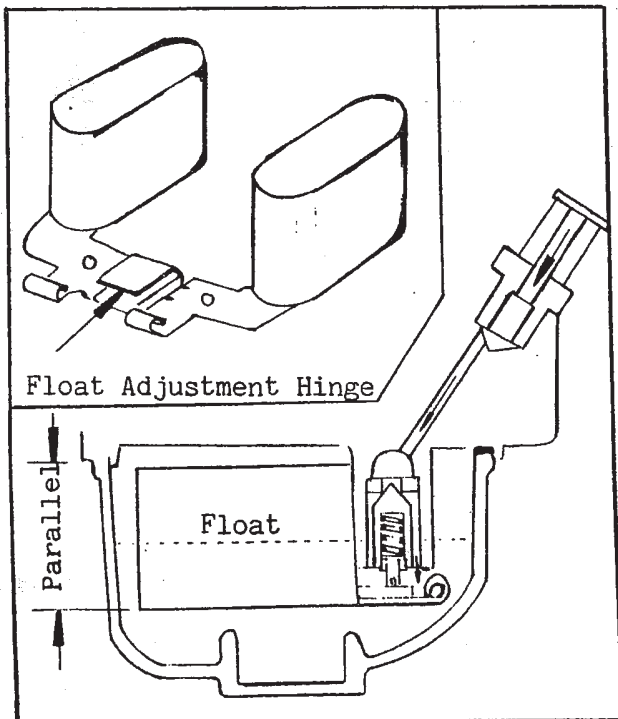

JETTING CHART:

	125cc	250cc	400cc	450cc
Main jet	150	170-175	170-175	170-175
Needle jet	280	322-324	322-324	326-324
Pilot jet	35-40	75-78	75-78	75-78
Needle	#1	#1	#1	#1
Slide	#1	#140-1		
Air Screw	1/2-3/4	1/2-3/4 Turn		

TD:SN

JANUARY 20, 1978

TECHNICAL SERVICE DEPT. USA



MAICO SERVICE BULLETIN NO: 3/78

AIR FORK:

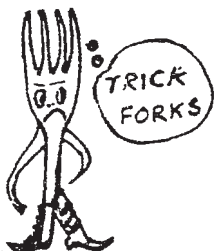
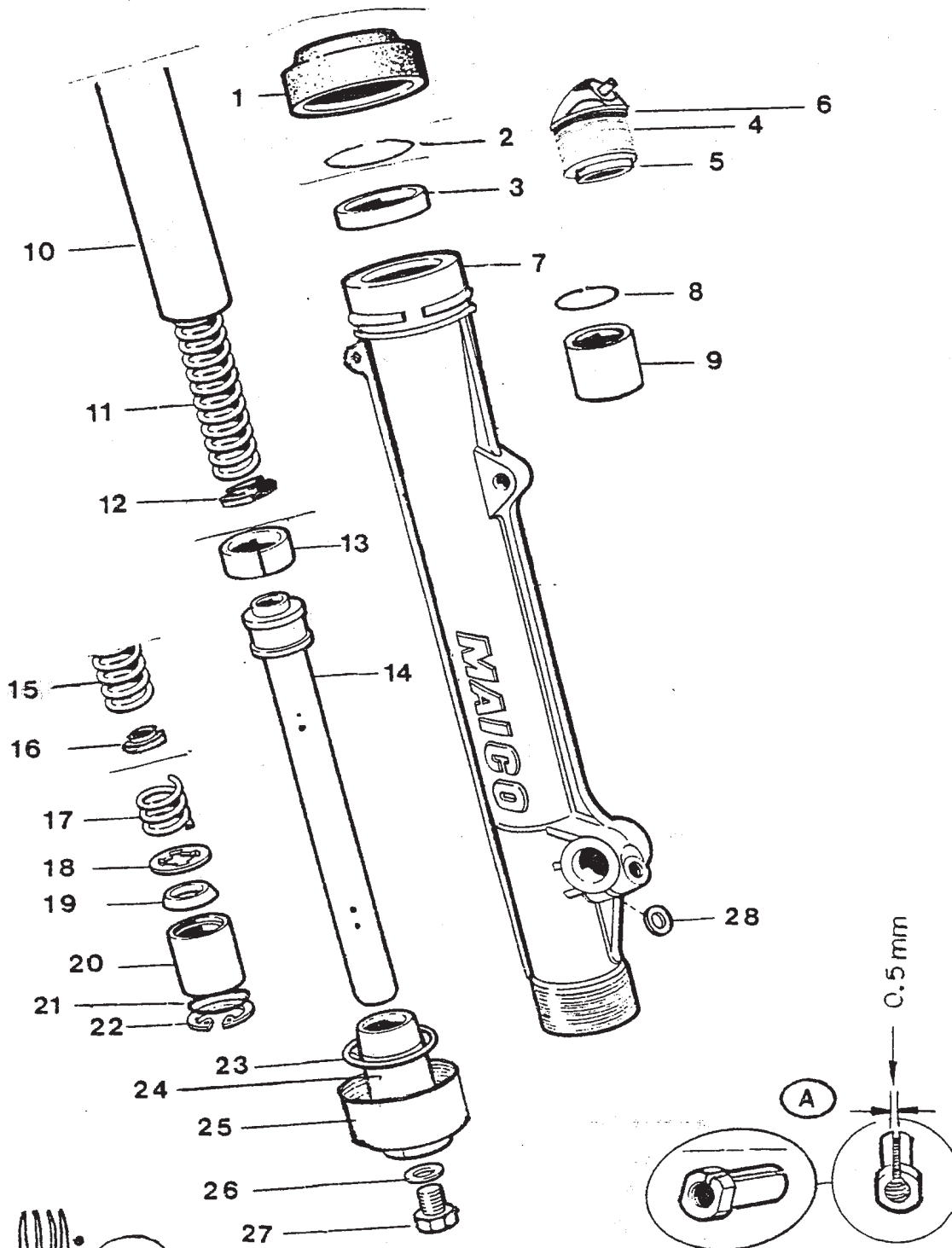

- (A) Slot the threaded bush (front axle nut) with hacksaw blade and align the slot with fork slider slot. Purpose: To better secure front axle; for easy installation of front fork.

SERVICE BULLETIN NO: 3/78

PAGE TWO

AIR FORK PARTS LIST:

<u>Figure No.</u>	<u>Part No.</u>	<u>Description</u>
1	3907	Wiper Seal
2	2172	Snap ring
3	2171	Fork seal
4	2188	Fork cap
5	2190	Plastic spacer
6	80	'O' Ring
7	2166	Fork slider
8	2169	Lock ring
9	2168	Guide bush
10	3790	Fork tube
11	2194	Fork spring 4mm Ø
12	2193	Spacer
13	3789	Teflon ring
14	2176	Damper tube
15	2179	Rebound spring Hard
16	2180	Spacer
17	2181	Rebound spring Soft
18	3369	Washer
19	3368	Valve
20	3367	Inserting bush
21	a 3377	Shim 0.3mm
	b 3378	Shim 0.5mm
22	3366	Circlip
23	1902	'O' Ring
24	2182	Damper cone
25	2183	Threaded sleeve
26	430	Sealing ring
27	1652	Socket screw M8 x 20
28	1714	Wave washer

RE: Air Fork - Basic Service and Overhaul Instructions:

The front fork should be assembled and maintained properly in order to achieve the best active performance of the front fork.

Dismantling:

1. Loosen the fork slider pinch nuts and loosen the front axle. Do not attempt to loosen or remove the front axle nut (threaded bush).
2. Remove the front wheel and front brake cable and backing plate.
3. Remove number plate, loosen the triple clamp pinch bolts and remove the fork assembly.
4. Depressurize the fork (remove the air) and loosen the fork cap, and remove spring.
5. Loosen the threaded sleeve and drain the oil.
6. Disconnect the circlip and remove the dampening unit.
NOTE: Damper tube is pressed into the damper cone and threaded sleeve and held by a socket screw.
7. Remove the fork tube from the slider. Remove fork tube always upwards to avoid seal damage, and insert the fork tube, circlip end through the fork seal first.

Cleaning and Inspection:

Clean the parts carefully with solvent.

1. Check the 'O' Rings for damage.
2. Check the teflon ring for friction free operation and proper sealing in the fork tube (replace if necessary).
3. Check the fork tubes for bend (replace if necessary).
(Fork tube should slide freely through fork slider.)
4. Fork tube chrome surfaces should be checked for scars and scratches.
5. The fork seals and the wiper seals should be checked for damage or leakage.
(Replace if necessary.)

RE: Assembly:

1. Lubricate the oil seal and the wiper seal with grease and oil the fork slider.
2. Insert the fork tube through the fork slider and check for free movement.
3. Insert the dampening rod and secure the circlip.
4. Apply antiseize or grease on the threaded sleeve threads and tighten carefully
5. Use 360cc oil for each fork leg (LT 100 or LT 200 Bel-Ray fork oil). Oil level should be measured 16cm from the top edge of the fork tube when fork tube is compressed without spring.

SERVICE BULLETIN NO.: 3/78

PAGE FOUR

6. Insert the fork spring.
7. Lubricate the fork cap threads and tighten the fork cap.
8. Fill up the fork with (14 psi) air.

NOTE: Do not apply high pressure air on the forks; causes fork seal damage.
Check for air leak on the valves (tighten or replace if necessary).

9. Clean triple clamps - must be free of grease.
10. Insert the fork assembly and tighten the triple clamp bolts.
11. Insert the front wheel, backing plate, front axle, backing plate bolt, and tighten the front axle. (Align the threaded bush slot with the fork slider slot.)

NOTE: Front brake cable should be taped to fork slider to avoid it from catching on the tire when front fork is compressed.

12. Apply the front brake and push the front fork a few times. Tighten the fork slider pinch bolts and backing plate bolts.

NOTE: Oil capacity and air pressure can be varied depending on body weight and track conditions. (+ 20cc oil volume; + 2.8 Psi air pressure.)

Less oil softer fork. Less air pressure softer fork.
More oil harder fork. More air pressure harder fork.

These maintenance procedures should be followed by the rider or the mechanics for every major overhaul of the bike.

TECHNICAL SERVICE DEPT. U.S.A.
January 20, 1978

MAICO SERVICE BULLETIN

NO: 4/78

D. TIMING ADJUSTMENT PROCEDURE:

1. Remove the magnet cover.
2. Remove the spark plug.
3. Insert the dial indicator.
4. Turn the magneto rotor clockwise.
5. Before the piston reaches the top dead center, (watch the dial indicator for measurement) timing specifications should be measured by the dial indicator (BTDC). Magnum 250 = 1.7-2.0mm ; Magnum 400-450 = 2.2-2.5mm.
6. While the specified measurement reached in the dial indicator BTDC, or turning the magneto counter clockwise from top dead center to the specified timing measurement; in this position, the mark on the stator place should match the mark on the magneto rotor. (See sketch A.)
7. In order to retard or advance the ignition, turn the stator unit by means of loosening the socket screws. (See sketch B.)
8. To retard the timing, turn the stator in the clockwise direction; to advance the timing, turn the stator plate counter clockwise.
9. Tighten the socket screws.
10. Check the spark with spark plug plug for spark.
11. Tighten the spark plug (when engine is cold).
12. Check the magnet nut for proper torque (6.5 mkp - 47 ft.lb.) left handed thread.
13. Close the mag cover and tighten the mag cover carefully.

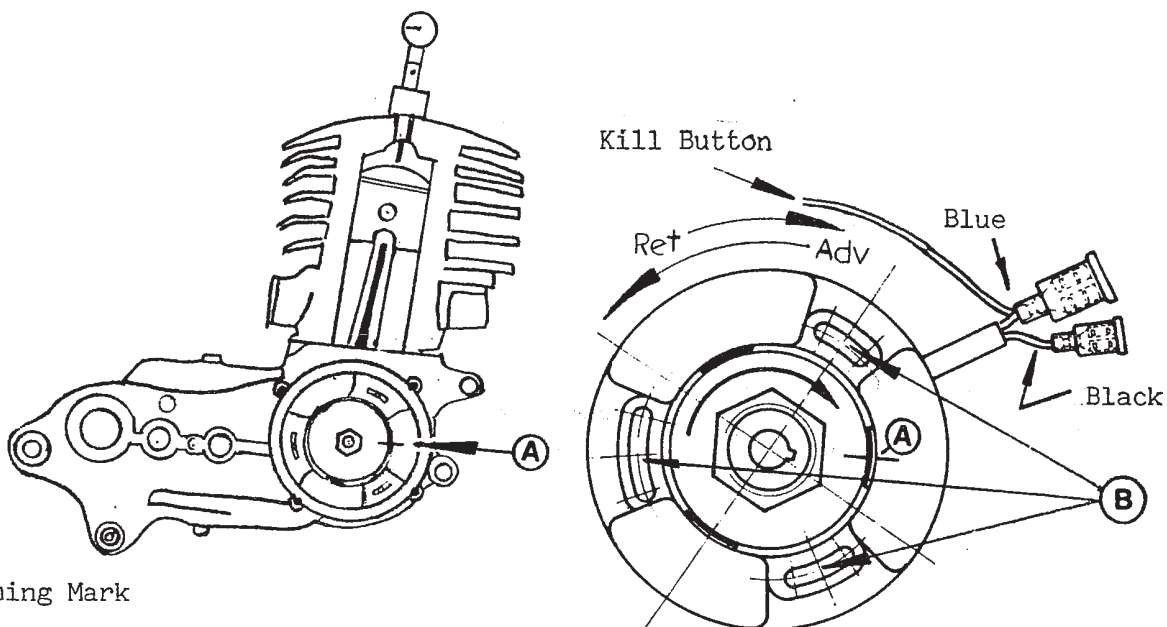

Ⓐ Timing Mark

Ⓑ Stator Unit Adjusting Socket Screws

TD:SN - TECHNICAL SERVICE DEPT. U.S.A.
JANUARY 20, 1978

MAICO SERVICE BULLETIN

NO: 5/78

RE: MAGNUM 250 - 400 - 450 TRANSMISSION CHART:

Type	1st Gear	2nd Gear	3rd Gear	4th Gear	5th Gear	Sleeve Pinion
MT 250	Mainshaft MT **2025					
	*M 19T **3441	*M 21T **3440	*M 24T **3434	*MG 26T **3435	*MT 28T **2039 Brg 905	*MT 28T **2037
Layshaft *M 17T **3437						
	*M1 26T ** 3438 Brg 905	*M1 23T ** 3439 Brg. 3757	*M 21T *M 19T Twin Block **3442			

Type	1st Gear	2nd Gear	3rd Gear	4th Gear	5th Gear	Sleeve Pinion
RT 400 450	Mainshaft MT **2025					
	*G 17T **3449	*G 20T **3448	*R 23T **3967	*MG 26T **3435	*MT 28T **2039 Brg 905	*MT 28T **2037
Layshaft *M 17T **3437						
	*G1 28T ** 3446 Brg 905	*G1 24T ** 3447 Brg 3757	*M 21T *M 19T Twin Block **3442			

*Type number of teeth on gear.

**Part number of gear.

Brg: Bearing & Part number.

Transmission Shimming:

QTY.	PART NO.	PLACE USED
2	3893	On the top of 1st gear on the layshaft.
1	3723	On the bottom of the 1st gear on the layshaft.
1	3893	On bottom of the layshaft.
1	3723	On the top of 5th gear on mainshaft.
1	3893	On the bottom of the 5th gear mainshaft.
1	3893	On top of the output shaft (sleeve pinion).

TD:SN
JANUARY 20, 1978

TECHNICAL SERVICE DEPT. USA.



MAICO SERVICE BULLETIN NO: 6-78

Short Service Information for 1978 Magnum Models.

RE: Front hub and magnesium backing plate changes:

Front hub	New 111 mm wide	Old 112 mm wide
Front backing plate	New 21 mm long	Old 22 mm long
Front axle	New Head threaded	Old Head welded

Backing plate with 22 mm bush can be used with new hub (Part No: 2233).
 If backing plate with 21 mm bush is used with old hubs, it is necessary to install 1 mm washer in between backing plate and the hub, or insert 22 mm bush (Part No: 5150) in the backing plate. Otherwise, the backing plate will rub the hub and cause damage.

NOTE: Heat the backing plate to remove the bush and install the bush.

RE: Front wheel spoke nipples.

Front wheel spoke nipples on the magnum are larger (0.5mm) outside diameter.
 Old spoke nipple - Part No: 210.
 New spoke nipple - Part No: 2242 (M 4 threads).

To install new nipples (Part No: 2242) in the old rims, it is necessary to drill the rims (0.5mm) larger.

CAUTION: DO NOT INSTALL OLD NIPPLES (PART NO: 210) ON THE NEW MAGNUM RIMS.
 IT COULD CAUSE SERIOUS DAMAGE TO THE FRONT WHEEL.

Front spokes part number remains unchanged.
 Front spokes left side (long) Part No: 2433.
 Front spokes right side (short) Part No: 2432.



Sn

Bike problem - call us!
 Your problems - call the doctor.



PAGE 1

MAICO SERVICE BULLETIN

NO: 6-78
(Cont'd)

RE: Rear wheel spokes and spoke nipples.

Rear wheel spoke and nipples are strengthened on the Magnum models. These spokes can be used on previous hubs. (Drill the hubs to $\varnothing 5.2\text{mm}$ larger and also drill the rims (0.5mm) larger.)

Rear spokes right side (short)	Part No: 2406
Rear spokes left side (long)	Part No: 2407
Rear spoke nipples M4.5	Part No: 2408

CAUTION: Never install the previous nipples (Part No: 210) on the new (Magnum) rims. It could cause serious damage to the rear wheel.

NOTE: When installing the previous spokes (4mm) with new rims, use the front spoke nipples (Part No: 2242) outside diameter is larger but inside threads are M4.

RE: Air Fork - Fork Sliders - Dampening Rod:

Fork slider guide bush (Part No: 2168) should be installed by tight fitting. (Do not heat the fork slider.)

Heat the damper cone (Part No: 2182) slightly to dismantle or assemble the damper tube. Let the damper cone cool before assembling into the threaded bush.

NOTE: Damper tube is pressed into the damper cone and held by a hexagon screw.

PAGE TWO



MAICO SERVICE BULLETIN NO:6-78 (Cont'd)

1. Handlebar mountings tapings.

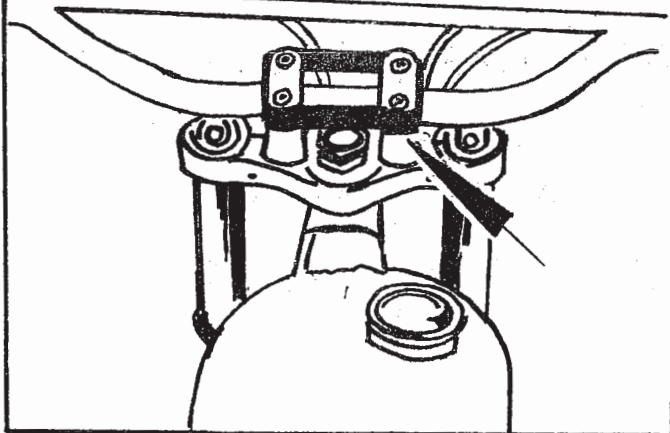

3. Ignition wire route.

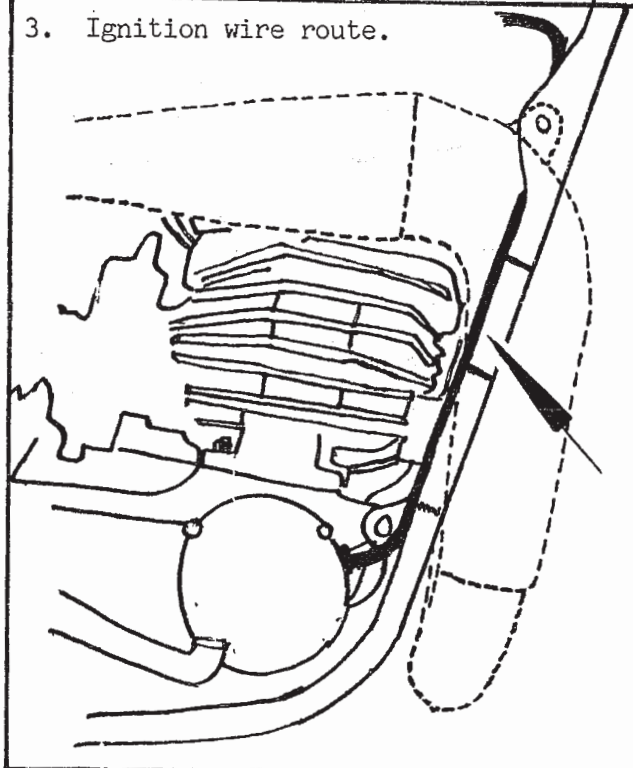

2. Front brake route.

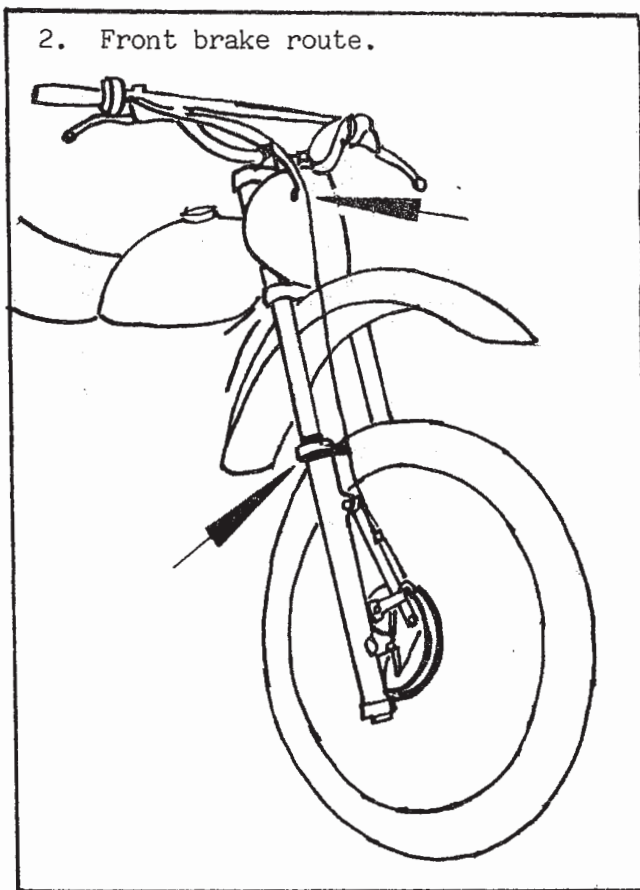

1. Top handlebar mountings (clamps) should be taped to prevent the front brake cable from catching on the clamps.
2. Route the front brake cable outside of the throttle cable, so that it will not rub the throttle cable while forks are compressed.
3. Ignition wire should be taped away from the exhaust (inside the frame surface) to eliminate cable damage from exhaust heat.

TD:SN
April 14, 1978
Technical Service Dept.



PAGE 3

MAICO SERVICE BULLETIN

NO: 7-78

RE: Crankshaft 250, 400, 450 MAGNUMS

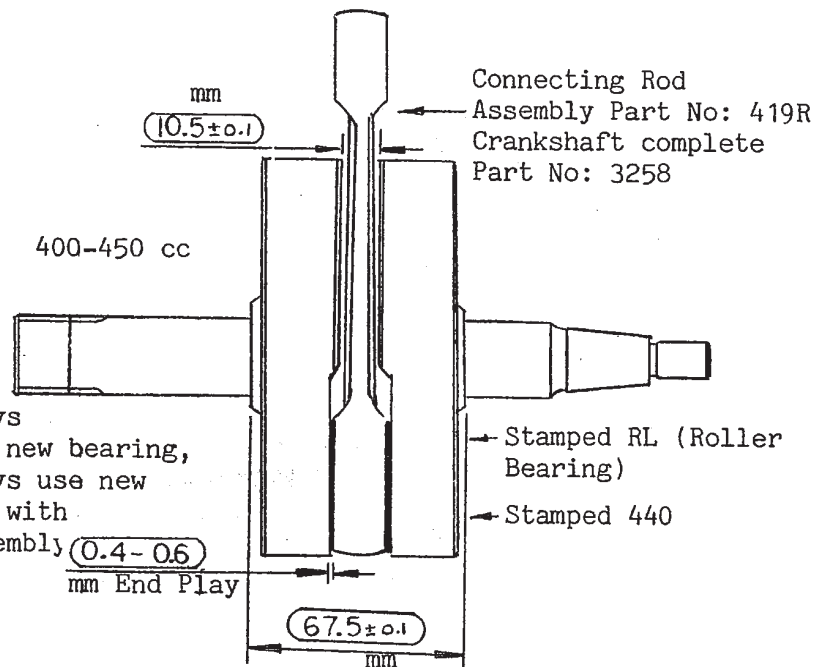
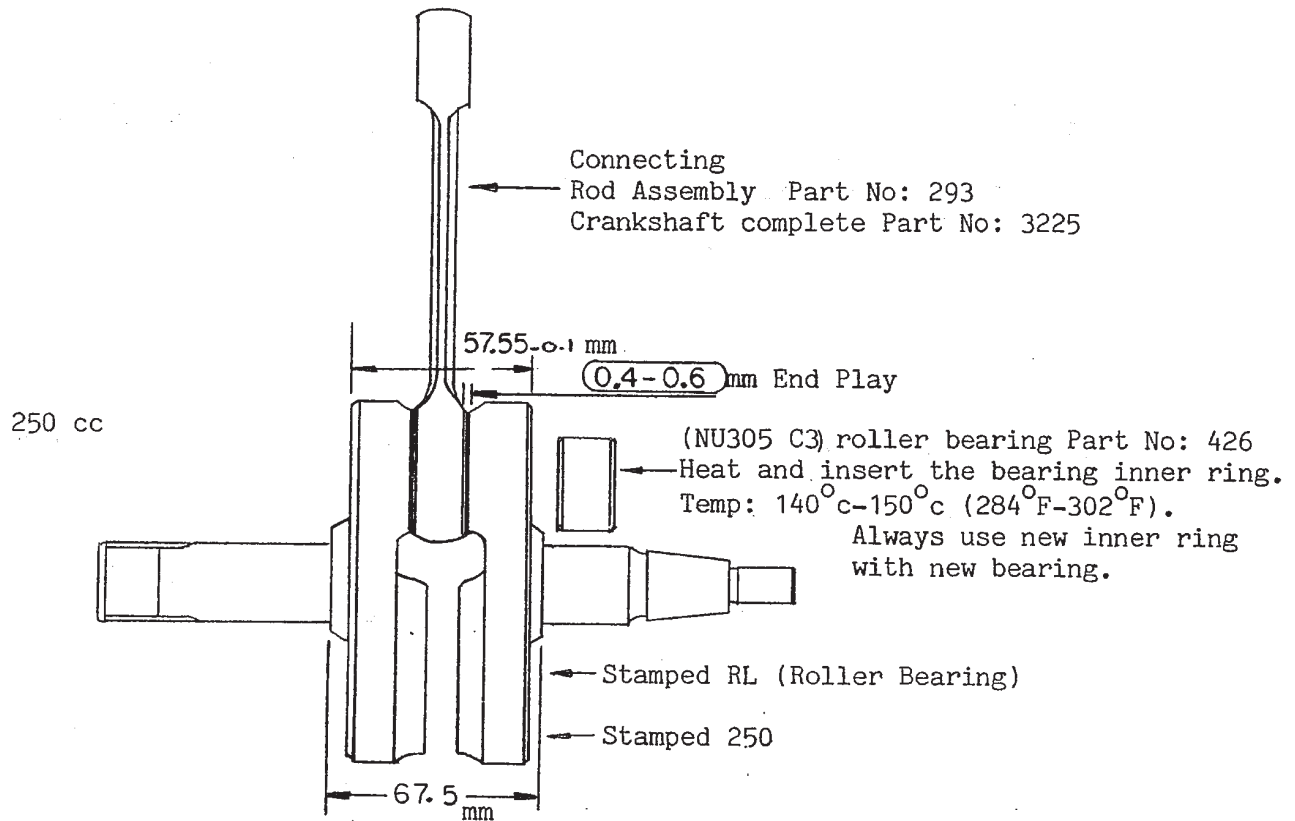

NOTE: Connecting rod is always replaced together with new bearing, spacers and pin. Always use new top end needle bearing with new connecting rod assembly and new piston pin.

TD:SN
April 14, 1978
Technical Service Dept.

MAICO SERVICE BULLETIN

No: 8/78

RE: Connecting Rod and Top End Bearing

We have been informed that some of the machines have been released with different tolerance needle bearings on the small end of the connecting rods. The connecting rods are marked 'x' on the top end bearing eye. (See sketch.) To replace the needle bearing with this connecting rod assembly, use the needle bearing with -4-6 tolerance.

Previous Needle Bearing: KBK 18x22x24 / 0-2 tolerance.

New Needle Bearing: KBK 18x22x24 / -4-6 tolerance.

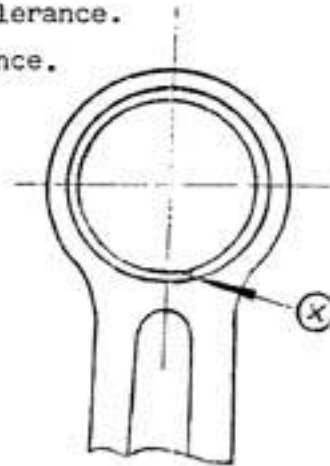

Part No. unchanged (Bearing No. 424)
When ordering the parts, give the number and the tolerance of the bearing.

Part No: 424 needle bearing with 0-2 tolerance.

Part No: 424 [ⓐ] needle bearing with -4-6 tolerance.

Beginning with the following engine numbers, the new needle bearing (-4-6) has been installed:

250 Magnum: *Still with previous needle bearing with 0-2 tolerance.

400 Magnum: 337-1185

450 Magnum: 338-0270

*Motor number will be informed later.

TD:SN
April 25, 1978
Technical Service Dept.



MAICO SERVICE BULLETIN

NO: 10/78
Page 1

RE: Clutch Housing and Clutch Guide:

The clutch housing and clutch guide have been changed on 250-400-450 Magnum engines in order to increase the durability of the clutch components and also for easy pulling of the clutch.

Needle bearings have been installed instead of the bushing for better response and less wear of the clutch. (Fig. 1.)

Beginning with the following engine numbers, the clutch housings have new needle bearing installed:

- 250 Magnum: 336-0336
- 400 Magnum: 337-0755
- 450 Magnum: 338-0112

NOTE: Do not hit with clutch lock washer tool to secure the clutch nut lock washer on the Magnum engines. Bend the lock washer carefully with the tool by applying the 2 way puller. (See Sketch - Fig. 2.)

NOTE: Do not install bearings on the previous clutch housing (with strengthening ring on the clutch housing). Serious damage to the bearing surface could result if bearings are used.

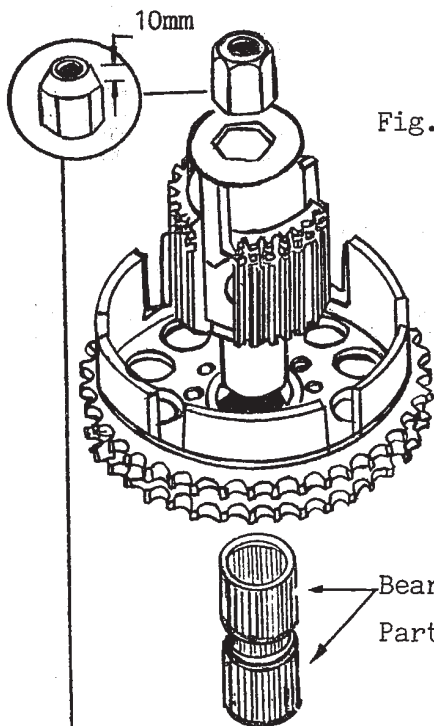

Fig. ①

Clutch housing without strengthening ring.

Clutch housing
Duplex 41T Part No: 2895
Triplex 39T Part No: 2944

Bearing 0-2 Tolerance
Part No: 736

Trick: Grind the clutch nut so that clutch spring can slide easily on the nut without damaging the springs.

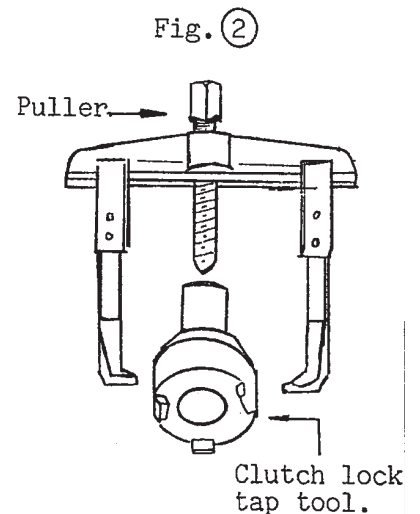

Fig. ②

Puller →

Clutch lock tap tool.

MAICO SERVICE BULLETIN

NO: 10/78
Page 2

RE: Clutch Guide with Needle Bearing:

Clutch body and push pin assembly have been changed. New clutch guide consists of new needle bearing, **push** pin, and *shimmed push pin cap.

The clutch guide with new needle bearing (Fig. 4) can be installed on the old clutches to achieve easy pulling of the clutch.

Beginning with the following engine numbers, new clutch guide with new needle bearing have been installed:

- 250 Magnum: 336-1054
- 400 Magnum: 337-0951
- 450 Magnum: 338-0208

NOTE: Do not use push pin cap on the push pin of the ball bearing clutch guides. This will cause serious damage to the balls on the clutch guide. (Fig.3)

Fig. ③

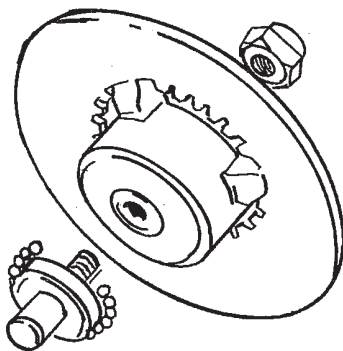

*As required

NEW

Fig. ④

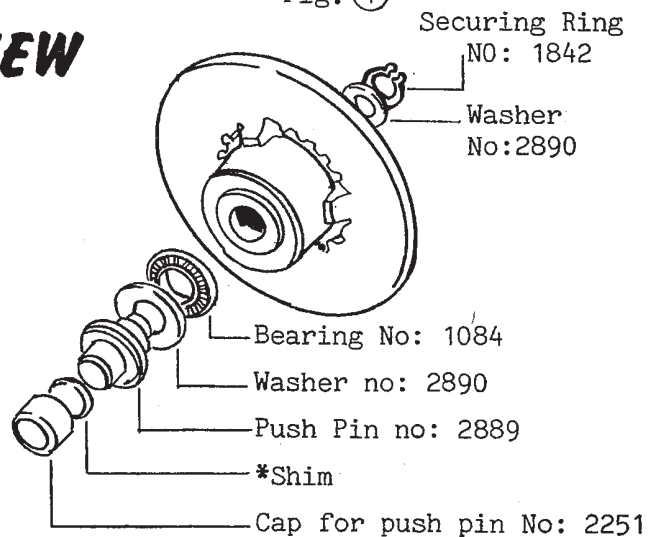

MAICO SERVICE BULLETIN

NO: 10/78
Page 3

RE: Clutch Housing - Crankshaft Sprocket - Clutch Guide Shimming:

Crankshaft Sprocket and Clutch Body:

Clutch housing should be parallel to (run out) crankshaft sprocket. Proper parallel run out of the sprocket increases the life and decreases wear of the primary chain.

Crankshaft sprocket or clutch body can be shimmed to obtain proper height and parallel run out.

NOTE: Clutch housing should have minimum 0.3mm axle play (end play). Check the crankshaft sprocket parallel run out at the clutch body middle position (middle position of the end play) and shim the crankshaft sprocket. (See Fig. 5.) The middle position is maximum $\pm 0.1\text{mm}$ tolerance.

Crankshaft sprocket shims:

- Part No: 862 Shim 0.2mm As required
- Part No: 3111 Shim 0.3mm

Clutch housing shims:

- Part No: 1884 Shim 0.2mm As required
- Part No: 3432 Shim 0.3mm

Clutch Guide Shimming:

The clutch guide with new needle bearing should be shimmed to avoid the clutch from dragging, slipping, and for an easy pulling. The measurements are measured from the crankcase gasket surface (without gasket) to the top of the push pin cap, which should be $64 \pm 0.2\text{mm}$. To obtain the proper height, install specified spacer under the push pin cap.

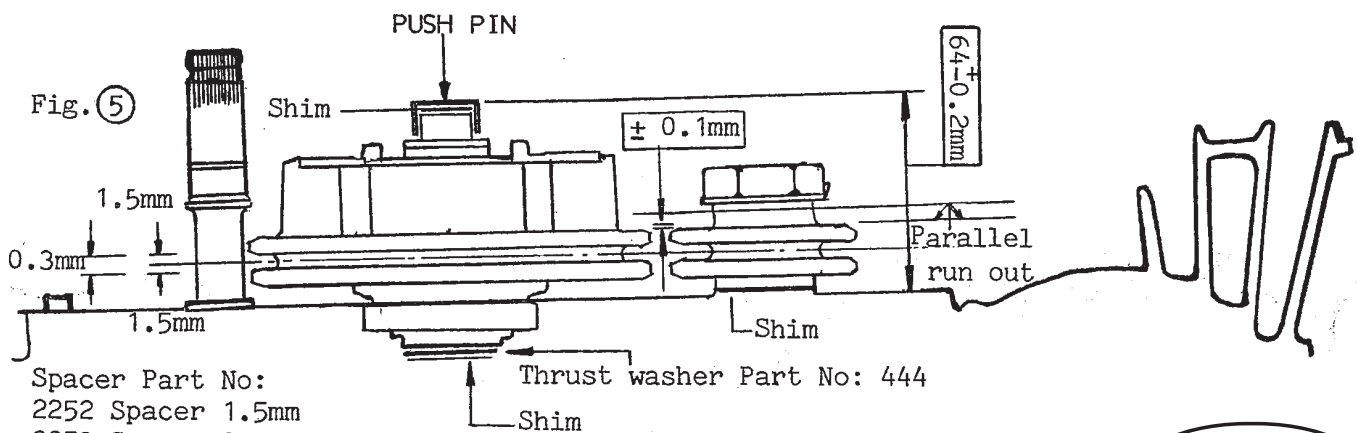

- Spacer Part No:
- 2252 Spacer 1.5mm
- 2253 Spacer 2.0mm
- 2254 Spacer 2.4mm
- 2255 Spacer 2.8mm
- 2256 Spacer 3.2mm
- 2257 Spacer 1.75mm

TD:SN
July 17, 1978
Technical Service Dept.
USA



MAICO SERVICE BULLETIN

NO: 11/78

RE: Clutch Housing and Crankshaft Sprocket Combination:

Part No: 3398
Clutch housing 41T

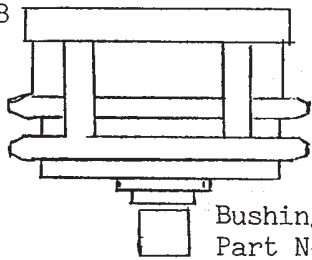

Duplex chain
52 links
Part No: 2899

Bushing
Part No: 3389

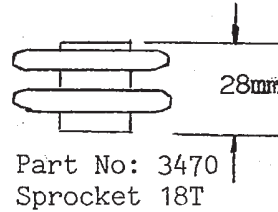

Part No: 3470
Sprocket 18T

Part No: 2895
Clutch housing 41T

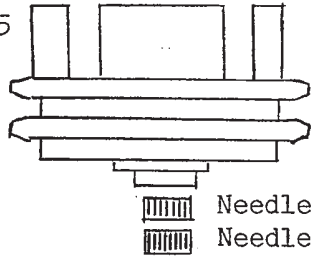

Duplex chain
52 links
Part No: 2899

Needle Bearing
Needle Bearing
Part No: 736

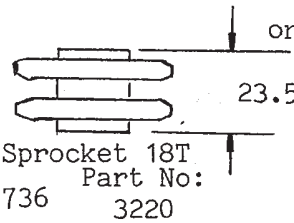

Sprocket 18T
Part No: 3220

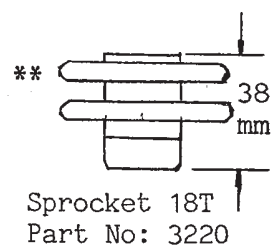

Sprocket 18T
Part No: 3220

Part No: 2577
Clutch housing 39T

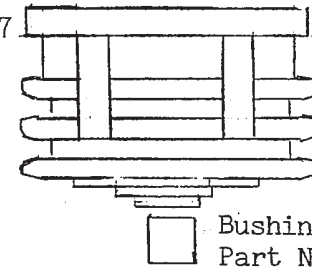

Triplex chain
52 links
Part No: 2947

Bushing
Part No: 3389

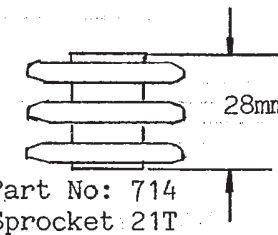

Part No: 714
Sprocket 21T

Part No: 2944
Clutch housing 39T

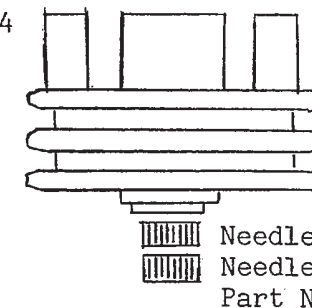

Triplex chain
52 links
Part No: 2947

Needle Bearing
Needle Bearing
Part No: 736

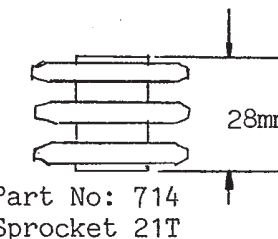

Part No: 714
Sprocket 21T

NOTE: ** The new crankshaft sprocket (same part no.) on the 250 Magnums are changed and eliminates the spacer ring (Part No: 713). (Shimming is not necessary.)
Use new crankshaft nut (Part No: 3240) and thin lock tap (Part No: 3254) on all the '78 Magnum engines.

TD:SN
July 17, 1978
Technical Service Dept.
USA



MAICO SERVICE BULLETIN No. 12/78

RE: MAGNUM II, MAGNUM E FOOTPEGS AND FOOTPEG SPRING INSTALLATION.

The footpeg spring has been modified to avoid the footpeg spring from jumping out of the frame loop.

The old type Fig (A) footpeg springs should be modified as shown in Fig(B)

(C) Drill 3ØMM hole on the left and right footpeg mounting tubes.

(D) The spring should be reduced in length also bend to hang in the hole.

Instructions For Installing The Footpegs:

- (1) Clean the paint from the footpeg bushing holes.
- (2) Install the footpeg bushing carefully (avoid hammering).
- (3) Lubricate footpeg stem and install the pegs.
- (4) Install the washer and self locking nut tighten carefully.
- (5) Hook the one end of the spring in the hole and insert a tube (Fig E) through the straight end of the spring pull over the serrated foot-peg loops.

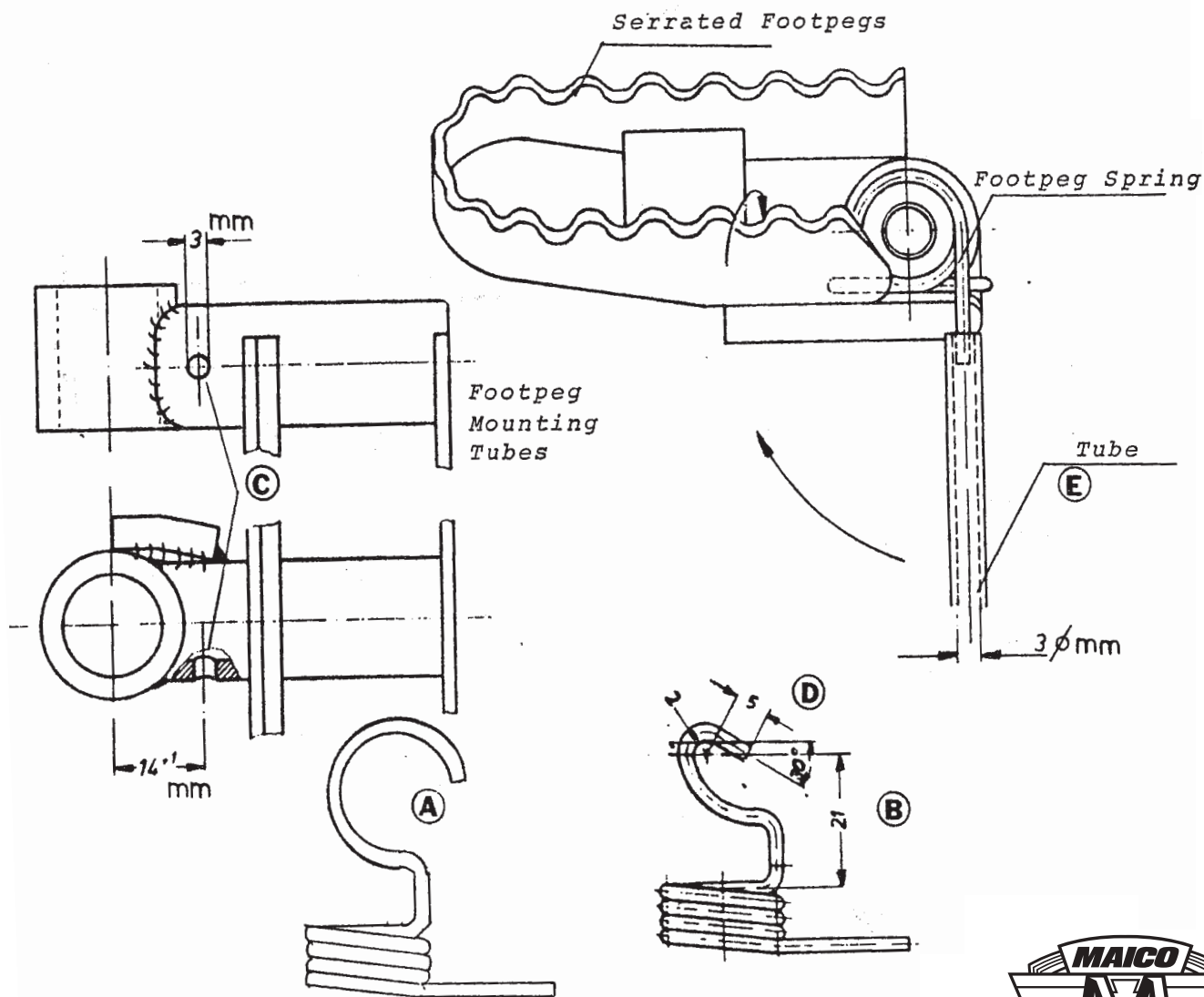

TD:SN Date: 11-1-78
 Technical Service Dept USA



MAICO SERVICE BULLETIN

PAGE 1

NO. 1/79

RE: CARBURETOR 450 MAGNUM II, 450 MAGNUM E

IN ORDER TO ACHIEVE A STRONG PULLING POWER AND MORE TORQUE, A BIGGER CARBURETOR HAS BEEN INSTALLED. REPLACING THE 36MM CARBURETOR TO 40MM CARBURETOR IMPROVES ALSO THE STARTING SPEED ON THE STRAIGHT AWAYS AND OVERALL POWER OUTPUT OF THE BIKE.

THERE ARE 4 DIFFERENT MANIFOLDS USED ON THE 450 CYLINDERS.

- A. RUBBER MOUNTED MANIFOLD.
- B. SOLID MOUNTED ALUMINUM MANIFOLD WITH 45MM OUTSIDE DIAMETER.
- C. SOLID MOUNTED ALUMINUM MANIFOLD WITH 47MM OUTSIDE DIAMETER.
- D. CASTED IN MANIFOLD.

(A) RUBBER MOUNTED MANIFOLD

RUBBER MOUNTED MANIFOLD EQUIPPED ONLY FOR 36MM CARBURETOR.

JETTING AS FOLLOWS:

PILOT JET	75-78
JET NEEDLE	360 #1
NEEDLE JET	326
MAIN JET	170-175
SLIDE	140-1
VAPORIZER	#4
AIR SCREW	1/2 TURN

(B) SOLID MOUNTED ALUMINUM MANIFOLD WITH 45MM OUTSIDE DIAMETER.

THIS CARBURETOR EQUIPPED FOR 36MM CARBURETOR ALSO. THIS TYPE OF MANIFOLD NOT INTERCHANGEABLE WITH FIG. (A) TYPE MANIFOLD CYLINDERS.

FOLLOWING JETTINGS ARE USED FOR THIS TYPE OF CYLINDERS.

PILOT JET	75
JET NEEDLE	801
NEEDLE JET	326
MAIN JET	160
NEEDLE POSITION:	LEANEST POSITION (TOP NOTCH)
SLIDE	140-1
VAPORIZER	#4
AIR SCREW	1 TURN

(C) SOLID MOUNTED ALUMINUM MANIFOLD WITH 47MM OUTSIDE DIAMETER.

THIS NEW MANIFOLD EQUIPPED FOR 40MM CARBURETOR. FIG.(B) 45MM MANIFOLD CAN BE REPLACEABLE TO 47MM MANIFOLD WITH 40MM CARBURETOR.



MAICO SERVICE BULLETIN NO. 2/79

RE: LAYSHAFT AND LAYSHAFT BEARINGS

A LONGER LAYSHAFT AND A NEW LAYSHAFT NEEDLE BEARING HAS BEEN INSTALLED ON THE MAGNUM MODELS. THE NOTICEABLE OPTICAL DIFFERENCE IS CLOSED LAYSHAFT BEARING HOLE ON THE RIGHT HAND CRANKCASE.

NEW BEARING OUTSIDE DIAMETER IS 240MM
 OLD BEARING OUTSIDE DIAMETER IS 220MM
 LAYSHAFT BEARING RIGHT HAND PART NO: 5598
 LAYSHAFT BEARING LEFT HAND PART NO: 5596

LAYSHAFT 17T MT1 PART NO: 5597
 LAYSHAFT 16T GT1 PART NO: 5696
 LAYSHAFTS ARE STAMPED MT1 FOR MOTOCROSS 250, 400, 440
 LAYSHAFTS ARE STAMPED GT1 FOR WIDE RATIOS (ENDURO'S) 250, 400, 440

MT, GT LAYSHAFTS ARE INTERCHANGEABLE WITH NEW CRANK CASES.
 MT1, GT1, LAYSHAFTS ARE NOT INTERCHANGEABLE WITH OLD CRANK CASES.

BEGINNING WITH FOLLOWING ENGINE NO: THE NEW LAYSHAFT HAS BEEN INSTALLED.

250 MAGNUM II: MT	WILL BE INFORMED LATER.	250 MAGNUM E:	WILL BE INFORMED LATER
400 MAGNUM II: RT	WILL BE INFORMED LATER.	400 MAGNUM E:	WILL BE INFORMED LATER
450 MAGNUM II: RT	338 1075	450 MAGNUM E:	GT238 0132

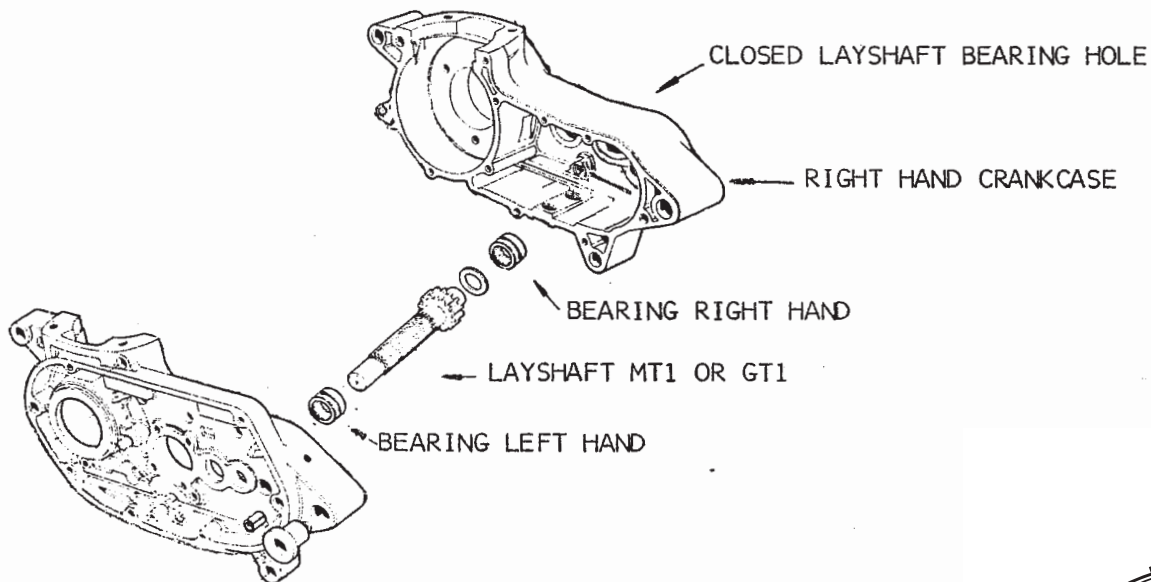

TD:SN
 MARCH 9, 1979
 TECHNICAL SERVICE DEPT. USA



MAICO SERVICE BULLETIN No. 3/79

RE: EXHAUST FLANGE

A MODIFIED EXHAUST FLANGE HAS BEEN INSTALLED ON THE 450 MAGNUM II MODELS. INSTEAD OF A HOOKED TENSION SPRING (PART NO. 5160), A LOADED SPRING WITH A BOLT AND BUSH COMBINATION HAS BEEN INSTALLED.

ALSO TO MATCH THE EXHAUST FLANGE, THE EXHAUST PIPE WITH A MOUNTING BUSH WELDED ON THE FRONT OF THE PIPE.

EXHAUST PIPES WITH NEW FLANGE MOUNTS ARE UNDER FOLLOWING PART NUMBERS.

MAGNUM II	250 EXHAUST PIPE	PART NO:	6272
	450 EXHAUST PIPE	PART NO:	6277
	EXHAUST FLANGE		5708

NOTE:

IF A NEW EXHAUST FLANGE MOUNTED ON A OLD CYLINDER, CUT OR GRIND A PART OF THE TOP COOLING FIN TO INSTALL THE EXHAUST FLANGE.

BEGINNING WITH THE FOLLOWING ENGINE NO. THE NEW EXHAUST FLANGE HAS BEEN INSTALLED.

250 MAGNUM II :	MT336 3192	250 MAGNUM E :	GT236 0528
400 MAGNUM II :	RT337 2675	400 MAGNUM E :	GT237 0375
450 MAGNUM II :	RT338 1117	450 MAGNUM E :	GT238 0132

NEW

WASHER PART NO: 1750

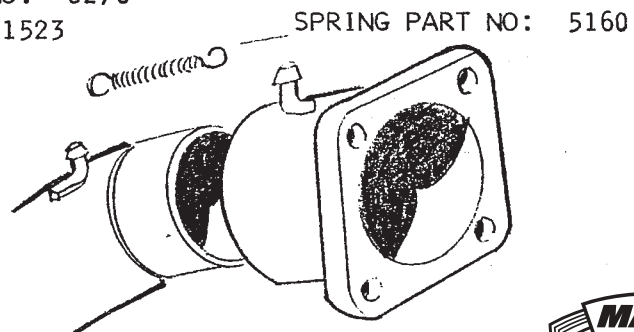
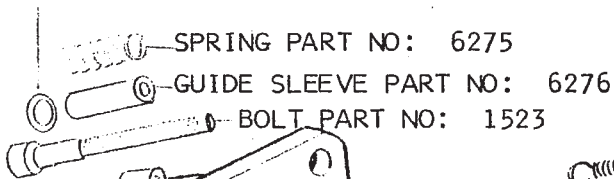

TD:SN
 MARCH 9, 1979
 TECHNICAL SERVICE DEPT. USA



MAICO SERVICE BULLETIN

BEFORE

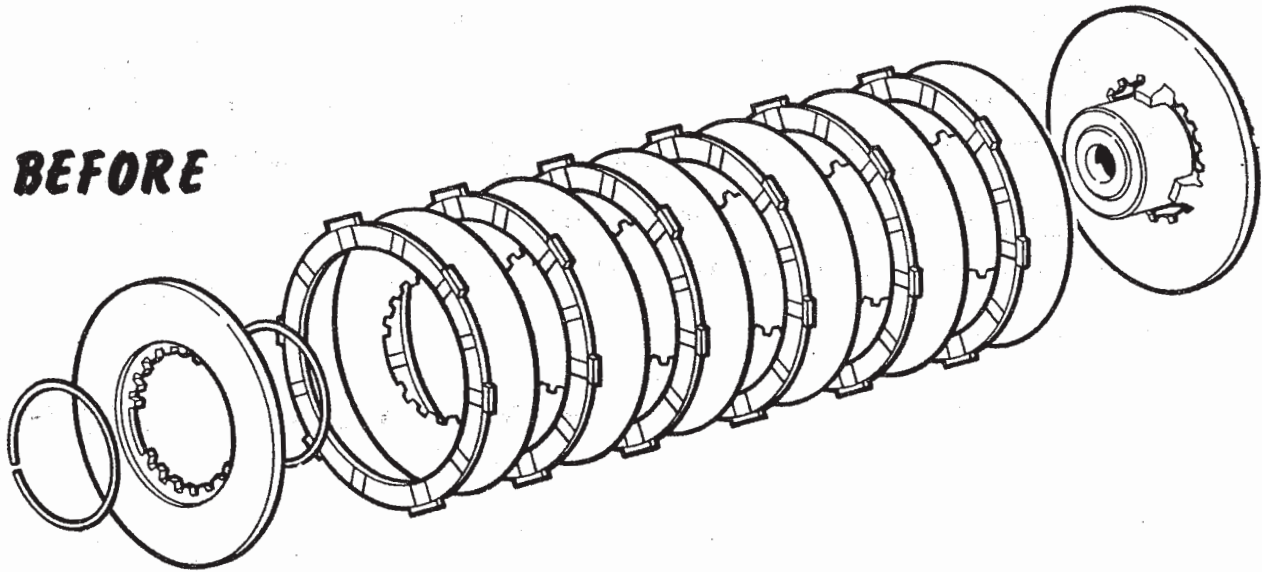

NOTE: USE 20 SPRING ON THE PREVIOUS CLUTCH

STRENGTHENED CLUTCH GUIDE PART NO: 5718

**NOW
NEW**

STRENGTHENED PRESSURE PLATE
PART NO: 5721

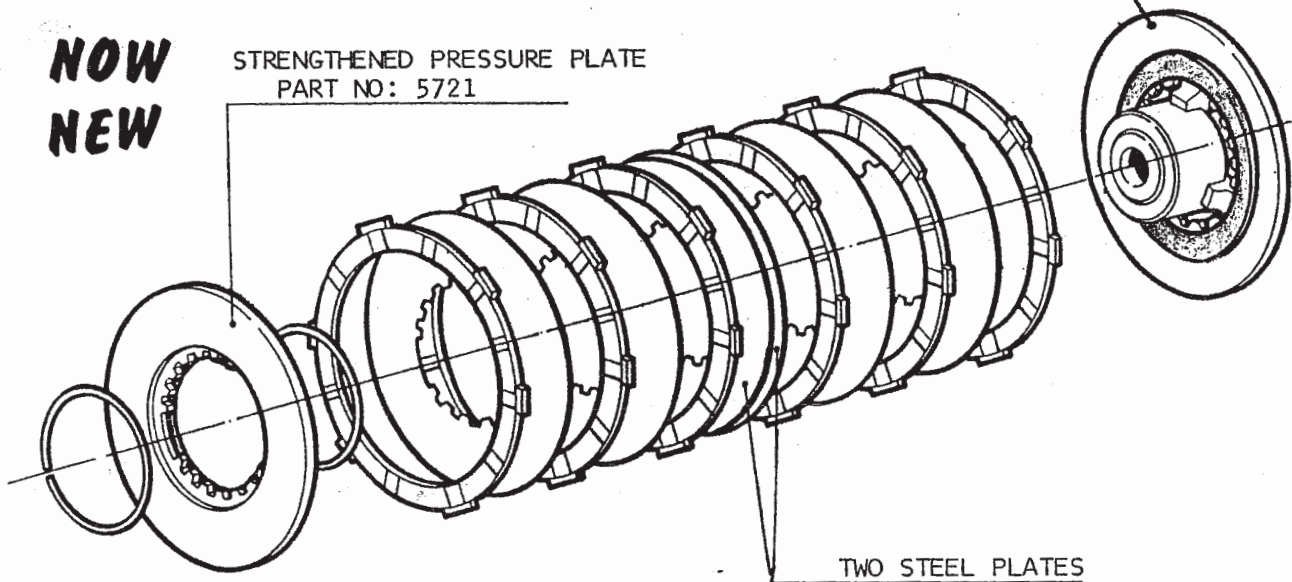

TWO STEEL PLATES

NOTE:
USE ONLY 18 CLUTCH SPRINGS ON THE NEW CLUTCH.

TD:SN
MARCH 9, 1979
TECHNICAL SERVICE DEPT. USA

MAICO SERVICE BULLETIN

PAGE 1
NO. 4/79

RE: STRONG AND EASY PULLING CLUTCH ON THE 450 MAGNUM II

NEW TYPE OF CLUTCH HAS BEEN INSTALLED TO ACHIEVE EASY PULLING AND TO CARRY MORE LOAD. THIS TYPE OF CLUTCH CAN BE IDENTIFIED BY AN ADDITIONAL STRENGTHENING RING ON THE CLUTCH GUIDE AND THE PRESSURE PLATE WHICH IS ALSO MACHINED TO MATCH THE INSIDE DIAMETER OF THE SINTAL METAL CLUTCH PLATES.

THIS RING IS SPOT WELDED ON THE PRESSURE PLATE AND THE CLUTCH GUIDE. ONE PIECE CLUTCH GUIDE AND PRESSURE PLATE WILL BE INSTALLED ON THE FUTURE MODELS INSTEAD OF SPOT WELDED RING.

NOTE THE FOLLOWING:

1. THERE ARE ONLY 18 CLUTCH SPRINGS INSTALLED INSTEAD OF 20 CLUTCH SPRINGS.
2. BEFORE:

THE FIRST STEEL PLATE WAS INSTALLED ON THE CLUTCH GUIDE.

NOW :

THE FIRST STEEL PLATE IS REMOVED FROM THE TOP, OF THE CLUTCH GUIDE AND INSTALLED IN THE MIDDLE OF THE CLUTCH PACK. (SEE THE PICTURE). THIS IS VERY IMPORTANT OTHERWISE CLUTCH COVER WILL HIT THE PRESSURE PLATE.

NOTE:

THIS TYPE OF CLUTCH IS ALSO RECOMMENDED FOR ALL THE 5 SPEED TRANSMISSIONS WITH SINTAL METAL CLUTCH PLATES.

NOTE:

ALSO IT IS VERY IMPROTANT TO CHECK THE CLUTCH GUIDE SHIMMING. FOR MORE INFORMATION SEE SERVICE BULLETIN NO. 10/78, PAGE 3 UNDER CLUTCH GUIDE SHIMMING.

BEGINNING WITH THE FOLLOWING ENGINE NO. THE NEW CLUTCH HAS BEEN INSTALLED.

450 MAGNUM II : RT 338 1421



MAICO SERVICE BULLETIN NO. 5/79

RE: KICKSTARTER RATCHET CUP AND LOCKRING ON THE CLUTCH HOUSING

THE KICKSTARTER RATCHET LOCK RING PART NO. 733 HAS BEEN CHANGED TO PART NO. 5593 WITH A NEW SPRING CUP PART NO. 5592.

NEW CLUTCH HOUSING PART NO. AS FOLLOWS:

MC 250 MAGNUM II CLUTCH HOUSING PART NO: 5590 (41T)

MC 400/450 MAGNUM II CLUTCH HOUSINGS PART NO: 5594 (39T)

THE NEW CLUTCH HOUSING CAN BE IDENTIFIED BY THE GROOVE DEPTH OF 1.2 MM. THE PREVIOUS CLUTCH HOUSING DEPTH WAS 2.2MM. (SEE THE SKETCH)

ALWAYS USE NEW SPRING CUP AND NEW LOCK RING ON THE NEW CLUTCH HOUSING. THE PREVIOUS CLUTCH HOUSING USE NEW LOCK RING WITH OLD SPRING CUP. THE NEW SPRING CUP IS NOT INTERCHANGABLE WITH OLD CLUTCH HOUSING.

BEGINNING WITH THE FOLLOWING ENGINE NO. THE NEW CLUTCH HOUSING HAS BEEN INSTALLED.

250 MAGNUM II	MT336 3192	250 MAGNUM E	GT236 0528
400 MAGNUM II	RT337 2675	400 MAGNUM E	GT237 0375
450 MAGNUM II	RT338 1131	450 MAGNUM E	GT238 0132

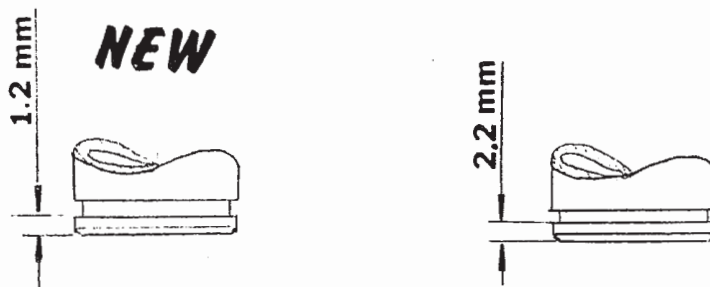

TD:SN
 MARCH 9, 1979
 TECHNICAL SERVICE DEPT. USA



MAICO SERVICE BULLETIN

No. 6/79

Page 1

RE: 1979 MAGNUM II, MAGNUM E JETTING CHART

	250CC Ø36mm Carb	400CC Ø36mm Carb	400CC Ø40mm Carb	450CC Ø36mm Carb	450CC Ø40mm Carb
Main Jet	*175 - 170	*175 - 170	*195 - 190	*175 - 170	195 -*190
Needle Jet	326 -*324	*326 - 324	282.2 - *280.2	*326 - 324	282.2 - *280.2
Pilot Jet	78 - *75	*78 - 75	45	*78 - 75	*45
Jet Needle	#1	#1	8G2	#1	8G2
Slide	140 - 1	140 -1	120 -1	140 - 1	120 - 1
Vaporizer	#4	#4	#3	#4	#3
Air Screw	1/2-3/4	1/2-3/4	1/2-3/4	1/2-3/4	1/2-3/4
Turn					

* RECOMMENDED JETTING

CARBURETOR ADJUSTMENT

The best performance and engine output depends on fine adjustment of the carburetor for various working conditions such as altitude and temperature. Improper adjustment of the carburetor causes the engine to perform below its actual output.

Pilot Jet: Functions up to approximately 25% slide opening.
Fine adjustment through air regulating screw (small screw).

Needle Jet: Functions at midrange, 15% to 80% slide opening.
Fine adjustment through jet needle (3 positions).

Main Jet: Functions between 50% and 100% slide opening.

Adjustment of the Carburetor:

All adjustments should be made only on a warmed up engine. Always change one component only, then test ride again. The basic carburetor jetting is valid for 1200 feet above sea level and temperatures between 18° c - 25° c (64° - 77°F).

Pilot System:

-Functions when throttle slide is closed. The throttle slide stop screw (idling screw) adjusts idling rpm-approximately 1000 rpm. Clean idling is regulated with air regulating screw (small screw). Turning the screw further in gives a richer idling mixture: turning the screw further out gives a leaner idling mixture. When bike is in motion with throttle slide closed and engine idles too fast (lean mixture), use the next larger pilot jet.

EXAMPLE:

	36mm Carb	40mm Carb
Leaner Pilot Jets	72 - 70	40 - 35
Richer Pilot Jets	80 - 82	50 - 55

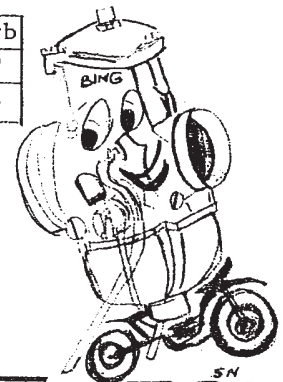
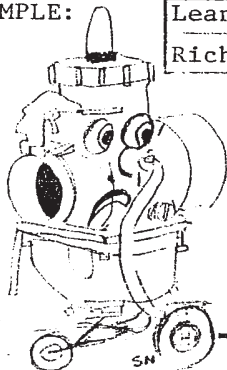

MAICO SERVICE BULLETIN

No 7/79

Re: Hooked Ratchet on Magnum Engines.

A new hooked ratchet (Part No 2510) and a new cover plate (Part No 2508) Sketch 4 has been installed after following engine No's:

250	Magnum II	Mt	336	4076	250	Magnum E	GT	236	0781
400	Magnum II	Rt	337	3029	400	Magnum E	GT	237	0496
450	Magnum II	RT	338	2380	450	Magnum E	GT	238	0398

In order to replace the new hooked ratchet and the cover plate on the previous Magnum Engines, a small modification should be made on the left hand crankcase. (see Sketch 1).

Left hand side crankcase

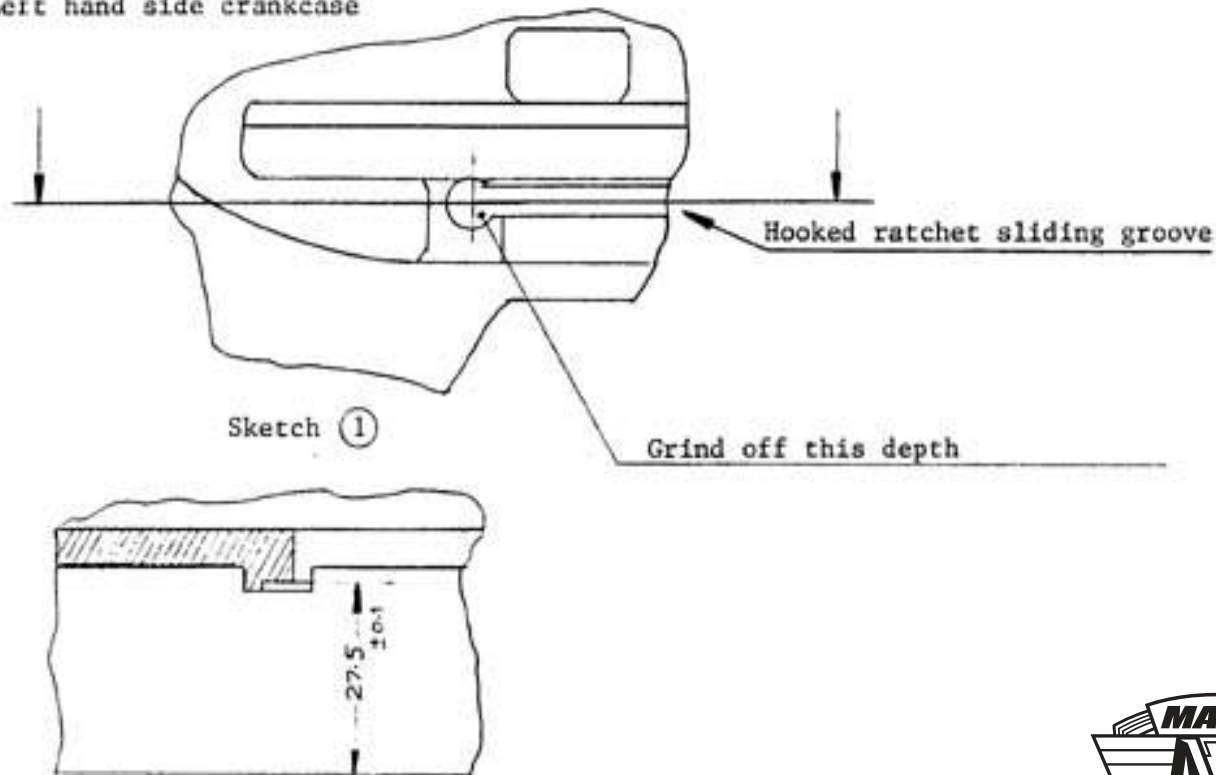

MAICO SERVICE BULLETIN

If Grinding the crankcase is not possible Grind off the hooked ratchet nose (see Sketch 2), so that hooked ratchet can move freely without jamming on the left hand crankcase

Do not over grind the hooked ratchet stop surface. It's very important to give enough radius (Sketch 3) so that hooked ratchet releases from the shifting cam after it completes the engagement.

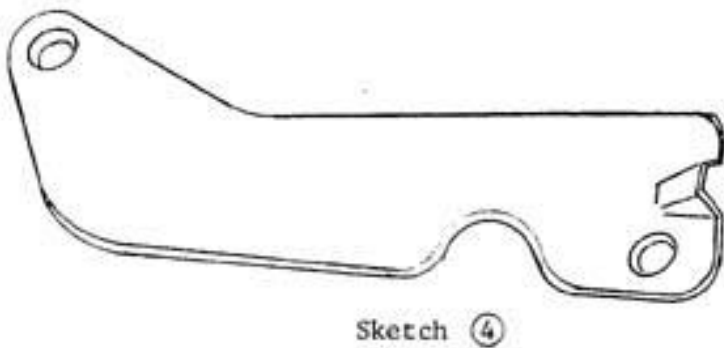
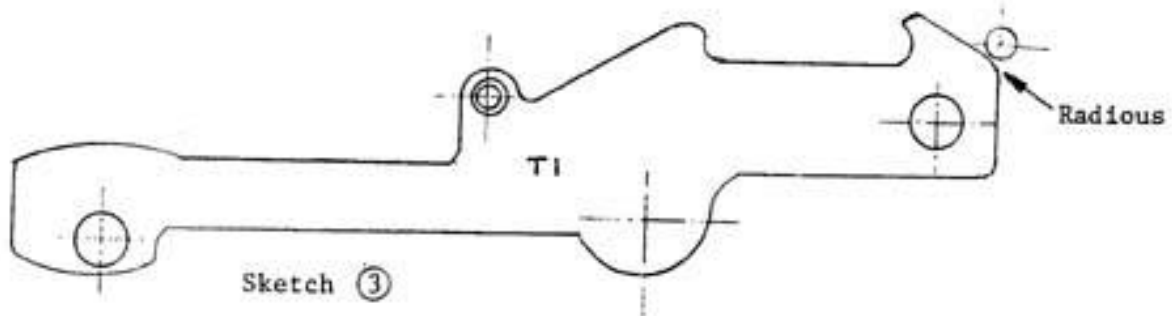
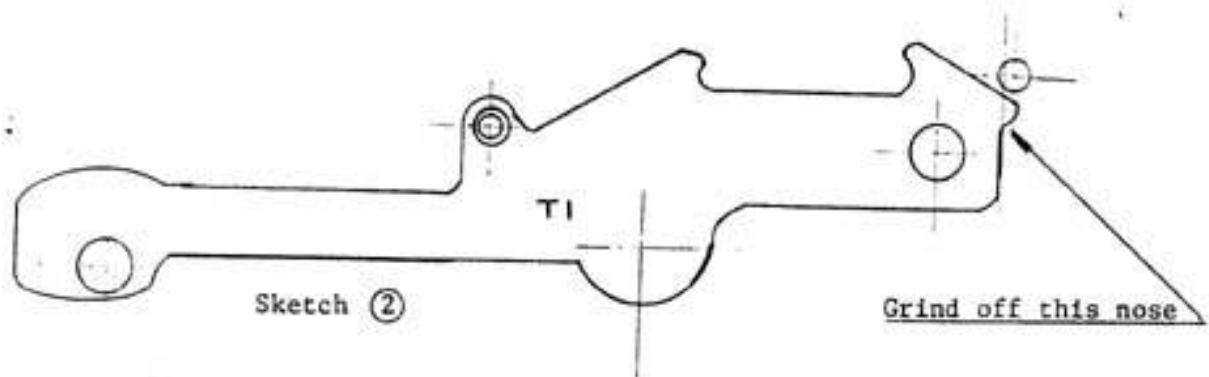

TD:SN
 September 19, 1979
 Technical Service Department



MAICO SERVICE BULLETIN

No. 6/79

Page 3

Ignition Timing:	250 Magnum II	400 Magnum II	450 Magnum II
	1.5 - 1.7mm BTDC	2.2 - 2.5mm BTDC	2.2 - 2.5mm BTDC

Spark Plug Chart:		Champion		
Single Seal Plugs	Double Seal Plugs	Test-Reserch Special Plugs	Stock Plugs	Bosch Plugs
N4G	-	-	-	-
N3G	NG 535	-	-	260
N2G	NG 534	N86G	N86G	280
N59G	NG 532	N84G	N84G	310
N57G	NG 531	N82G	N82G	340
N55G	NG 533	N80G	N80G	370

Hot

↑

↓

Cold

Racing on the hard deep sand, mud, cold weather conditions always use bigger jettings - Also use colder plugs if necessary.

TD:SN
5-29-79
Technical Service Department





MAICO CLUTCH SPRING INSTALLATION

You will need: All the usual tools to work on your Maico, possibly a new clutch cover gasket and a large finger-style puller big enough to compress the clutch basket so you can remove the retaining clip(s). This is also a good time to replace the primary drive chain since you'll have everything apart.

We hope you have a Maico service manual, but if not, we offer them for all models. To buy a copy, call us at 513-482-9620 or email at bearsports@gmail.com or via our web site www.bear-sports.com.

1. You can either have your bike on a stand after draining the oil or lying on its right side if you're too lazy to drain the oil.
2. Remove the clutch cover.
3. Using a large finger-style puller, compress the clutch basket until you can pry out the large round retaining clip. Note that your clutch may have **TWO** of these clips. Be sure to check and remove all of them because if you don't, you'll end warping the pressure plate.
4. Remove the clutch basket assembly.
5. Pull out the beveled washers and store them in a baggie (never throw away vintage bike parts, no matter how worthless they may seem).
6. Behind the beveled washers is a locking tab washer that sits on the hub nut. Remove this locking tab or the new spring will bind.
7. Put a dab of blue Loctite on the hub nut after removing the locking tab.
8. Pop the spring in. Either end is okay.
9. Reinstall the clutch pack and retaining clip and button it up.
10. Add oil, adjust clutch feel and play (the clutch will be much easier to pull), lube your clutch cable and make sure your clutch lever is in good shape and not binding or rattling around.

Notes: These are Maicos and you will find anywhere from 15 to 19 beveled washers inside as every Maico tuner seems to have his own secret combo. You will find either one or two clips holding the clutch pack in place.

If you don't have the tools or the experience, think hard about having someone else do the installation. If you live anywhere near Florida, we highly recommend Woody's Vintage GP at 407-416-2021 to install these springs as he's done it many times before. Have Woody do the brakes on your Maico too, so it stops as well as it goes.

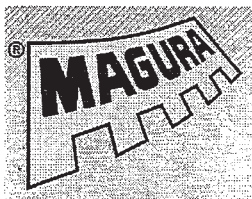

Thanks for your purchase. We stock and sell a wide variety of new motocross gear and parts as well as one of the widest selections of vintage bike supplies available. We are Magura's largest USA dealer and also have a full range of Uni filters for vintage bikes, Rental vintage handlebars and much more.

Visit our web site at www.bear-sports.com or give us a call at 513-482-9620.